



RICHARD
POYNTZ
01288 899599

R226 Kings Park



R226 Kings Park Canvey Island Essex SS8 8QD

£120,000



Located within the ever-popular Kings Park Village, this attractive park home is offered for sale with NO ONWARD CHAIN and is available exclusively to residents aged 50 years and over.

The development itself offers excellent on-site facilities including gated security, a convenient shop, fishing lake, superb restaurant and bar, together with a modern indoor swimming pool — everything on your doorstep, which is how park living should be.

Internally, the property offers well-planned accommodation comprising an entrance hall leading to a modern fitted kitchen/breakfast room, complete with hob, oven and space for a small table and chairs. The lounge sits to one side, providing a comfortable reception space. There is a good-sized double bedroom, a second smaller bedroom ideal for guests or hobbies, and a modern three-piece shower room completing the accommodation.



Hall

12'3 x 3'9 (3.73m x 1.14m)

UPVC double-glazed entrance door into a spacious hallway with coving to the ceiling, electric radiator, from the hallway we have access to two bedrooms, bathroom and opening into the kitchen.

Lounge

11'7 x 11' (3.53m x 3.35m)

Double-glazed windows to both sides, double-glazed bay window to the front elevation, double-glazed entrance door into the lounge, coving to the ceiling, mock feature fireplace and door housing a storage cupboard, wall-mounted electric radiator, large opening through into the kitchen area.

Kitchen Area

11'7 x 9'2 (3.53m x 2.79m)

Double-glazed windows to both sides, storage cupboard, space if need for a small dining room table, coving to the ceiling, white units and drawers at base level with work surfaces to three walls, an inset ceramic hob with oven under, plumbing facilities for a washing machine, an inset stainless steel one-and-a-quarter drainer sink with mixer taps, matching units at eye level with two glass display cabinets.



Bedroom One

11'4 into the wardrobes x 8' (3.45m into the wardrobes x 2.44m)

Double-glazed window to the side elevation, wall-mounted electric radiator, wallpaper decor, coving to the ceiling, and storage cupboards built in.



Bedroom Two

8'5 x 7'10 (2.57m x 2.39m)

Double-glazed window to the side elevation, electric wall-mounted radiator, storage cupboards which are fitted, and coving to the ceiling.



Shower Room

Obscure double-glazed window to the side elevation, fully tiled to the walls in ceramics, shower cubicle with glass enclosures and wall-mounted electric shower (not tested), low-level wc, vanity unit with inset wash hand basin, wall-mounted blow heater.

Exterior

A small patio area and steps connecting to the front door plus steps connecting to the lounge door, brick built store.

GROUND FLOOR

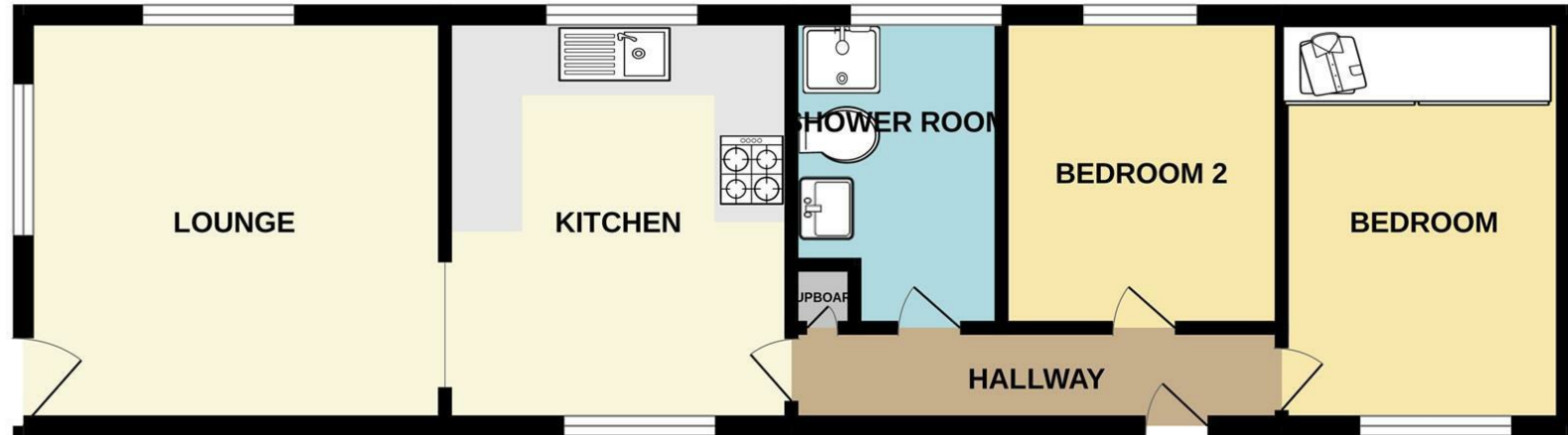

Whilst every attempt has been made to ensure the accuracy of the floorplan contained here, measurements of doors, windows, rooms and any other items are approximate and no responsibility is taken for any error, omission or mis-statement. This plan is for illustrative purposes only and should be used as such by any prospective purchaser. The services, systems and appliances shown have not been tested and no guarantee as to their operability or efficiency can be given.
Made with Metropix ©2026

Mirepresentation Act 1967: These details are prepared as a general guide only, and should not be relied upon as a basis to enter a legal contract or commit expenditure. And any interested party should rely solely on their own Surveyor, Solicitor/Conveyancer or other professionals before committing themselves to any expenditure or other legal commitments. If any interested party wishes to rely upon any information from the Agent, then a request should be made and specific written confirmation can be provided. The Agent will not be responsible for any verbal statement made by the Agent or any member of Staff, as only a specific written confirmation can be provided. The Agent will not be responsible for any loss other than what specific written confirmation has been requested.

Property Misdescription Act 1991 The Agent has not tested any apparatus, equipment, fixture, fittings or services and so does not verify they are in working order, fit for purpose, or within ownership of the sellers, therefore the buyer must assume the information is incorrect. Neither has the Agent checked the legal documentation to verify legal status of the property. A buyer must assume the information is incorrect until it has been verified by their own Solicitors/Conveyancers. Nothing concerning the type of construction or the condition of the structure is to be implied from the photograph or plans for the property. Photographs of the interior of the property are given purely to give an indication of décor/style etc. and does not imply that any furniture/fittings etc., are included. A fixtures & fittings list will be provided by the Solicitors/Conveyancers in due course. The sales particulars may change in the course of time and any interested party is advised to make a final inspection of the property prior to exchange of contracts



Tel No: 01268 699 599 | Fax: 01268 699 080 | Email: rp@richardpoyntz.com
Registered Office: Richard Poyntz & Company, 11 Knightswick Road, Canvey Island SS8 9PA

Partners: Richard P. Poyntz F.N.A.E.A., James R. Poyntz M.N.A.E.A., Anna L. Poyntz & Sara Poyntz • V.A.T No: 731 4287 45
Richard Poyntz & Co (Partnership) is an introducer appointed representative of Stonebridge Mortgage Solutions Ltd for mortgage and insurance introductions.
Stonebridge Mortgage Solutions Ltd is authorised and regulated by the Financial Conduct Authority.

