



OVER 60?
Secure this property
for up to **59% less!**

Guide Price
£240,000
Freehold

3x  1x  1x 

School Green Road, Freshwater, Isle of
Wight, PO40

Pittis 
Helping you move forwards



Main features

- The iconic Ginger Jar - a quirky lifestyle & full of love
- Pre-war unique wooden frame bungalow with off road parking & gardens
- Versatile design & layout
- Upgraded kitchen & decor throughout & upgraded electrics
- Close to village & local transport

Accommodation

GROUND FLOOR

Hallway

Lounge: 16'2 x 14'8 (4.93m x 4.47m)

Kitchen: 18'5 x 7'3 (5.62m x 2.21m)

Dining Room: 20'3 x 12'4 (6.18m x 3.76m)

Bedroom 1: 13'7 x 13'1 (4.14m x 3.99m)

Bedroom 2: 12'0 x 11'9 (3.66m x 3.58m)

Bedroom 3: 12'0 x 9'2 (3.66m x 2.80m)

Shower Room: 10'8 x 5'9 (3.25m x 1.75m)

Conservatory: 13'7 x 4'2 (4.14m x 1.27m)

OUTSIDE

Driveway

Rear Garden

Ground Floor

Approx. 119.0 sq. metres (1281.4 sq. feet)

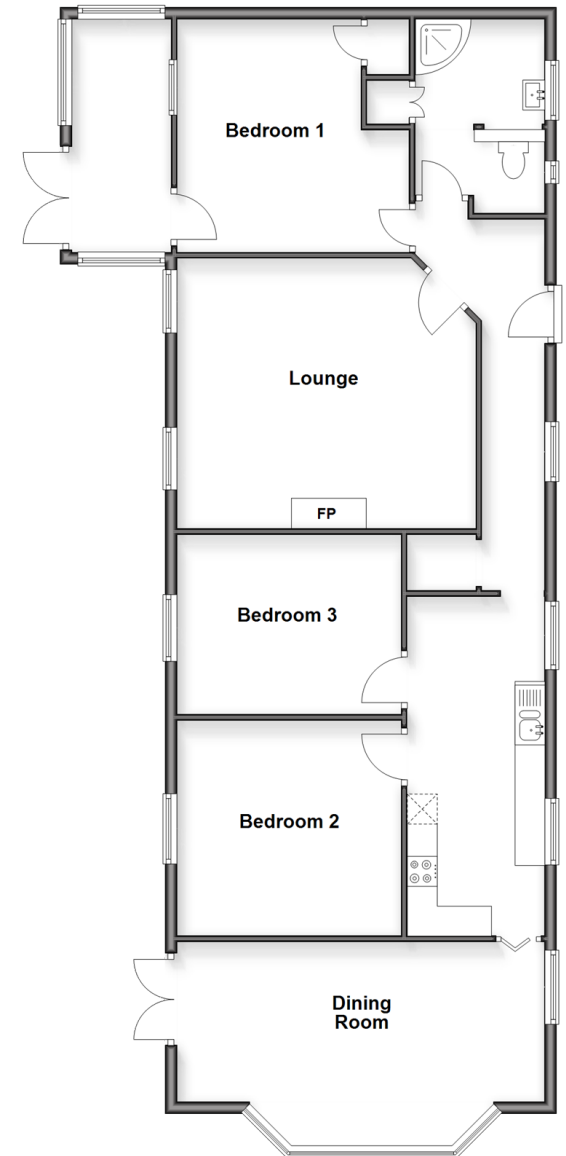

Call Freshwater - 01983 756222 ■ pittis.co.uk

- The seller is a person connected with Pittis as defined in the Estate Agents Act 1979
- Legal advice should be taken to verify fixtures/fittings, planning, alterations and/or lease details
- Appliances & services are untested, dimensions are approximate and floor plans are not to scale
- Through a Homewise Home For Life Plan people aged 60+ can secure this property for up to 50% less, by purchasing a Lifetime Lease.



60218629/20251101/REP/CG