



2 Bed  
House - Semi-  
Detached  
located in

£950 Per month



**SMART STREET**  
THE PROPERTY PEOPLE

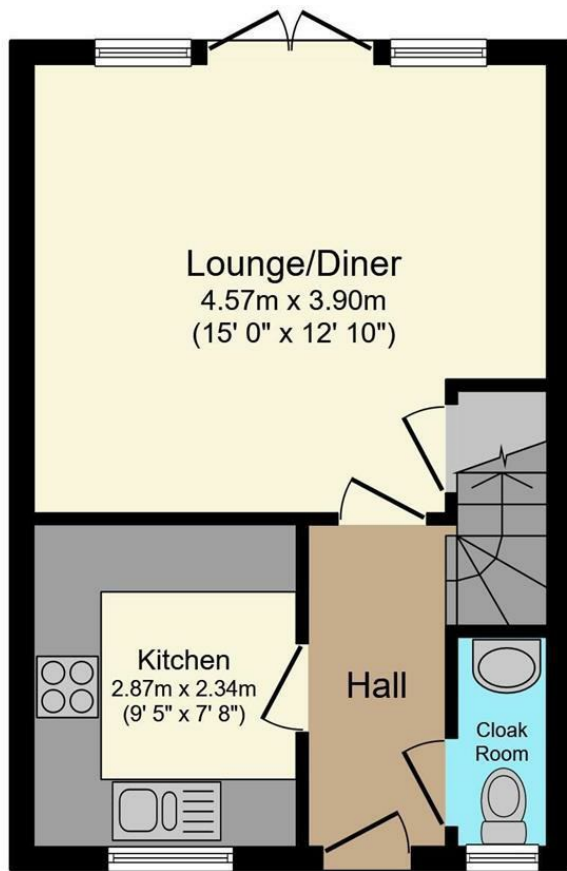

**Ground Floor**

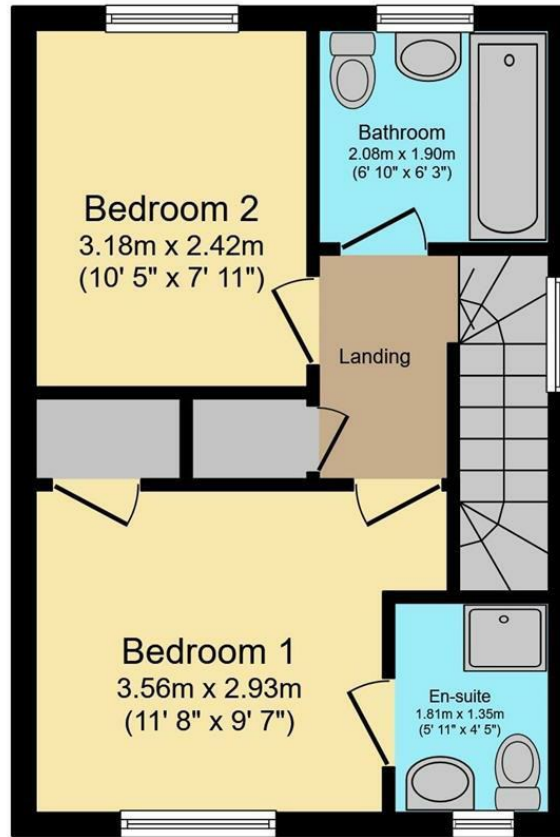

**First Floor**

Total floor area 63.7 sq.m. (686 sq.ft.) approx

This floor plan is for illustrative purposes only. It is not drawn to scale. Any measurements, floor areas (including any total floor area), openings and orientation are approximate. No details are guaranteed, they cannot be relied upon for any purpose and they do not form part of any agreement. No liability is taken for any error, omission or misstatement. A party must rely upon its own inspection(s). Plan produced for Purple Bricks. Powered by www.focalagent.com

Energy Efficiency Rating		
	Current	Potential
Very energy efficient - lower running costs		
(92 plus) <b>A</b>		
(81-91) <b>B</b>		
(69-80) <b>C</b>		
(55-68) <b>D</b>		
(39-54) <b>E</b>		
(21-38) <b>F</b>		
(1-20) <b>G</b>		
Not energy efficient - higher running costs		
EU Directive 2002/91/EC		
England & Wales		

**DIRECTIONS**

**CONTACT**

14 Withambrook Park  
Grantham  
NG31 9ST

E: [info@smartstreetproperty.com](mailto:info@smartstreetproperty.com)  
T: 01476 247107



**SMART STREET**  
THE PROPERTY PEOPLE