



Fairlea Place, W5

£445,000

An immaculate two-bedroom split-level maisonette with stunning far-reaching views, set within a popular residential development. Benefits include a share of the freehold with lease of 955 years and low service charges. Offering both a superb home and a smart long-term investment.

Ideally positioned between Ealing Broadway and the highly sought-after Pitshanger Lane, in a prime residential setting. Close to a number of excellent local schools including St Gregory's Primary, Montpelier Primary and North Ealing Primary.

Features

- Two Bedrooms
- Maisonette
- Split Level
- Fantastic Condition
- Quiet Residential Location
- Share Of Freehold

Fairlea Place, London, W5

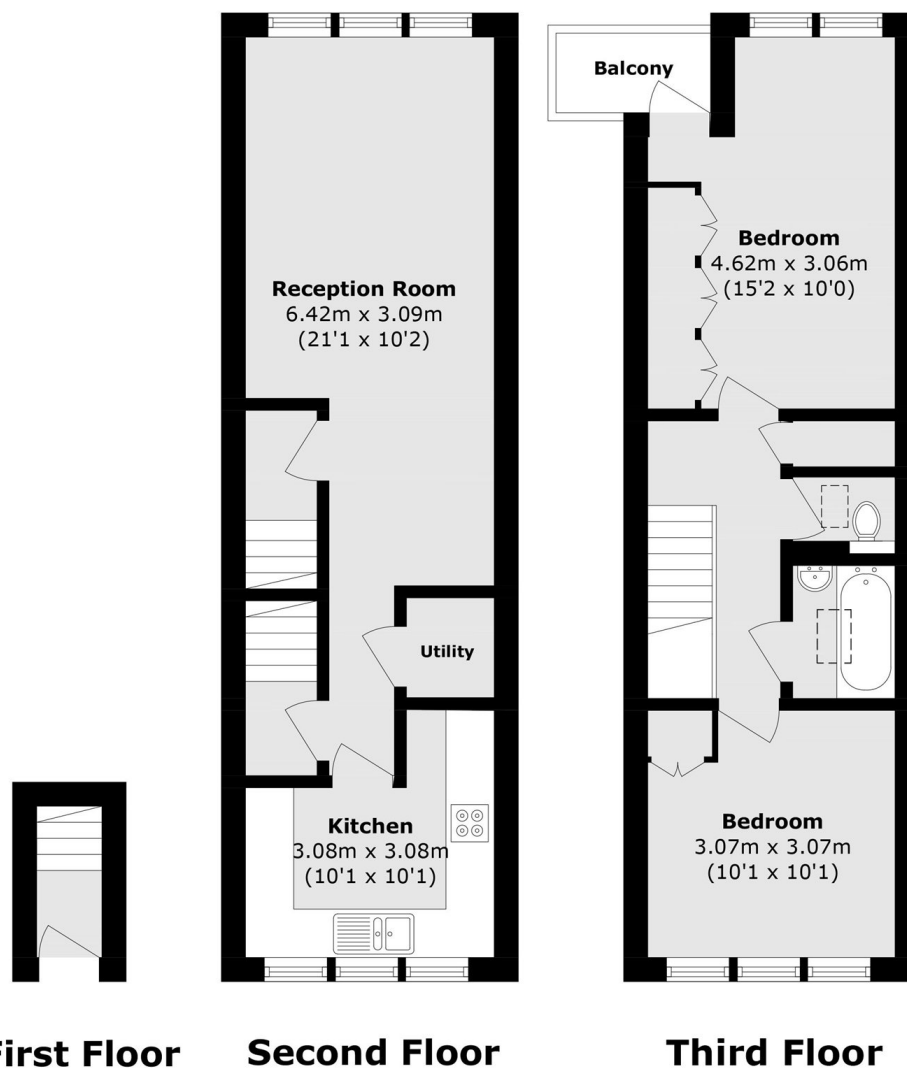

Total (approx.): 70.6 sq. m (759.9 sq. ft)

Balcony area (approx.): 1.9 sq. m (20.4sq. ft)