

WILKINSON

SALES • LETTINGS • MANAGEMENT

£160,000

Hawthorn Way, Northway, Tewkesbury, GL20



1

Bedroom



1

Bathroom

101 High Street, Tewkesbury, Gloucestershire, GL20 5JZ |
Info@wilkinsonslm.co.uk

01684 367736

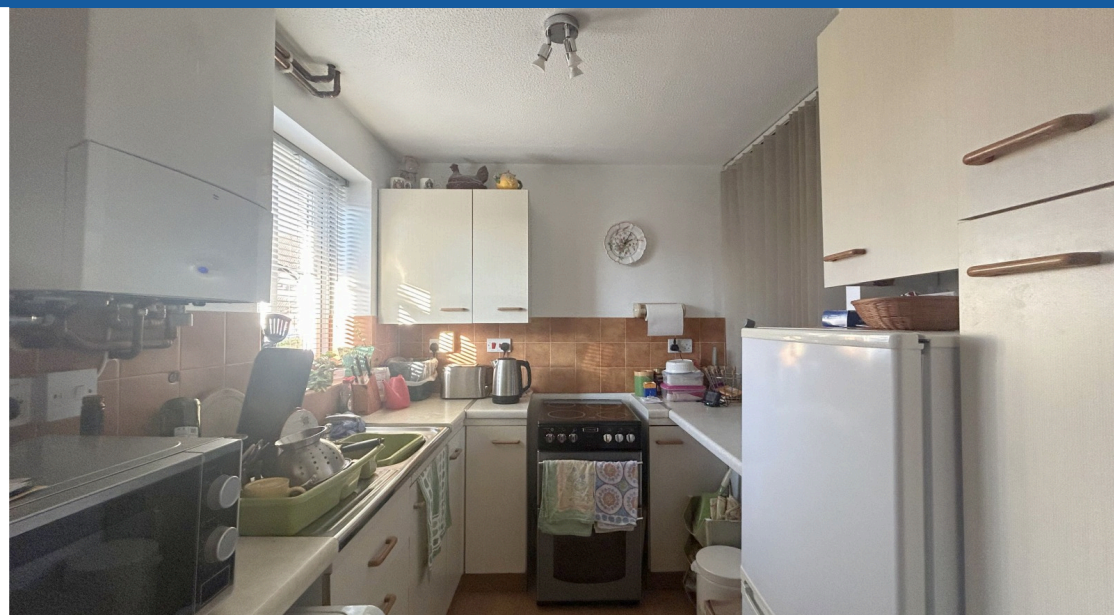

- Mid Terrace House
- Kitchen
- Lounge
- Double Bedroom with Built in Wardrobe
- Bathroom
- Dressing Area & Storage Cupboards
- Low Maintenance Rear Garden
- Parking for One Car
- Gas Central Heating
- UPVC Double Glazing

Wilkinson SLM are pleased to bring to market, a lovely one bedroom, terraced house, situated in a cul de sac in Northway. This home has been owned by the current resident since it was built in 1988! The house offers an enclosed rear garden, an allocated parking space for one car and gas central heating in which the combination boiler was only installed in 2021 and gets annually serviced.

The ground floor accommodates a lounge with a patio door opening out to the rear garden and a kitchen with base and wall units, a free-standing cooker, washing machine and fridge freezer.

The low maintenance rear garden is a patio area which is perfect for outdoor furniture and enjoying a barbeque in the summer days!

The first floor has a good sized double bedroom with a built in wardrobe and a bathroom. There is also an open dressing area with the advantage of storage cupboards.

Finishing this home is UPVC double glazing and is a great opportunity for first time buyers or a rental investment!

Kitchen 6' 7" x 8' 2" (2.01m x 2.49m)

Lounge 11' 8" x 11' 9" (3.56m x 3.58m)

Bedroom 12' 4" x 8' 7" (3.76m x 2.62m)

maximum measurements

Bathroom 5' 11" x 7' 4" (1.80m x 2.24m)

maximum measurements

Ground Floor

Approx. 20.3 sq. metres (218.1 sq. feet)

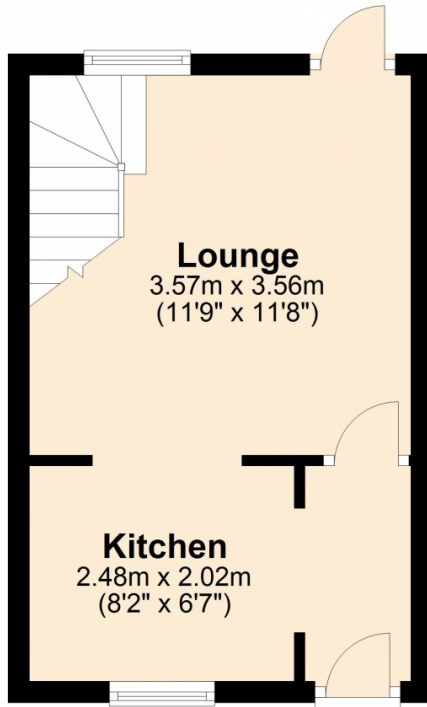

First Floor

Approx. 20.3 sq. metres (218.1 sq. feet)

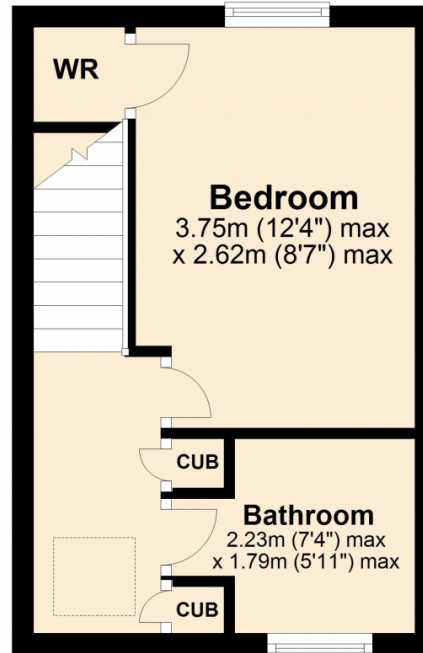

Total area: approx. 40.5 sq. metres (436.2 sq. feet)

This plan is not to scale and is for guidance only. Produced by PlanUp.
Plan produced using PlanUp.



Coming soon

