



## Green Lane Stanmore Offers over £200,000

Davidson Frost-Wellings are pleased to present this three bedroom, two bathroom split level retirement flat set within well maintained grounds. This flat benefits from lots of natural light and has larger than average space.

Located on Green Lane, an excellent location close to amenities including excellent range of shops, restaurants and bars in central Stanmore while nearby places of worship and the stunning open spaces of Bentley Priory and Stanmore Country Park are within easy reach.

Leasehold with 67 years remaining.  
Service charge £4580 per annum.  
Ground rent £422 per annum.  
Harrow Council Tax Band E.

- Three bedrooms
- Two bathrooms
- Split level
- Good condition
- Parking
- Close to shops and transport links

### Viewing

Please contact our Davidson Frost-Wellings Office on 020 8954 8806 if you wish to arrange a viewing appointment for this property or require further information.



# Floor Plan

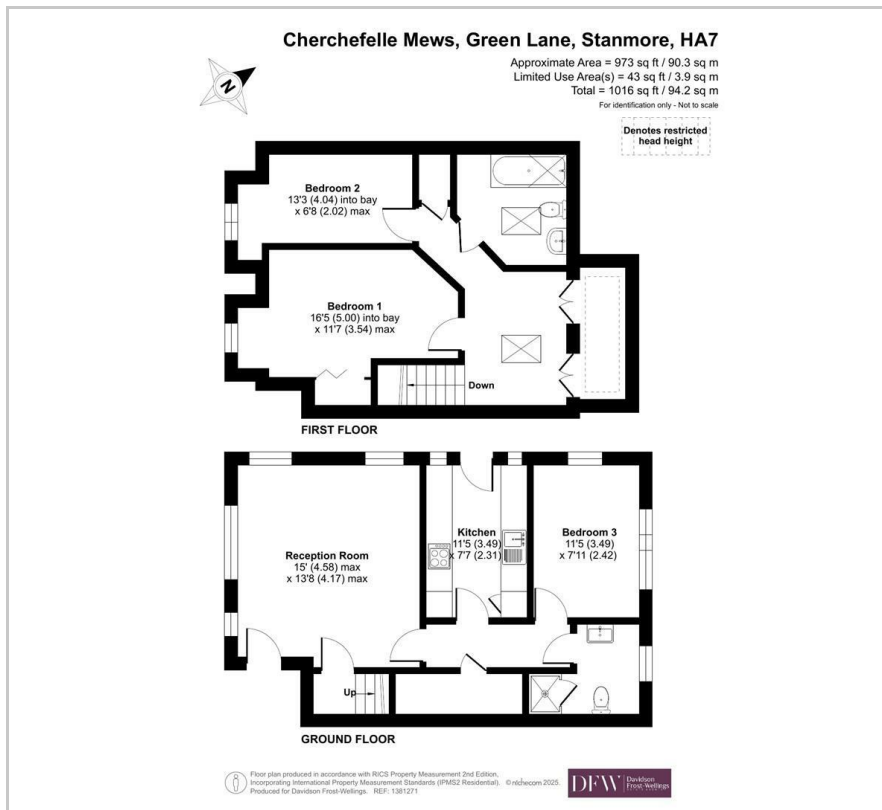

# Area Map



| Energy Efficiency Rating                    |                         |           |
|---|-------------------------|-----------|
|   | Current                 | Potential |
| Very energy efficient - lower running costs |                         |           |
| (92 plus) <b>A</b>                          |                         |           |
| (81-91) <b>B</b>                            |                         |           |
| (69-80) <b>C</b>                            |                         |           |
| (55-68) <b>D</b>                            |                         |           |
| (39-54) <b>E</b>                            | <b>49</b>               | <b>69</b> |
| (21-38) <b>F</b>                            |                         |           |
| (1-20) <b>G</b>                             |                         |           |
| Not energy efficient - higher running costs |                         |           |
| <b>England &amp; Wales</b>                  | EU Directive 2002/91/EC |           |



These particulars, whilst believed to be accurate are set out as a general outline only for guidance and do not constitute any part of an offer or contract. Intending purchasers should not rely on them as statements of representation of fact, but must satisfy themselves by inspection or otherwise as to their accuracy. No person in this firm's employment has the authority to make or give any representation or warranty in respect of the property.