

## Withybrook Road, Shirley, Solihull, B90 2RZ

£180,000

🛏 2 🚿 1 🚗 1



**Bright and Well-Proportioned Two-Bedroom Top Floor Maisonette Offering Excellent Living Space in Popular Solihull Location with an additional benefit of a garage.**

## Key Features

- Spacious two-bedroom top floor maisonette
- Large lounge (16'0" x 10'7") ideal for living and dining
- Generous principal bedroom plus versatile second bedroom/home office
- Private entrance with stairs leading to the main accommodation
- Popular and convenient B90 Solihull location
- Approx. 563 sq. ft. / 52.3 sq. m. of well-proportioned accommodation
- Separate fitted kitchen with good storage and worktop space
- Centrally located bathroom
- Bright interior with excellent natural light throughout
- Ideal for first-time buyers, downsizers or buy-to-let investors

GROUND FLOOR  
563 sq.ft. (52.3 sq.m.) approx.

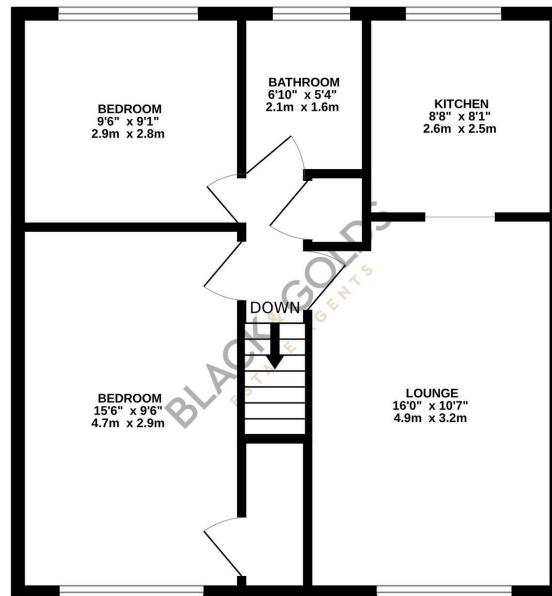

TOTAL FLOOR AREA : 563 sq.ft. (52.3 sq.m.) approx.

While every attempt has been made to ensure the accuracy of the floorplan contained here, measurements of doors, windows, rooms and any other items are approximate and no responsibility is taken for any error, omission or mis-statement. This plan is for illustrative purposes only and should be used as such by any prospective purchaser. The services, systems and appliances shown have not been tested and no guarantee as to their operability or efficiency can be given.  
Made with Metropix iC025