



## St. Andrews Close, KT7

£4,950 Per calendar month

Set within a small private development, this newly refurbished detached family house comes with four double bedrooms, two bathrooms, utility room, office space, a private garage and off street parking, this property is perfect for families.

Situated in the Long Ditton area, with local shops a short walk away and the closest station is Hinchley wood mainline.

### Features

- Four Double Bedrooms
- Double Garage
- Newly Refurbished Throughout
- Detached
- Off-Street Parking
- Private Development



St. Andrews Close, KT7





# St. Andrews Close, Thames Ditton, KT7

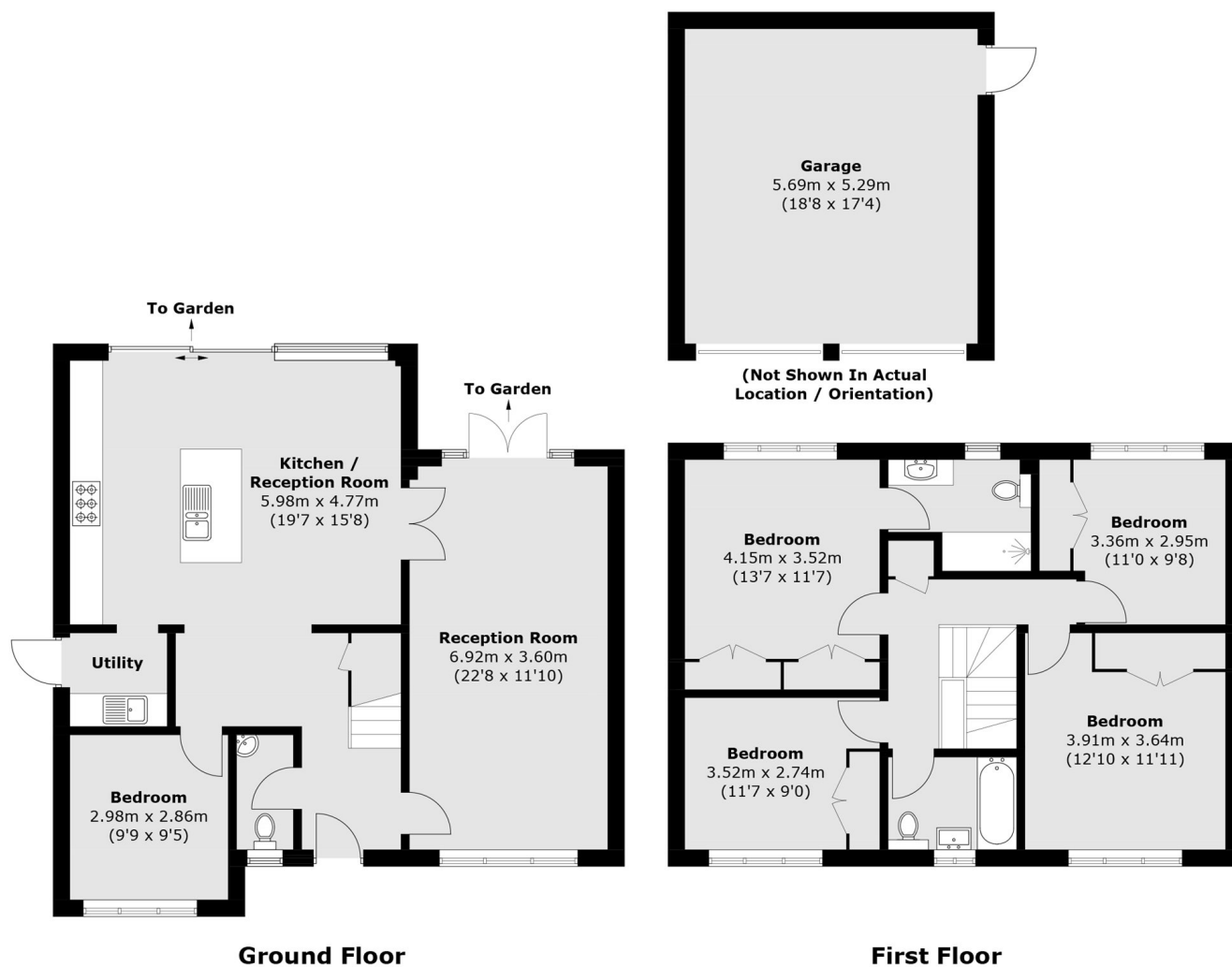

Total area (approx.): 151.0 sq. m (1,625.4 sq. ft)  
Garage: 30.2 sq. m (325.1 sq. ft)