



## Princes Place , Brighton BN1 1EA

- VIDEO Link available
- Available 1st of September 2026
- Open Plan Kitchen Living Room
- One Double Bedroom Apartment
- Second Floor Apartment
- Secure Door Video Entry Telephone System
- Communal Stairs And Lifts
- Furniture Optional
- Modern Kitchen With Appliances
- Students Welcome

**£1,400 PCM**



Local Authority Brighton &  
Hove City Council  
Council Tax Band D  
EPC Rating D

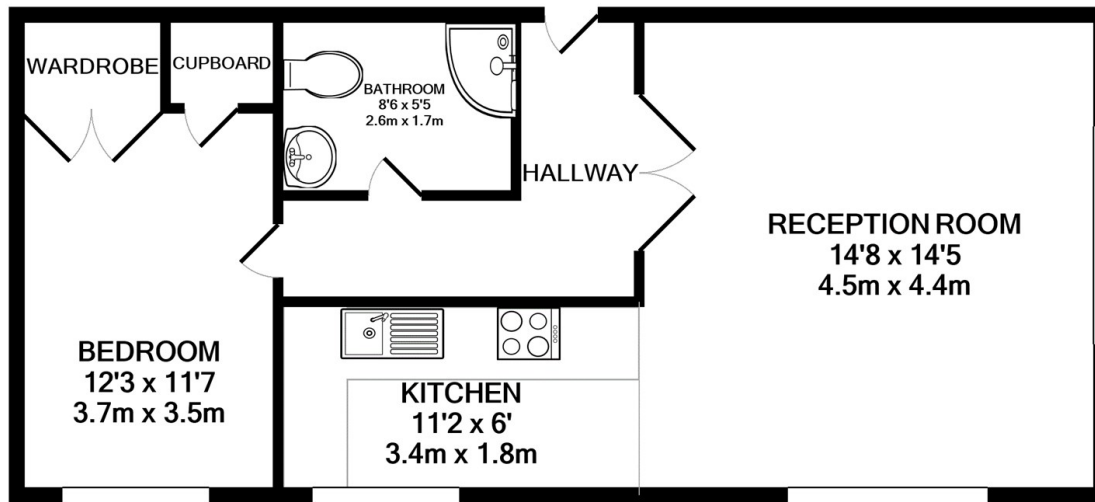

TOTAL APPROX. FLOOR AREA 506 SQ.FT. (47.0 SQ.M.)

Whilst every attempt has been made to ensure the accuracy of the floor plan contained here, measurements of doors, windows, rooms and any other items are approximate and no responsibility is taken for any error, omission, or mis-statement. This plan is for illustrative purposes only and should be used as such by any prospective purchaser. The services, systems and appliances shown have not been tested and no guarantee as to their operability or efficiency can be given  
Made with Metropix ©2020

**Stanfords Lettings Office**  
30-31 North Street, Brighton,  
East Sussex, BN1 1EB

**Contact**  
01273 733334  
lettings@stanfords-  
estates.com  
www.stanfords-estates.com

Agents Note: Whilst every care has been taken to prepare these particulars, they are for guidance purposes only. All measurements are approximate and for general guidance purposes only and whilst every care has been taken to ensure accuracy, they should not be relied upon and potential buyers/tenants are advised to recheck the measurements.