

 3  2  1



# Adelaide Square, *Windsor*

OSBORNE HEATH



**An attractive three bedroom Georgian home located in Windsor's 'Golden Triangle', minutes from the town centre and Long Walk. The property is available immediately and has a good size useable cellar plus a view of Windsor Castle.**

On the ground floor there is a living and dining room with fireplaces, kitchen and breakfast room plus a downstairs WC.

On the first floor there are two double bedrooms, a study or third bedroom, and a bathroom with a roll top bath and separate shower cubicle.

Outside, there is a low maintenance courtyard garden that is mostly paved and has raised flower and shrub beds.

Adelaide Square is a sought after location within Windsor's Golden Triangle, moments from the High Street and The Long Walk. Windsor has a wide range of shops and restaurants as well as the Castle, Great Park, Racecourse and Legoland. Nearby train stations include Windsor & Eton Central and Windsor & Eton Riverside where trains run to London Paddington (via Slough) and London Waterloo. Nearby schools include Eton, The Kings House, Oakfield, The Queen Anne, St Edwards, Trevelyan, Trinity St Stephen, Upton House, Windsor Boys and Windsor Girls. Windsor is also convenient for the M4, M25 and Heathrow Airport.

EPC rating C. Council Tax band F. Tenancy Length 12-36 months. Security Deposit £3,923.00. Holding Deposit £784.00







**APPROXIMATE FLOOR AREA**  
House - 130.23 sq m - 1402 sq ft  
(Gross Internal Area)

**NOT TO SCALE**  
This plan is for illustration purposes only

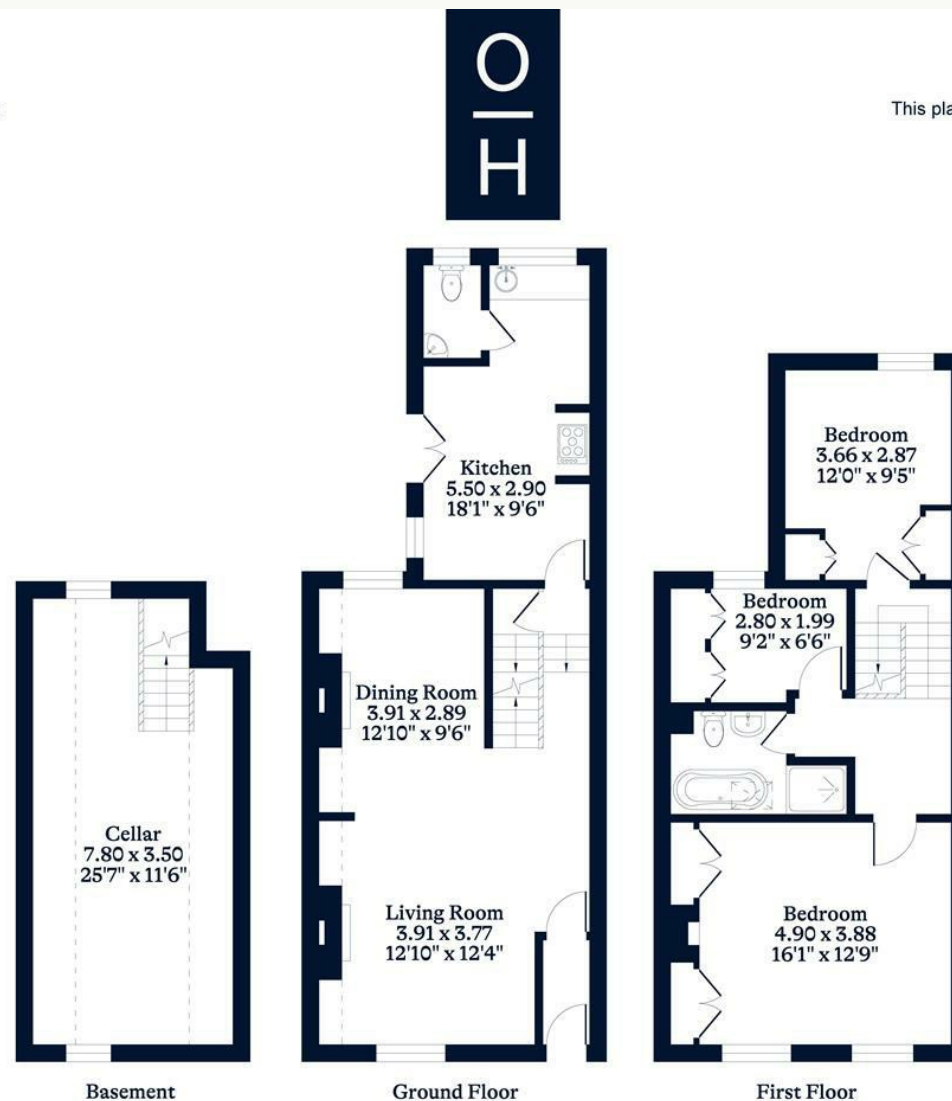

This plan is for layout guidance only. Not drawn to scale unless stated. Windows and door openings are approximate. Whilst every care is taken in the preparation of this plan, please check all dimensions, shapes and compass bearings before making any decisions reliant upon them.

[OSBORNEHEATH.CO.UK](http://OSBORNEHEATH.CO.UK)