



Connells

Stanbridge Road
Tilsworth Leighton Buzzard



Property Description

A delightful one-bedroom mid-terraced cottage situated in the desirable village of Tilsworth, offering character features and a beautifully maintained garden.

The property is approached via a small front patio area leading into a useful porch. Inside, the living room is full of charm, featuring exposed ceiling beams, a feature open fireplace, and attractive bamboo flooring. The kitchen is positioned to the rear and provides direct access out to the garden.

Upstairs, the property offers a generous double bedroom and a beautifully presented bathroom,

Externally, the standout feature is the mature rear garden, which has been lovingly maintained and includes a greenhouse and shed, creating an ideal outdoor space for relaxing or gardening enthusiasts.

Further benefits include on-street parking and a peaceful village setting, whilst still offering convenient access to nearby towns and transport links.

Entrance Porch

Double glazed window. Front door into.

Lounge

Double glazed window. Feature open fireplace with brick surround. 2 radiators. Wooden bamboo flooring. Beamed ceiling.

Kitchen

Double glazed window. Butler sink. Plumbing for washing machine. Space for freestanding electric cooker. Cooker hood. Space for fridge freezer. Tiled walls. Tiled flooring. Door to garden. Stairs rising to upper floor.

Landing

Laminate flooring.

Bedroom

Double glazed window. Electric radiator. Laminate flooring.

Bathroom

Double glazed window. Loft access. Roll top bath with shower over. WC. Wash hand basin. Storage. Laminate flooring.

Outside

Front Garden

Block paved. Shingle. Small wall to borders.

Rear Garden

Laid to lawn. Shed. Mature bushes and scrubs. Shingle path.



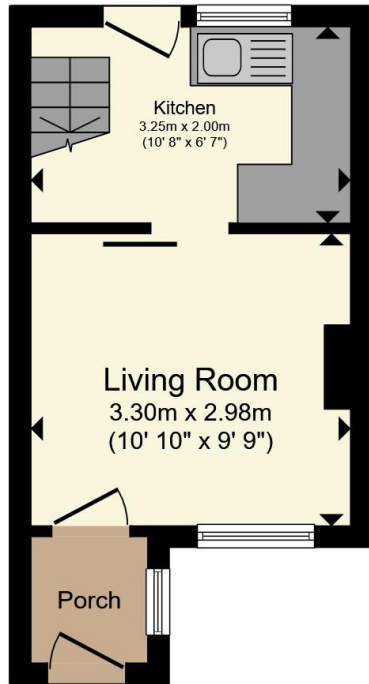

Ground Floor

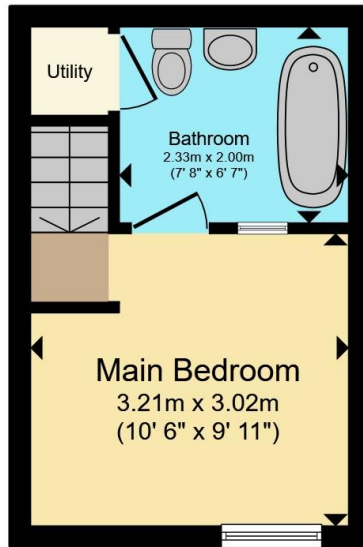

First Floor

Total floor area 34.6 m² (372 sq.ft.) approx

This floor plan is for illustrative purposes only. It is not drawn to scale. Any measurements, floor areas (including any total floor area), openings and orientation are approximate. No details are guaranteed, they cannot be relied upon for any purpose and they do not form part of any agreement. No liability is taken for any error, omission or misstatement. A party must rely upon its own inspection(s). Powered by www.propertybox.io



To view this property please contact Connells on

T 01525 372 588
E leightonbuzzard@connells.co.uk

4 Market Square
 LEIGHTON BUZZARD LU7 1HA

EPC Rating: E Council Tax
 Band: B

view this property online connells.co.uk/Property/LBC311415

Tenure: Freehold



1. MONEY LAUNDERING REGULATIONS Intending purchasers will be asked to produce identification documentation at a later stage and we would ask for your co-operation in order that there will be no delay in agreeing the sale. 2. These particulars do not constitute part or all of an offer or contract. 3. The measurements indicated are supplied for guidance only and as such must be considered incorrect. Potential buyers are advised to recheck measurements before committing to any expense. 4. We have not tested any apparatus, equipment, fixtures, fittings or services and it is in the buyers interest to check the working condition of any appliances.

Connells Residential is registered in England and Wales under company number 1489613, Registered Office is Cumbria House, 16-20 Hockliffe Street, Leighton Buzzard, Bedfordshire, LU7 1GN. VAT Registration Number is 500 2481 05.

See all our properties at www.connells.co.uk | www.rightmove.co.uk | www.zoopla.co.uk

Property Ref: LBC311415 - 0002