



FROGMORE, SW18

£420,000

A two bedroom ground floor flat set within a gated development.

Two bedrooms
Allocated parking
Wandsworth park

Gated development
No chain
Close to the river

@marshandparsons
marshandparsons.co.uk

MARSH &
PARSONS

STEP INSIDE FROGMORE

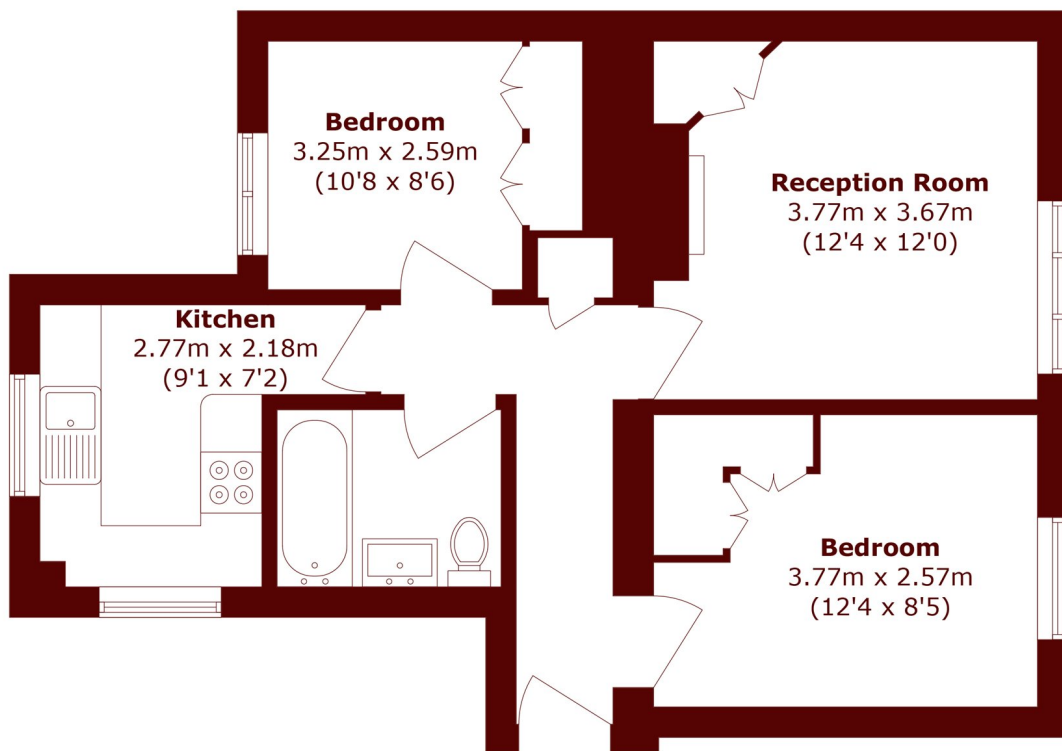

Total area (approx.): 52.9 sq. m (569.4 sq. ft)

Barnes & East Sheen
020 8563 8333

Energy Rating: D We aim to make our particulars both accurate and reliable. However, they are not guaranteed; nor do they form part of an offer or contract. If you require clarification on any points then please contact us, especially if you're traveling some distance to view. Please note that appliances and heating systems have not been tested and therefore no warranties can be given as to their good working order

**MARSH &
PARSONS**