



BOOTH ROAD, E16

£430,000

This fantastic third floor two bedroom apartment offers 685 sq/f worth of living space with a great sized open plan living room and kitchen area, two spacious bedrooms, luxury bathroom and a large terrace with direct views of the River Thames. There is also allocated parking.

- 24h Concierge Service
- Residents Gym
- Parking
- Service Charge; £3,566

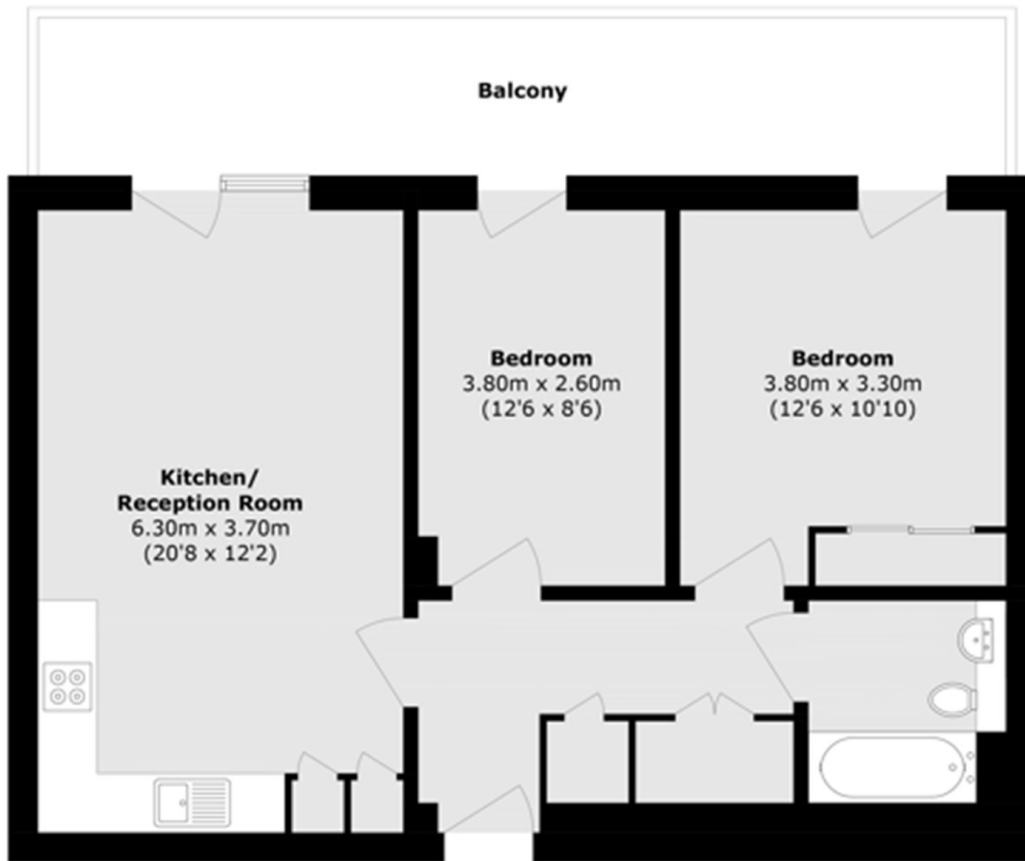

Third Floor

Total area (approx.): 63.7 sq. m (685.7 sq. ft)
Balcony area (approx.): 15.7 sq. m (169.0 sq. ft)

LiFE RESIDENTIAL

36 Millharbour, London, E14
9JS
Sales: 020 3668 1033
Lettings: 020 3668 1030

Energy Rating: C. We aim to make our particulars both accurate and reliable. However they are not guaranteed; nor do they form part of an offer or contract. If you require clarification on any points then please contact us, especially if you're traveling some distance to view. Please note that appliances and heating systems have not been tested and therefore no warranties can be given as to their good working order.