





£235,000

Situated in this highly sought after canal side development, this superbly presented ground floor flat boasts wonderful open plan living with patio doors that open onto a private patio leading to communal gardens that overlook the grand union canal, with a fully fitted kitchen with integrated appliances, a double bedroom, modern bathroom and a utility cupboard with space for a washing machine and dryer. With secure covered parking and access to the private overflow car park. Located just a short walk of both Apsley mainline station to Euston.

Property Description

Entrance

Security door to communal entrance.

Entrance Hall

Hardwood front door to the entrance hall, electric radiator, doors to utility cupboard with plumbing and space for washing machine, hot water tank,

Open plan Lounge, kitchen Diner

Lounge/Diner Area

A dual aspect room with recessed spot lighting, electric radiator, TV point, double glazed door leading to gardens.

Kitchen

Fitted with a range of base and eye level storage units, work surface areas with inset single drainer sink unit with mixer tap, integrated dish washer, fridge freezer, electric hob with oven below and extractor over, recessed spot lights.

Bedroom

Double glazed door and window to the gardens, electric radiator.

Bathroom

A three piece suite comprising a WC, wash hand basin with mixer tap, bath with mixer tap and shower over, tiled surrounds, extractor fan, heated towel rail, recessed spot lights.

Outside

Private patio area leading onto the communal gardens, these have been laid with artificial grass and back directly on to the ground union canal, outside lighting.

Parking

Secure covered parking space, additional access to private overflow car park.

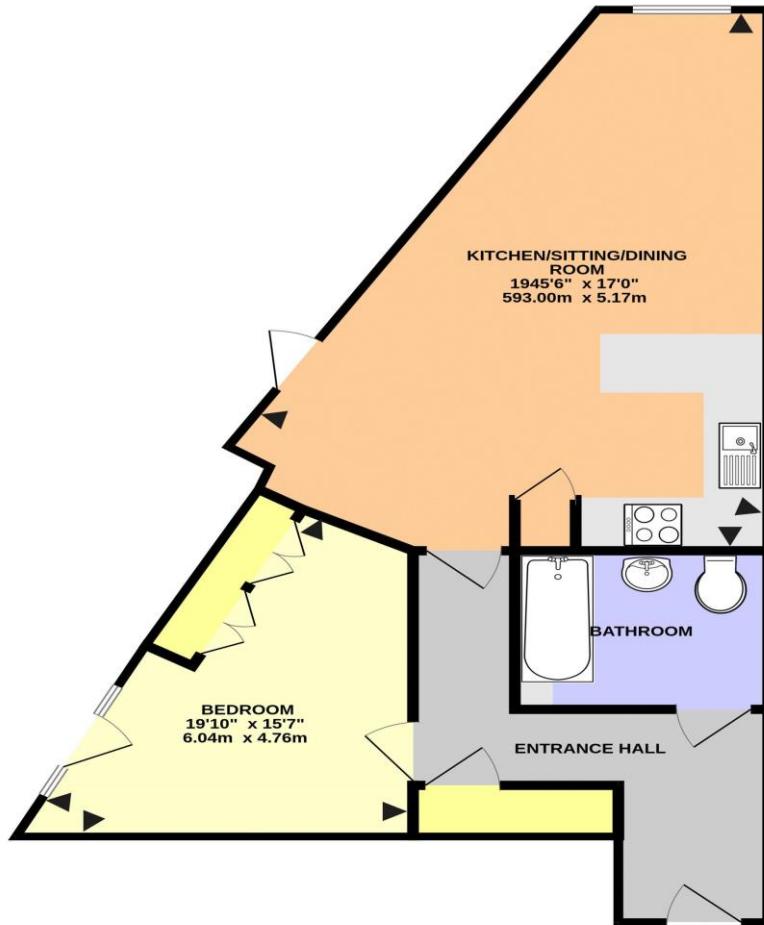

DICKINSON HOUSE, HEMEL HEMPSTEAD HP3 9DR (PRODUCED FOR MICHAEL ANTHONY)

TOTAL FLOOR AREA : 581 sq.ft. (54.0 sq.m.) approx.

No accuracy to this image, text or measurements is guaranteed
Made with Metropix ©2026

MONEY LAUNDERING REGULATIONS 2017 intending purchasers will be asked to produce identification and proof of financial status when an offer is received. We would ask for your co-operation in order that there will be no delay in agreeing the sale.

THE CONSUMER PROTECTION REGULATIONS 2008 The Agent has not tested any apparatus, equipment, fixtures and fittings or services and so cannot verify that they are in working order or fit for the purpose. A Buyer is advised to obtain verification from their Solicitor or Surveyor. References to the Tenure of a Property are based on information supplied by the Seller. The Agent has not had sight of the title documents. A Buyer is advised to obtain verification from their Solicitor. You are advised to check the availability of this property before travelling any distance to view. We have taken every precaution to ensure that these details are accurate and not misleading. If there is any point which is of particular importance to you, please contact us and we will provide any information you require. This is advisable, particularly if you intend to travel some distance to view the property. The mention of any appliances and services within these details does not imply that they are in full and efficient working order. These particulars are in draft form awaiting Vendors confirmation of their accuracy. These details must therefore be taken as a guide only and approved details should be requested from the agents

33 Marlowes Hemel Hempstead Herts HP1 1LA
01442 260025 | hemel@maea.co.uk