

6 Hammett Road, Chorlton Green, Manchester, M21 9HY



JP&Brimelow
ESTATE AGENTS



3 2 2 C

VIDEO TOUR AVAILABLE An attractive and beautifully renovated, THREE BEDROOM, mid-terrace property. The property is located in the heart of Chorlton Green and has been internally remodelled and extended by the current owners creating space and modern living throughout.

With Chorlton Nature Reserve at the bottom of the road, Brookburn & Chorlton C & E primary schools are all on your doorstep and the cafes and bars for which Chorlton Green is loved by so many, is a five-minute walk away on Beech Road.

The property has undergone a complete back to brick restoration, offering a wealth of charm and character and has been updated to an excellent standard throughout.

The property is spread over three floors and in brief comprises of a stunning front facing lounge, and an impressive open plan kitchen/dining area. The kitchen is fully fitted and complete with a central breakfast island and high-end fixtures and fittings, and a useful storage cupboard. The dining area overlooks the rear courtyard-style garden and opens onto it via bi-fold doors, creating a seamless indoor-outdoor living space.

Stairs leading to the first-floor landing reveals two good sized double bedrooms, and a stylishly designed white three-piece bathroom suite finished with brushed gold finishes.

Whilst to the second floor there is an additional well-proportioned bedroom complimented by an en-suite shower room, dressing area, and access into the useful eave's storage.

Other benefits include gas fired central heating, period features, high ceilings, ceiling coving, column radiators, and a rear enclosed landscaped courtyard.

OFFERED WITH NO ONWARD CHAIN.

£495,000





EPC Chart

Energy Efficiency Rating		Current	Potential
Very energy efficient - lower running costs			
(92 plus) A			
(81-91) B			86
(69-80) C		76	
(55-68) D			
(39-54) E			
(21-38) F			
(1-20) G			
Not energy efficient - higher running costs			
England & Wales		EU Directive 2002/91/EC 	



Tenure: Freehold Council Tax Band: B

Ground Floor



First Floor

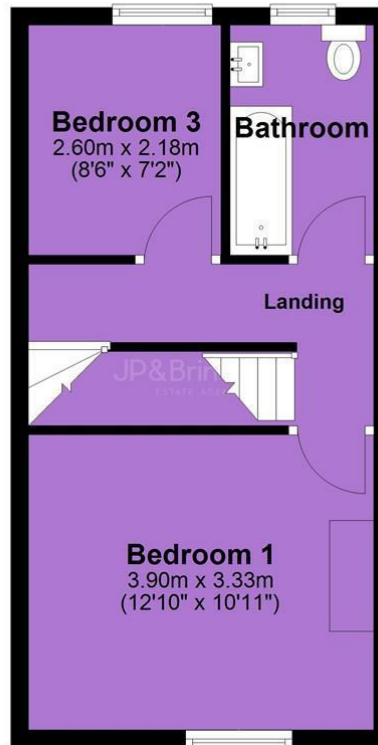

Second Floor

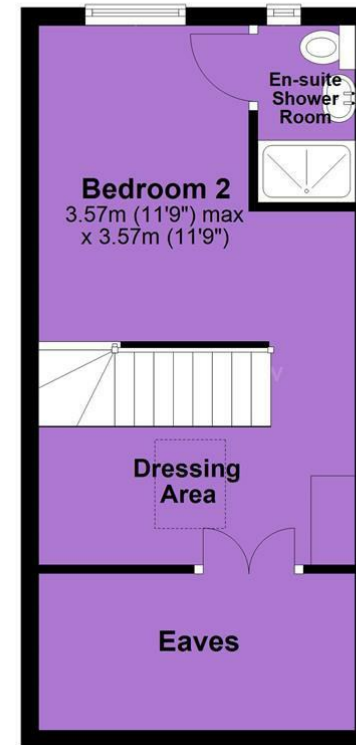

JP & Brimelow Estate Agents Ltd
430 Barlow Moor Road, Manchester, M21 8AD
Tel: 0161 8822233
E: sales@jpbrimelow.co.uk www.jpandbrimelow.co.uk



JP & Brimelow
ESTATE AGENTS

NOTICE: JP & Brimelow Estate Agents Ltd for themselves and for the vendors or lessors of this property whose agents they are give notice that:

- (i) the particulars are set out as a general outline only for the guidance of intending purchasers or lessees, and do not constitute, nor constitute part of, an offer or contract;
- (ii) all descriptions, dimensions, references to the condition and necessary permissions for use and occupation, and other details are given in good faith and are believed to be correct but any intending purchasers or tenants should not rely on them as statements or representations of fact but must satisfy themselves by inspection or otherwise as to the correctness of each of them;
- (iii) no person in the employment of JP & Brimelow Estate Agents Ltd has any authority to make or give any representation or warranty whatever in relation to this property.

jpandbrimelowstateagents

@jpandbrimelow

