



## Cornell Square, SW8

£2,500 Per calendar month

A spacious and well-presented two double bedroom apartment on the fifth floor of this popular gated development. The property offers an open plan kitchen/living room, large bathroom and a private balcony

The property is Ideally located for the newly opened Nine Elms Underground Station. There is a good selection of local shops, cafés and a large Sainsbury's on Wandsworth Road.

### Features

- Two Bedrooms
- Bright & Spacious
- Open Plan Kitchen
- Floor To Ceiling Windows
- Neutral Decor
- Private Balcony

# Cornell Square, London, SW8

## Fifth Floor

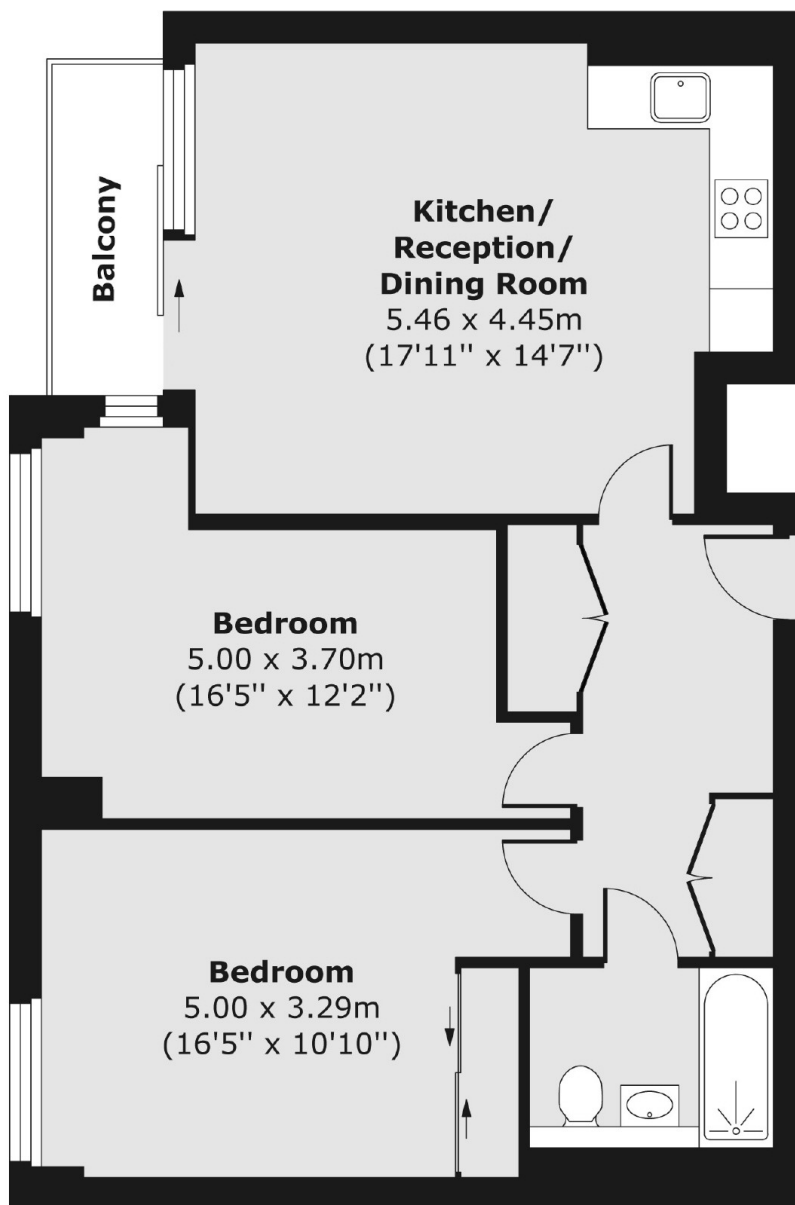

Total area (approx.) 66.57 sq. m (717 sq. ft)

Balcony area (approx.) 3.29 sq. m (35 sq. ft)