



Connells

Blackwood Avenue
Wednesfield Wolverhampton

Blackwood Avenue Wednesfield Wolverhampton WV11 1EY

for sale offers in the region of
£220,000



Property Description

Connells Wolverhampton are delighted to bring to the market this deceptively spacious two bedroom family on an enviable corner plot. Benefiting from abundance of external space, this property must be viewed in order to fully understand and appreciate.

The property comprises entrance hall, large lounge diner, stylish family kitchen and conservatory. On the first floor there are two well proportioned bedrooms and bathroom. Externally there is a detached garage to rear with driveway area, front, side and rear gardens, offering extension possibilities subject to relevant permissions.

Entrance Hall

Double glazed door to front, stairs to first floor landing, doors to various rooms.

Lounge Diner

20' 1" x 11' 5" (6.12m x 3.48m)

Double glazed window to front, central heating radiator, electric fire, french doors to conservatory.

Conservatory

Double glazed all around.

The Location & Area

Situated on the ever popular Long Knowle Estate noted for its popular school. Doctors dentists, public houses and eateries are all within close proximity and further shopping can be found within Wednesfield and Bentley Bridge Retail Park. New Cross Hospital, the M54 and M6 motorways are also conveniently located within close proximity.

Kitchen

11' 5" x 7' 6" (3.48m x 2.29m)

Double glazed window to rear and side, a range of wall and base units with inset sink, space for various appliances, door to entrance hall.



First Floor Landing

Doors to various rooms.

Bedroom One

10' 4" x 14' 2" (3.15m x 4.32m)

Double glazed window to front, central heating radiator, door to first floor landing.

Bedroom Two

9' 7" x 10' 8" (2.92m x 3.25m)

Double glazed window to rear, central heating radiator, door to first floor landing.

Bathroom

Double glazed window to rear, panelled bath, vanity sink, low flush toilet, door to first floor landing.

Outside Front

Brick built wall and entry pillars, pathway to front entrance, lawned garden area, hedgerow.

Outside Side

Paved area, brick wall, driveway to rear leading to detached garage.

Detached Garage

Outside Rear

Decking area, gravelled area, outbuilding, archway leading to a paved area.









Ground Floor

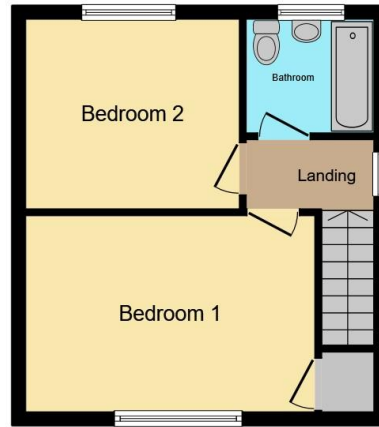

First Floor

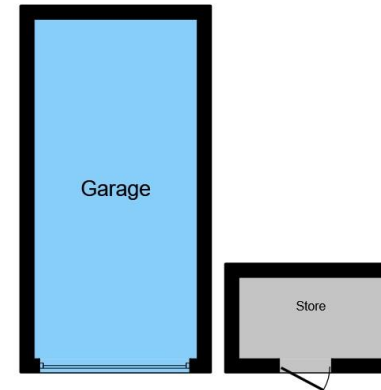

Garage

Total floor area 87.5 m² (942 sq.ft.) approx

This floor plan is for illustrative purposes only. It is not drawn to scale. Any measurements, floor areas (including any total floor area), openings and orientation are approximate. No details are guaranteed, they cannot be relied upon for any purpose and they do not form part of any agreement. No liability is taken for any error, omission or misstatement. A party must rely upon its own inspection(s). Powered by www.propertybox.io



To view this property please contact Connells on

T 01902 710 170
E wolverhampton@connells.co.uk

81-83 Darlington Street
WOLVERHAMPTON WV1 4EX

EPC Rating: D Council Tax
Band: A

Tenure: Freehold

view this property online connells.co.uk/Property/WVH335102



1. MONEY LAUNDERING REGULATIONS Intending purchasers will be asked to produce identification documentation at a later stage and we would ask for your co-operation in order that there will be no delay in agreeing the sale. 2. These particulars do not constitute part or all of an offer or contract. 3. The measurements indicated are supplied for guidance only and as such must be considered incorrect. Potential buyers are advised to recheck measurements before committing to any expense. 4. We have not tested any apparatus, equipment, fixtures, fittings or services and it is in the buyers interest to check the working condition of any appliances.

Connells Residential is registered in England and Wales under company number 1489613, Registered Office is Cumbria House, 16-20 Hockliffe Street, Leighton Buzzard, Bedfordshire, LU7 1GN. VAT Registration Number is 500 2481 05.

See all our properties at www.connells.co.uk | www.rightmove.co.uk | www.zoopla.co.uk

Property Ref: WVH335102 - 0003