



53 Eastlake, Tadpole Garden Village

Swindon

£525,000

mcfarlane
property.com



53 Eastlake

Tadpole Garden Village, Swindon

Situated in the highly sought-after Tadpole Garden Village, This property presents a rare opportunity to acquire an immaculate and beautifully upgraded four-bedroom detached home. Stylishly finished throughout and designed with modern family living in mind, this property offers generous proportions, exceptional natural light, and a sophisticated aesthetic from the moment you step inside. The heart of the home is the **stunning open-plan kitchen, dining, and family space**, featuring a contemporary shaker-style kitchen, central island, integrated appliances, and elegant pendant lighting. This bright and airy space flows effortlessly into the landscaped rear garden, creating the perfect environment for both everyday living and entertaining.



- FOUR DOUBLE BEDROOMS WITH MASTER EN-SUITE
- HIGH-SPECIFICATION FINISH THROUGHOUT
- PREMIUM SHAKER KITCHEN WITH INTEGRATED APPLIANCES
- BRIGHT DUAL-ASPECT LOUNGE WITH FRENCH DOORS
- LANDSCAPED LOW-MAINTENANCE GARDEN
- DETACHED GARAGE & DRIVEWAY PARKING
- SHOW HOME PRESENTATION THROUGHOUT
- POPULAR TADPOLE GARDEN VILLAGE LOCATION



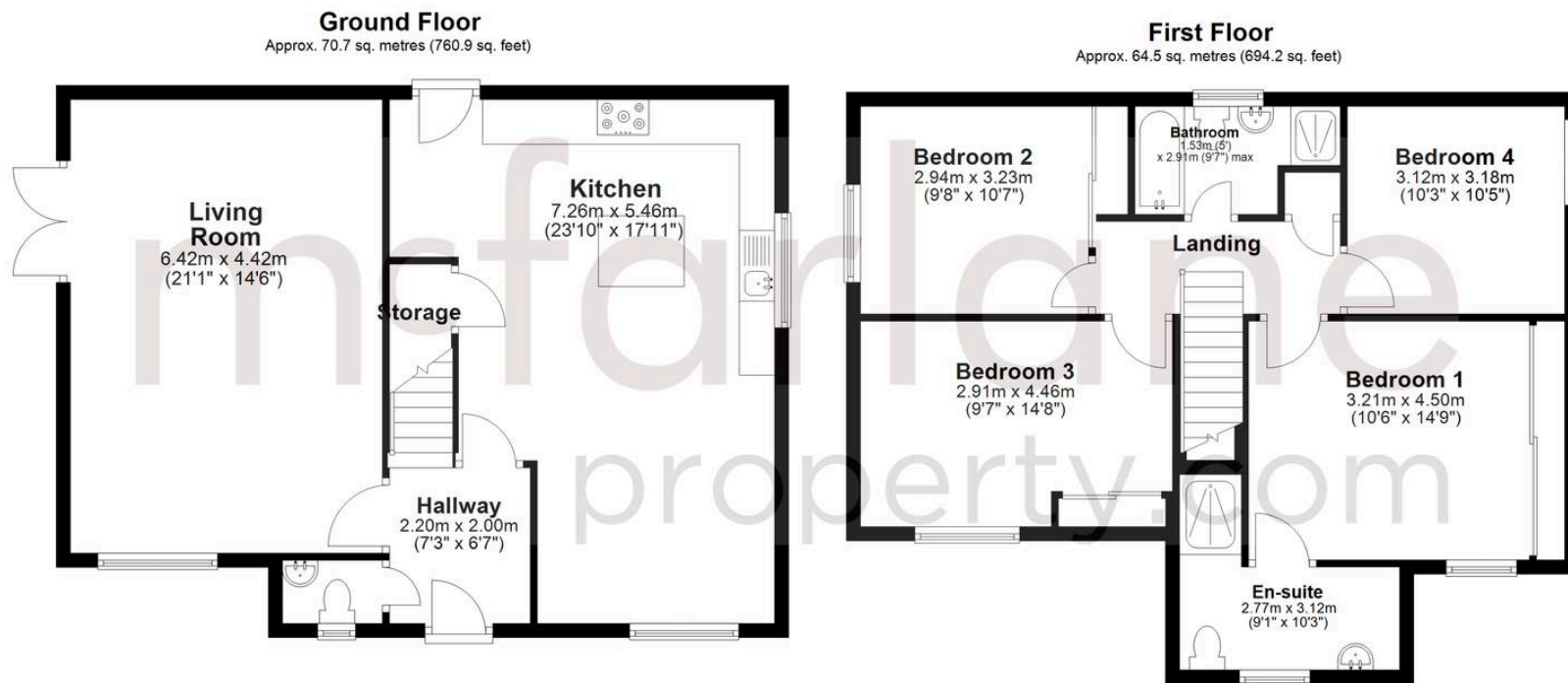

Total area: approx. 135.2 sq. metres (1455.1 sq. feet)

McFarlane Sales & Lettings

North Swindon, Redhouse Village Centre, Swindon - SN25 2FW

01793 296600 • swindon@mcfarlaneproperty.com • www.mcfarlaneproperty.com/