

15 Blenheim Close - £1,300 PCM

West Row Bury St. Edmunds IP28 8QA

shires

Estate & Letting Agents



"Consistently providing outstanding service to our clients"

£1,300 PCM

The Property

****MODERN & SPACIOUS**** A semi detached three bedroom property located in the popular village of West Row. Close to both RAF Mildenhall & RAF Lakenheath. Benefitting from kitchen/diner, spacious lounge, down stairs W.C, master with ensuite, garage and off road parking. Available to view now!

AGENTS NOTE: In accordance with The Property Ombudsman requirements, you are advised that a member of Shires staff (or their family members) have an interest in this property.

A MODERN & SPACIOUS semi detached three bedroom property located in the popular village of West Row. Close to both RAF Mildenhall & RAF Lakenheath. Benefitting from kitchen/diner, spacious lounge, down stairs W.C, master with ensuite, garage and off road parking. Available to view now!

• Henleys offers a fantastic tenant service covering all aspects of your move including Life Safety Inspections, tenancy agreements approved by the 48CES referral office , all utility connections and council tax exemptions, FMO furniture and local advice to en sure your move is a smooth one.

•• If you are not exempt from council tax the band for this property will be a C

Features

- Semi Detached House
- Three Bedrooms
- Modern Throughout
- Downstairs WC
- Master With Ensuite
- Garage
- Off Road Parking
- Close to RAF Mildenhall
- Available To View Now



These sales particulars have been produced as a general guide only and we would draw to your attention that we have not carried out a detailed Survey of the property nor have we tested services, appliances or specific fittings. Whilst measurements and statements given within the details are provided in good faith, their accuracy should not be relied upon. If there are any points about which you may be uncertain or would like further clarification, we would suggest that you telephone this office and speak to our staff who will endeavour to assist you.

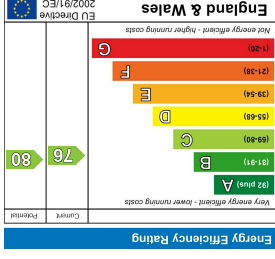

Whilst every attempt has been made to ensure the accuracy of the floor plan contained here, measurements of doors, windows, rooms and any other items are approximate and no responsibility is taken for any error, omission, or mis-statement. This plan is for illustrative purposes only and should be used as such by any prospective purchaser. The services, systems and appliances shown have not been tested and no guarantee as to their operability or efficacy can be given.
 Made with Metropix ©2019

GROUND FLOOR

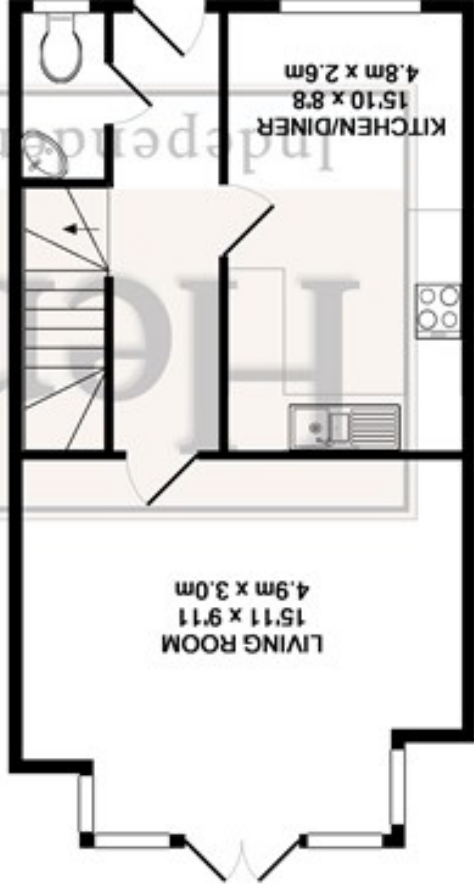

1ST FLOOR

