

SIGNATURE

NORTH EAST

OFFICIALLY RATED THE NO.1 ESTATE AGENT IN THE NORTH EAST





 Humford Way, Bedlington NE22 5ET

Humford Way,
Bedlington NE22 5ET

**Offers In The Region
Of £340,000**

Signature North East welcomes you to this charming three-bedroom bungalow in Bedlington, quietly positioned within a peaceful cul-de-sac and enjoying a superb sense of privacy, with no neighbouring homes overlooking the property. Local amenities and green spaces are close at hand, with Bedlington Railway Station and the stunning Blyth beach only a short distance away by car.

Step through the entrance hallway into the inviting living room, offering ample space for furnishings, a cosy fireplace, and a large window that floods the room with natural light. The well-sized kitchen, installed in 2022, provides attractive wall and base units, quality countertops, and integrated appliances including an oven and hob. There is comfortable space for a dining set, and access to the rear garden is available directly from the kitchen.

Continuing through the home, you'll find three bedrooms, two of which are generous doubles. All bedrooms are equipped with fitted wardrobes, with bedroom one further benefiting from an en suite featuring a walk-in shower. A family bathroom, complete with a bathtub, wash basin, and WC, provides additional convenience and completes this home.

Externally, the property sits on a large plot with established front and rear gardens, offering mature lawns, well-tended hedges, and attractive patio and stone areas. Off-street parking is provided via a garage and driveway, ensuring practicality alongside the home's appealing setting.



PLEASE NOTE THAT THE VENDOR HAS CERTIFIED THE PROPERTY INFORMATION AND IMAGES.

PROPERTY FLOORPLAN

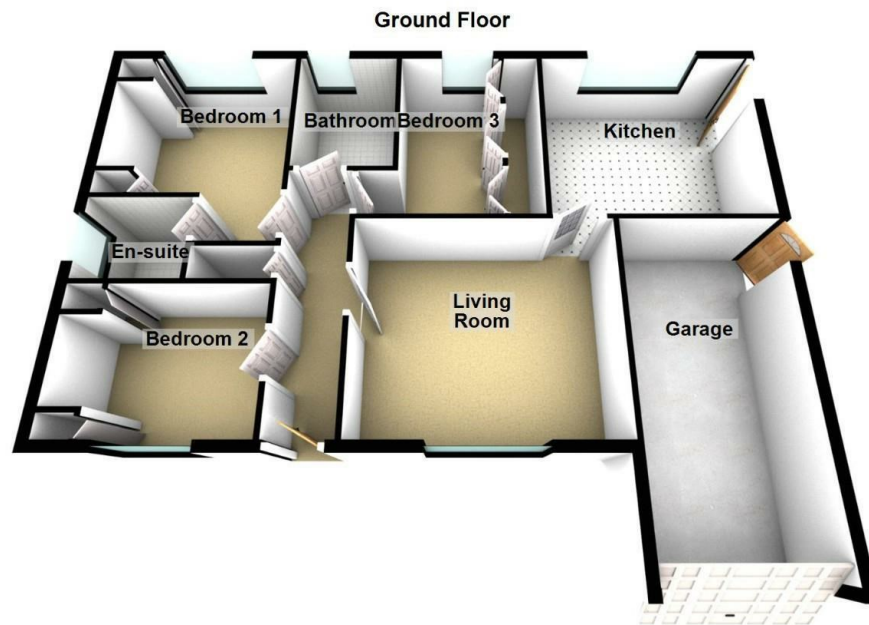

Total area: approx. 94.7 sq. metres (1019.6 sq. feet)

Measurements:

Living Room
12'8" x 14'9"

Kitchen
11'2" x 13'0"

Bedroom One
13'0" x 8'10"

En Suite
5'1" x 6'2"

Bedroom Two
8'5" x 11'1"

Bedroom Three
11'3" x 8'7"

Bathroom
8'0" x 6'1"

Garage
19'2" x 8'10"

Energy Efficiency Rating

	Current	Potential
<i>Very energy efficient - lower running costs</i>		
(92 plus) A		
(81-91) B		
(69-80) C		74
(55-68) D	62	
(39-54) E		
(21-38) F		
(1-20) G		
<i>Not energy efficient - higher running costs</i>		
England & Wales	EU Directive 2002/91/EC 	





More 5 Star Customer Reviews than any other Agent based in the North East on allAgents.co.uk



SALES

LETTINGS

FINANCE

LAW

WE COVER THE WHOLE OF THE NORTH EAST

Whitley Bay
0191 251 3344

Cramlington
01670 897 213

Tynemouth
0191 296 6689

Morpeth
01670 513 966

Ponteland
01661 820 082

Wallsend
0191 432 4151

Alnwick
01665 511 800

Heaton
0191 432 4275

Forest Hall
0191 266 9966

Other locations
0191 640 3523

Newcastle
0191 640 2284

Durham
0191 303 8252

Gosforth
0191 640 3523

Sunderland
0191 543 6390

Whickham
0191 432 5102

Gateshead
0191 432 4294

Jesmond
0191 281 1037

Killingworth
0191 640 3602

Ryton
0191 413 9845

Head Office &
Lettings
0191 253 4815

*Highest recommended 5-star reviews than any other Estate Agent based in the North East on allAgents.co.uk - The UK's Largest Customer Review Website for the Property Industry & Awarded Best Estate Agency 2018 & 2019 - North East England by SME News