



Connells

Broadway
Hednesford, Cannock



Ground Floor

Porch

Having a double glazed front entrance door, ceiling light point, carpeted flooring and door to lounge

Living Room

16' x 22' 4" (4.88m x 6.81m)

Having a double glazed window to the front aspect, two radiators, ceiling spotlights, laminate flooring, ample understairs storage space, stairs to the first floor and doors to guest WC, dining room and kitchen

Dining Room

7' 9" x 8' 7" (2.36m x 2.62m)

Having a double glazed window to the rear aspect, radiator, ceiling spotlights and laminate flooring

Kitchen

6' 6" x 8' 7" (1.98m x 2.62m)

Being a fitted kitchen with a range of wall, base and drawer units with laminate work surfaces over and having a sink/drain, integrated oven stack, induction hob, extractor hood, plumbing for the dishwasher, space for appliances, tiled splash-backs, ceiling spotlights, laminate flooring, double glazed window to the rear aspect and double glazed door to the rear garden

Wet Room

Being a fully tiled room and having a WC, wash hand basin and shower



First Floor

Landing

Having carpeted flooring, ceiling spotlights, double glazed window to the side aspect and doors to bedrooms and bathroom

Bedroom 1

9' 8" x 10' 11" (2.95m x 3.33m)

Having a double glazed window to the front aspect, radiator, ceiling spotlights and carpeted flooring

Bedroom 2

7' 8" x 10' 9" (2.34m x 3.28m)

Having a double glazed window to the rear aspect, radiator, ceiling spotlights and carpeted flooring

Bedroom 3

8' x 7' 9" (2.44m x 2.36m)

Having a double glazed window to the rear aspect, radiator, ceiling spotlights and carpeted flooring

Bathroom

Having a WC, wash hand basin, bath with shower over, towel radiator, ceiling spotlights and tiled walls and flooring

Outside

Front

Having a block paved driveway suitable for multiple vehicles and side access to the rear garden

Rear

Having a paved patio area and laid to lawn









Ground Floor

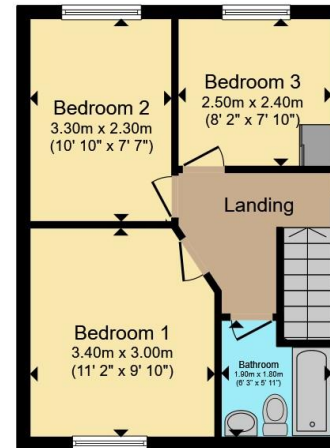

First Floor

Total floor area 82.6 m² (889 sq.ft.) approx

This floor plan is for illustrative purposes only. It is not drawn to scale. Any measurements, floor areas (including any total floor area), openings and orientation are approximate. No details are guaranteed, they cannot be relied upon for any purpose and they do not form part of any agreement. No liability is taken for any error, omission or misstatement. A party must rely upon its own inspection(s). Powered by www.propertybox.io

Connells

To view this property please contact Connells on

T 01543 500923
E cannock@connells.co.uk

10-12 Wolverhampton Road
CANNOCK WS11 1AH

EPC Rating: D Council Tax
Band: C

Tenure: Freehold

view this property online connells.co.uk/Property/CNK108433



1. MONEY LAUNDERING REGULATIONS Intending purchasers will be asked to produce identification documentation at a later stage and we would ask for your co-operation in order that there will be no delay in agreeing the sale. 2. These particulars do not constitute part or all of an offer or contract. 3. The measurements indicated are supplied for guidance only and as such must be considered incorrect. Potential buyers are advised to recheck measurements before committing to any expense. 4. We have not tested any apparatus, equipment, fixtures, fittings or services and it is in the buyers interest to check the working condition of any appliances.

Connells Residential is registered in England and Wales under company number 1489613, Registered Office is Cumbria House, 16-20 Hockliffe Street, Leighton Buzzard, Bedfordshire, LU7 1GN. VAT Registration Number is 500 2481 05.

See all our properties at www.connells.co.uk | www.rightmove.co.uk | www.zoopla.co.uk

Property Ref: CNK108433 - 0001