



9 Antrobus Street, Congleton,
CW12 1HG



STEPHENSON BROWNE



STEPHENSON BROWNE

£950 PCM



Available January on Antrobus Street in Congleton, this beautifully refurbished mid-terrace house offers a delightful blend of modern living and classic character. Spanning an impressive 926 square feet, this property, built in 1900, has been thoughtfully updated to provide a bright and inviting atmosphere throughout.

As you enter, you are greeted by two spacious reception rooms, the first featuring a striking brick fireplace that serves as a focal point, complemented by stylish laminate flooring. The second reception room flows seamlessly into the contemporary kitchen, which is equipped with a cooker and separate hob, making it perfect for both casual dining and entertaining.

Upstairs, you will find two generously sized double bedrooms, each filled with natural light, providing a peaceful retreat at the end of the day. The large bathroom is a standout feature, boasting both a bath and a separate shower, catering to all your relaxation needs.

The property also benefits from a cellar. The rear yard, ideal for enjoying the outdoors, along with residential parking for your convenience. Its prime location means you are just a short stroll away from Congleton town centre, the leisure centre, and the newly developed market quarter, offering a variety of shops, restaurants and amenities.

This home is perfect for those seeking a blend of comfort, style, and convenience in a vibrant community. Don't miss the opportunity to make this lovely property your new home in 2026.



- Available in January - Fully refurbished terrace home
- New windows and doors
- Brick fireplace in lounge
- Large bathroom with bath & shower
- Close to Congleton Park
- Two spacious double bedrooms
- Natural light throughout
- Open-plan kitchen/dining area
- Residential parking
- Near Congleton Leisure Centre and the New Market Quarter

View all of our properties at www.stephensonbrowne.co.uk



STEPHENSON BROWNE



STEPHENSON BROWNE

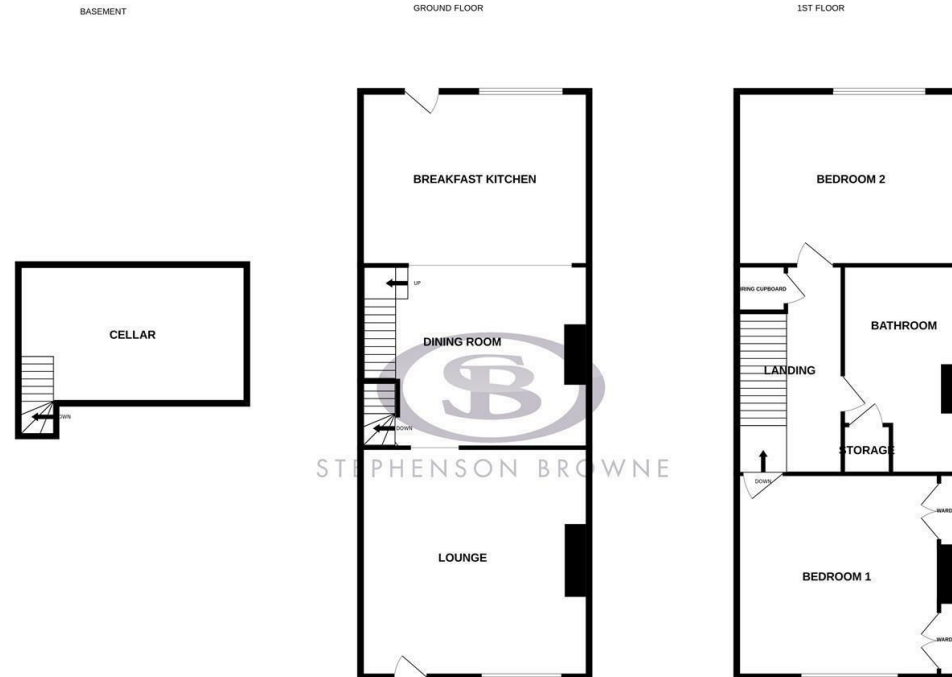

Whilst every attempt has been made to ensure the accuracy of the floorplan contained here, measurements of doors, windows, rooms and any other items are approximate and no responsibility is taken for any error, omission or mis-statement. This plan is for illustrative purposes only and should be used as such by any prospective purchaser. The services, systems and appliances shown have not been tested and no guarantee is given to their operability or efficiency can be given.
Made with Metropix ©2025

21 High Street, Congleton, CW12 1BH Tel: 01260 545600
View all of our properties at www.stephensonbrowne.co.uk

NOT TO SCALE These floor plans are given as a guide only. Full completed measurements and details should be verified by any intending purchasers legal representative.

NOTICE: Stephenson Browne for themselves and for the vendors or lessors of this property whose agents they are give notice that: (1)the particulars are set out as a general guideline only for the guidance of intending purchasers or lessees, and do not constitute, nor constitute part of, an offer or contract; (2)all descriptions, dimensions, references to condition and necessary permissions for use and occupation, and other details are given in good faith and are believed to be correct but any intending purchasers or tenants should not rely on them as statements or representations of fact but must satisfy themselves by inspection or otherwise as to the correctness of each theme; (3)no person in the employment of Stephenson Browne has any authority to make representation or warranty whatever in relation to this property. (4)fixtures & fittings are subject to a formal list supplied by vendors solicitors. **Referring to:** Move with Us Ltd **Average Fee:**£123.64

