

SIGNATURE

NORTH EAST

OFFICIALLY RATED THE NO.1 ESTATE AGENT IN THE NORTH EAST





 East Farm, Morpeth NE61 3LA

East Farm, Morpeth NE61 3LA

Offers Over £640,000

Signature North East are delighted to welcome this impressive four-bedroom barn conversion to the market, ideally located just outside of Morpeth town centre. Set within a highly sought-after position, the property enjoys a superb balance of countryside tranquillity and convenience, surrounded by open farmland and scenic walking routes. Despite its peaceful setting, Morpeth town centre is just a short drive away, offering a wide range of amenities, well-regarded schools and excellent rail links, making this an ideal home for those seeking space, privacy and accessibility.

Upon entering, you are welcomed into a central hallway leading through to a spacious living room, offering ample room for a range of furnishings. The living area flows seamlessly into a stunning garden room, enhanced by two striking arched windows that flood the space with natural light. The property showcases beautiful exposed stone brickwork throughout, adding character and charm in keeping with its barn conversion style. The open plan kitchen/diner provides excellent space for a dining table, alongside a breakfast bar for more casual dining. The kitchen is well appointed with a range of attractive wall and base units, complemented by sleek worktops and integrated appliances including a fridge and dishwasher. French doors, framed with elegant stone detailing, lead out to a charming paved area. Completing the ground floor is a generous utility room with built-in units and rear access, along with a convenient W.C.

To the first floor, there are four bedrooms, all of which can comfortably accommodate a double bed and additional furnishings. The primary bedroom benefits from fitted wardrobes, a stylish en-suite with shower, W.C. and hand basin, as well as beautiful exposed beams adding character to the space. Bedroom two also features its own en-suite shower room, whilst bedroom three offers built-in sliding door wardrobes. Completing the accommodation is a well-appointed family bathroom comprising a bathtub, separate shower, hand basin and W.C.

Externally, the property boasts a large private garden, mainly laid to lawn with a generous patio area, ideal for outdoor seating and entertaining. The home further benefits from a private driveway, providing off-street parking, as well as a large stone detached double garage with electric doors.



PLEASE NOTE THAT THE VENDOR HAS CERTIFIED THE PROPERTY INFORMATION AND IMAGES.

PROPERTY FLOORPLAN

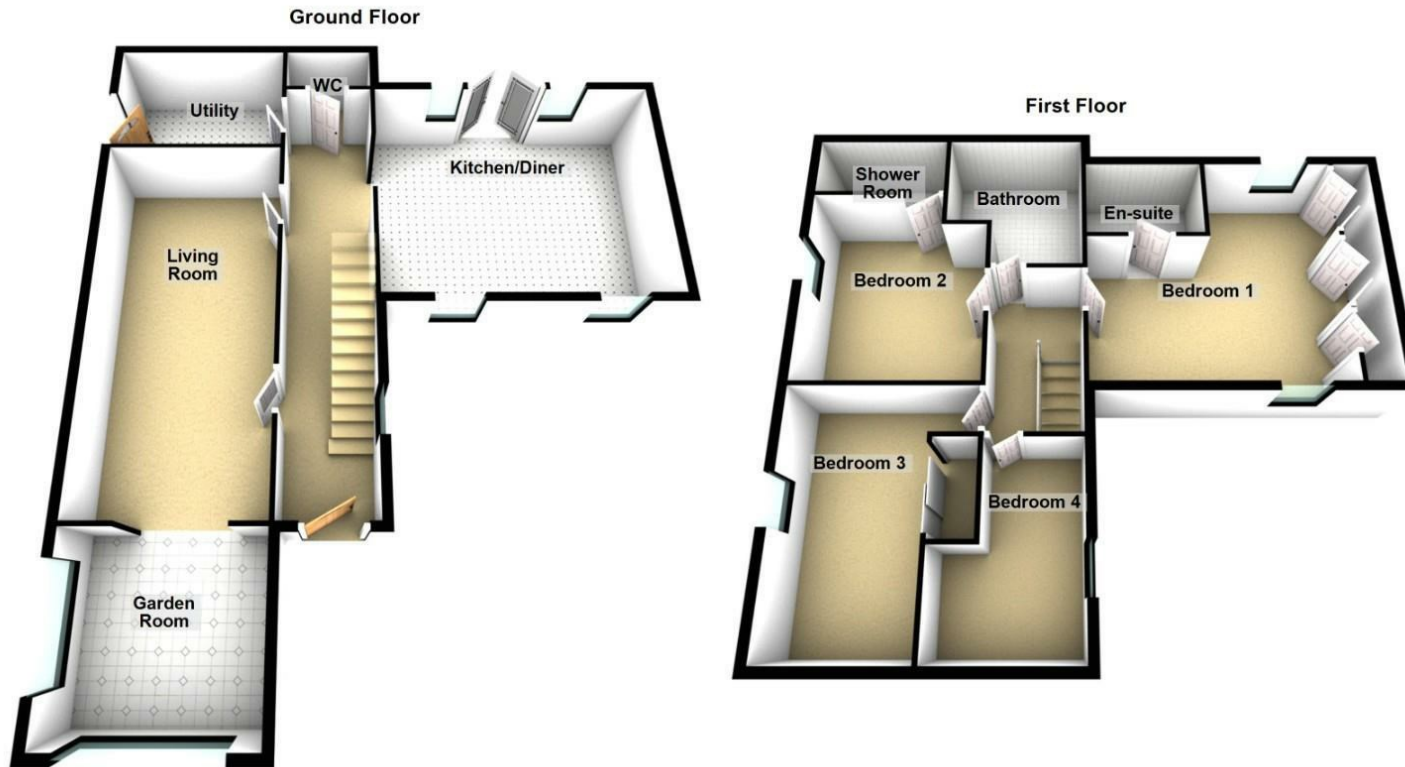

Total area: approx. 191.0 sq. metres (2056.0 sq. feet)

Measurements:

Living Room
25'10" x 11'10"

Garden Room
11'3" x 11'10"

Kitchen / Diner
16'6" x 19'8"

Utility
8'4" x 11'9"

W.C
3'4" x 6'0"

Bedroom One
16'2" x 16'11"

En-Suite
5'6" x 7'11"

Bedroom Two
13'8" x 11'10"

Shower Room
8'5" x 4'1"

Bedroom Three
16'1" x 11'10"

Bedroom Four
12'9" x 9'1"

Bathroom
9'9" x 9'3"

Energy Efficiency Rating		
	Current	Potential
Very energy efficient - lower running costs		
(92 plus) A		
(81-91) B		
(69-80) C	69	73
(55-68) D		
(39-54) E		
(21-38) F		
(1-20) G		
Not energy efficient - higher running costs		
England & Wales	EU Directive 2002/91/EC 	





More 5 Star Customer Reviews than any other Agent based in the North East on allAgents.co.uk



SALES

LETTINGS

FINANCE

LAW

WE COVER THE WHOLE OF THE NORTH EAST

Whitley Bay
0191 251 3344

Cramlington
01670 897 213

Tynemouth
0191 296 6689

Morpeth
01670 513 966

Ponteland
01661 820 082

Wallsend
0191 432 4151

Alnwick
01665 511 800

Heaton
0191 432 4275

Forest Hall
0191 266 9966

Other locations
0191 640 3523

Newcastle
0191 640 2284

Durham
0191 303 8252

Gosforth
0191 640 3523

Sunderland
0191 543 6390

Whickham
0191 432 5102

Gateshead
0191 432 4294

Jesmond
0191 281 1037

Killingworth
0191 640 3602

Ryton
0191 413 9845

Head Office &
Lettings
0191 253 4815

*Highest recommended 5-star reviews than any other Estate Agent based in the North East on allAgents.co.uk - The UK's Largest Customer Review Website for the Property Industry & Awarded Best Estate Agency 2018 & 2019 - North East England by SME News