



****AVAILABLE JULY 2026****

****UNFURNISHED**** A fantastic family home, this mid terraced house is found on Lyndhurst Avenue, Jesmond. Set over two floors and boasting both period charm and modern fixtures & fittings, with spacious rooms throughout and very conveniently located, a superb property not to be missed!

Only a stone's throw from West Jesmond Metro station, the property briefly comprises; an entrance porch through to entrance hall; lounge to the front with bay window; separate dining room with feature fireplace; modern fitted kitchen with appliances, tiled flooring and spotlights; separate utility to the rear with ground floor WC and access to rear yard. The first floor has three bedrooms, two large doubles and a smaller third; a separate study with fitted storage; family bathroom and separate WC. Externally there is a private yard to the rear and on street permit parking to the front.

The property is available on an unfurnished basis and would be make an ideal home for a family.

Please Note: This property can lawfully only be let to either a family or maximum of two individual sharers.

Available 17th July 2026 | £1,600pcm | Victorian Terraced House | 1,383 Sq. ft (128.5 m²) | Well Presented Throughout | Three Bedrooms | Study | Family Bathroom | Two Separate WC's | Lounge | Dining Room | Modern Kitchen | Utility | Private Rear Yard | On Street Permit Parking | Unfurnished | GCH & DG | Council Tax Band: D | EPC Rating: D

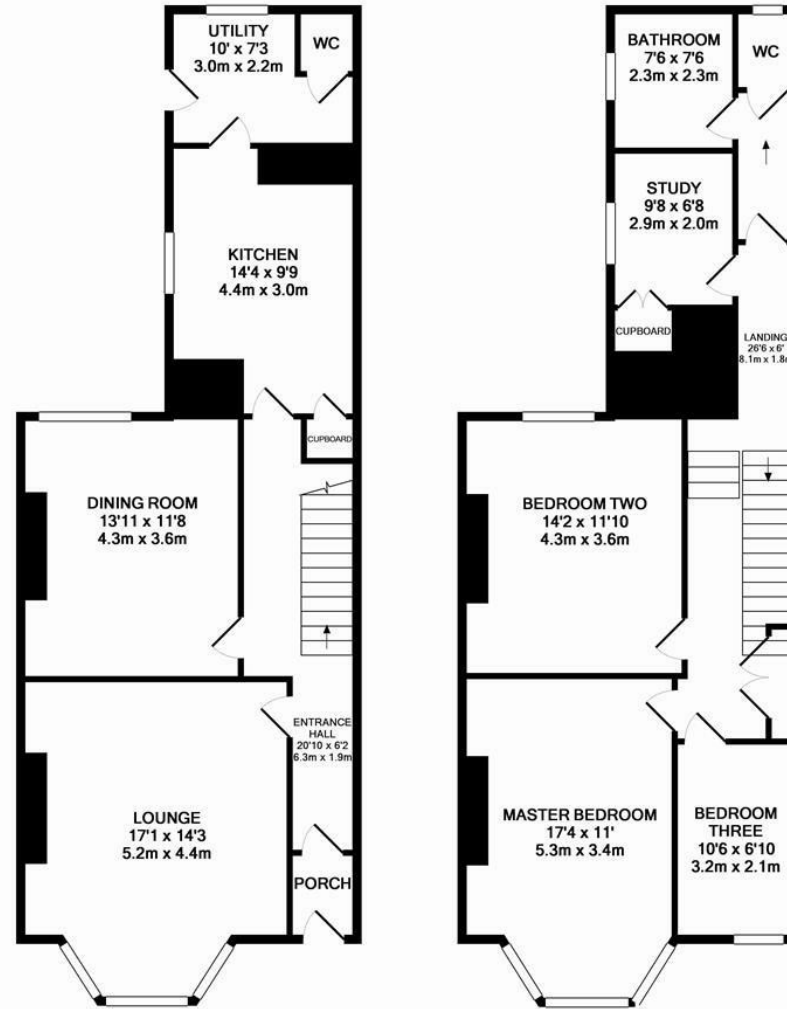

GROUND FLOOR
APPROX. FLOOR
AREA 696 SQ.FT.
(64.6 SQ.M.)

1ST FLOOR
APPROX. FLOOR
AREA 687 SQ.FT.
(63.9 SQ.M.)

TOTAL APPROX. FLOOR AREA 1383 SQ.FT. (128.5 SQ.M.)

Whilst every attempt has been made to ensure the accuracy of the floor plan contained here, measurements of doors, windows, rooms and any other items are approximate and no responsibility is taken for any error, omission, or mis-statement. This plan is for illustrative purposes only and should be used as such by any prospective purchaser. The services, systems and appliances shown have not been tested and no guarantee as to their operability or efficiency can be given
Made with Metropix ©2016



£1,600 PCM

IMPORTANT NOTE: These particulars and the descriptions and measurements herein do not constitute representation and whilst every effort has been made to ensure accuracy, this cannot be guaranteed.

