



Simon Road, Hollywood, Birmingham, B47 5LH

Offers Over £400,000

 3  1  2



3-Bed Semi-Detached Home in Hollywood with Open-Plan Living, Conservatory and Office Space. Offered for sale with NO UPWARD CHAIN.

Key Features

- Three-bedroom Semi-detached family home
- Sought-after, peaceful Hollywood location
- Spacious lounge opening into a bright conservatory
- Formal dining room with bay window
- Well-appointed kitchen plus large office room
- Utility to the side
- Versatile bedroom sizes suitable for family or home office use
- Excellent transport links including local rail stations
- Private rear garden accessed via conservatory
- Close to reputable schools, shops, and green spaces

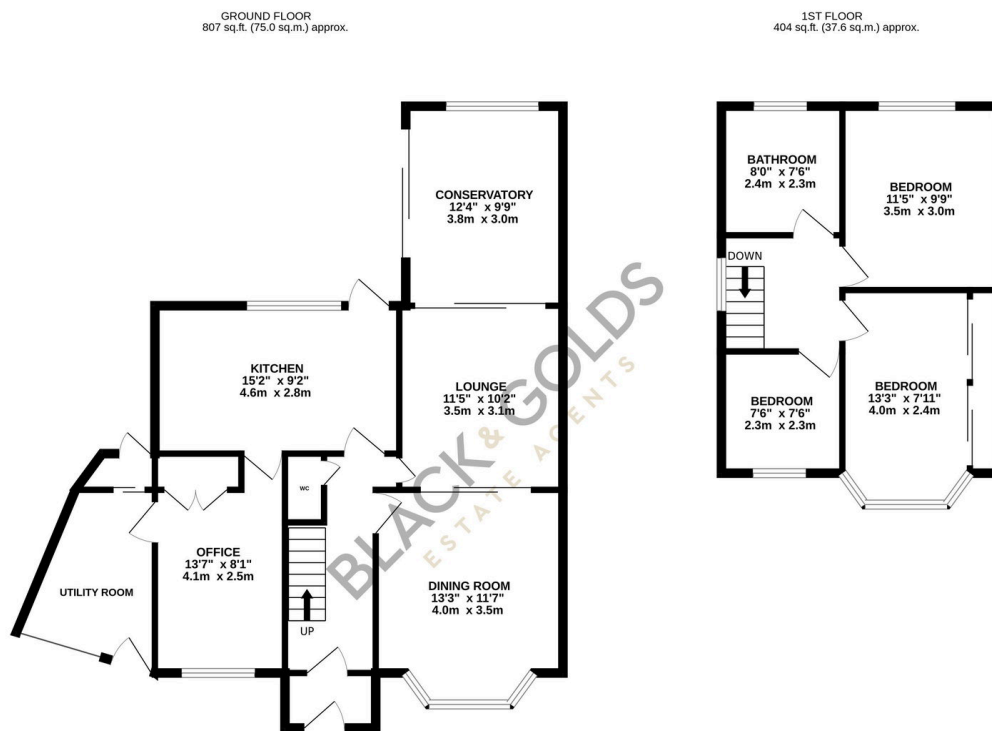

GROUND FLOOR
807 sq.ft. (75.0 sq.m.) approx.

1ST FLOOR
404 sq.ft. (37.6 sq.m.) approx.

TOTAL FLOOR AREA: 1211 sq.ft. (112.5 sq.m.) approx.

Whilst every attempt has been made to ensure the accuracy of the floorplan contained here, measurements of doors, windows, rooms and any other items are approximate and no responsibility is taken for any error, omission or mis-statement. This plan is for illustrative purposes only and should be used as such by any prospective purchaser. The services, systems and appliances shown have not been tested and no guarantee as to their operability or efficiency can be given.
Made with Metreplex ©2026