

HENDERSON CONNELLAN

ESTATE AGENTS



Carradale Close, Kettering, NN16

"Grounds for Excitement"

"Grounds for Excitement"

Discreetly positioned with an attractive outlook and a fabulous plot, this modern modern semi-detached home is conveniently located within easy reach of bus routes, the town centre, shops, schools and amenities. The well-presented interior benefits from gas central heating and UPVC double glazing to include an entrance hall, guest cloakroom, generous living room and a free flowing kitchen/breakfast room with integrated oven and hob with an adjoining conservatory which is a great size and offers a variety of uses. Upstairs there is a principal bathroom and three bedrooms, two of which are double sized, the main bedroom with fitted wardrobes. Outside the generous plot has a deep frontage with plenty of parking with an attractively presented for garden, the rear garden has been landscaped with lawned area, colourful plantings and a large decked area perfect for outdoor living. A very special home and plot.

Living Room - 4.8m x 4.42m (15'9" x 14'6")

Guest WC - 1.83m x 0.91m (6'0" x 3'0")

Kitchen/Breakfast Room - 4.42m x 2.44m (14'6" x 8'0")

Conservatory - 3.91m x 3.51m (12'10" x 11'6")

Bedroom One - 4.06m x 2.57m (13'4" x 8'5")

Bedroom Two - 3.25m x 2.59m (10'8" x 8'6")

Bedroom Three - 2.21m x 1.75m (7'3" x 5'9")

Bathroom - 1.83m x 1.83m (6'0" x 6'0")

- Gas Central Heating
- UPVC Double Glazing
- Lovely plot with deep frontage and landscaped garden
- Generous Living Room
- Kitchen/Dining Room leading to a large conservatory
- Three Bedrooms
- EPC RATING: C
- COUNCIL TAX: C
- Tenure: Freehold





Ground Floor

Approx. 49.8 sq. metres (536.2 sq. feet)

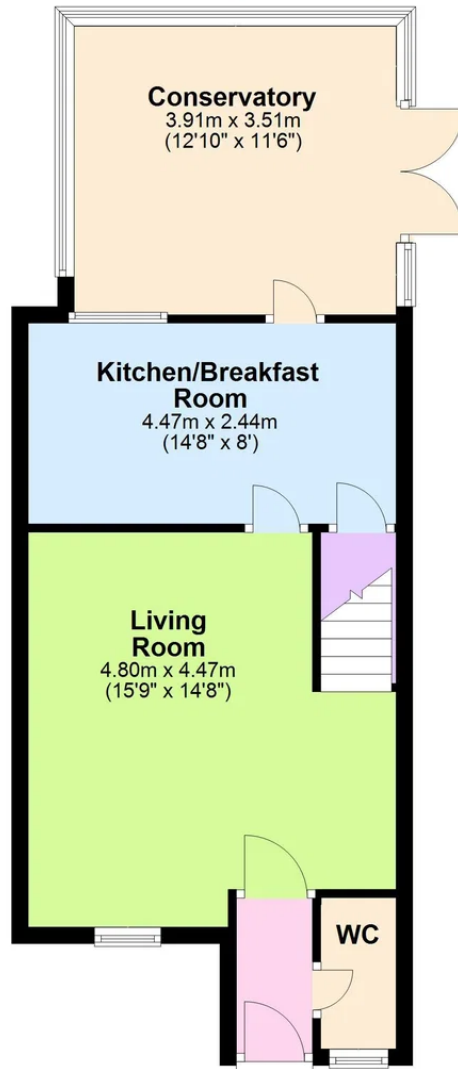

First Floor

Approx. 35.2 sq. metres (379.4 sq. feet)

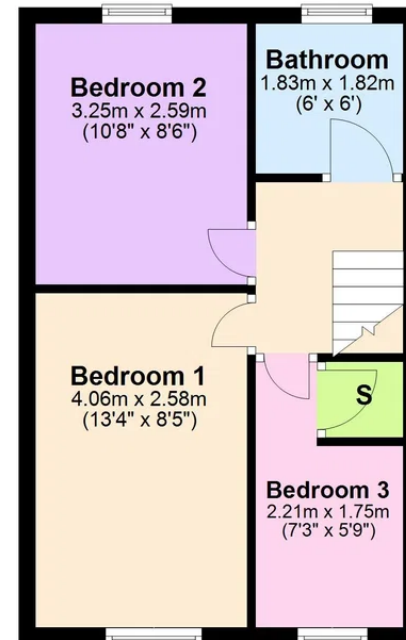

Total area: approx. 85.1 sq. metres (915.6 sq. feet)



Henderson Connellan Kettering office 01536 417888 ketteringsales@hendersonconnellan.co.uk

Disclaimer: These particulars do not form part of any offer or contract and should not be relied upon as statements or representations of fact. Any areas, measurements of distances are approximate. The text, photographs and plans are for guidance only and are not necessarily comprehensive.

