



Clove Cottage Roman Road, Aldington

Offers in Region of £400,000

Skippers

Clove Cottage Roman Road

Aldington, Ashford

Modern 3-bed end terrace in Aldington. Lounge opens to south-facing garden, kitchen/diner, en-suite, garage, parking. No chain. Close to amenities, schools, and transport.

Council Tax band: D

Tenure: Freehold

- NO ONWARD CHAIN
- Attractive End of Terraced Cottage Constructed in 2005
- Three Bedrooms
- Garage with additional Allocated Parking Spaces
- Family Bathroom in Addition to En-suite and Ground Floor Cloakroom
- Modern Fitted Kitchen/Diner
- Lounge with Doors Leading to Rear Garden
- Pleasant Gardens (South Facing to Rear)
- Sought-after village location in Aldington
- Good Convenience to Amenities



Hallway

Wooden door to the front, stairs to the first floor with under-stairs storage cupboard, doors to kitchen/diner, cloakroom and lounge

Cloakroom

Comprising a WC, wash basin, extractor fan and radiator.

Kitchen/Diner

15' 10" x 8' 9" (4.83m x 2.67m)

Good range of cupboards and drawers beneath work surfaces with additional wall mounted units, space and plumbing for washing machine and dishwasher, stainless steel sink with mixer tap and drainer, gas hob with splash back and extractor fan over with low level oven. Inset spotlights with bay window to front.

Living Room

15' 6" x 12' 9" (4.72m x 3.89m)

Double doors to rear garden, radiator, feature brick fireplace with wood mantle and wood burner effect gas fire.





Landing

Doors leading to Bedrooms and Family Bathroom.
Airing cupboard, loft access and window to side.

Bedroom

15' 6" x 12' 7" (4.72m x 3.84m)

Window outlook to rear, radiator, range of built in fitted wardrobes.

En-suite

Low level wc, pedestal wash hand basin, fully tiled shower cubicle, extractor fan and partially tiled walls

Bedroom

10' 8" x 8' 11" (3.25m x 2.72m)

Window outlook to front and radiator.

Bedroom

10' 10" x 6' 3" (3.30m x 1.91m)

Window outlook to front, radiator, built in cupboard.

Family Bathroom

White suite comprising low level wc, pedestal wash hand basin, panelled bath with mixer tap and shower attachment, heated towel radiator, partially tiled walls.



Clove Cottage, TN25

Approximate Gross Internal Area = 84.5 sq m / 910 sq ft
Approximate Garage Internal Area = 15.5 sq m / 167 sq ft
Approximate Total Internal Area = 100 sq m / 1077 sq ft

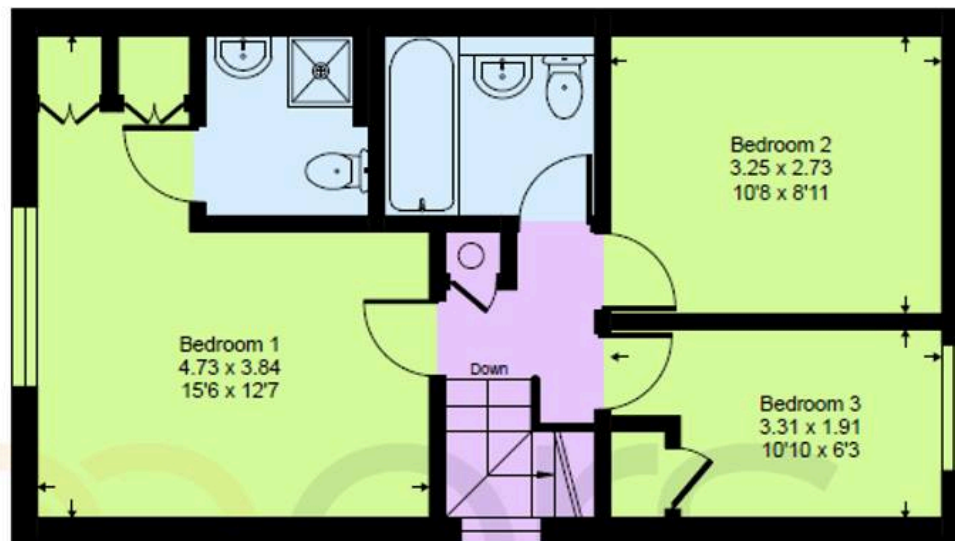

First Floor

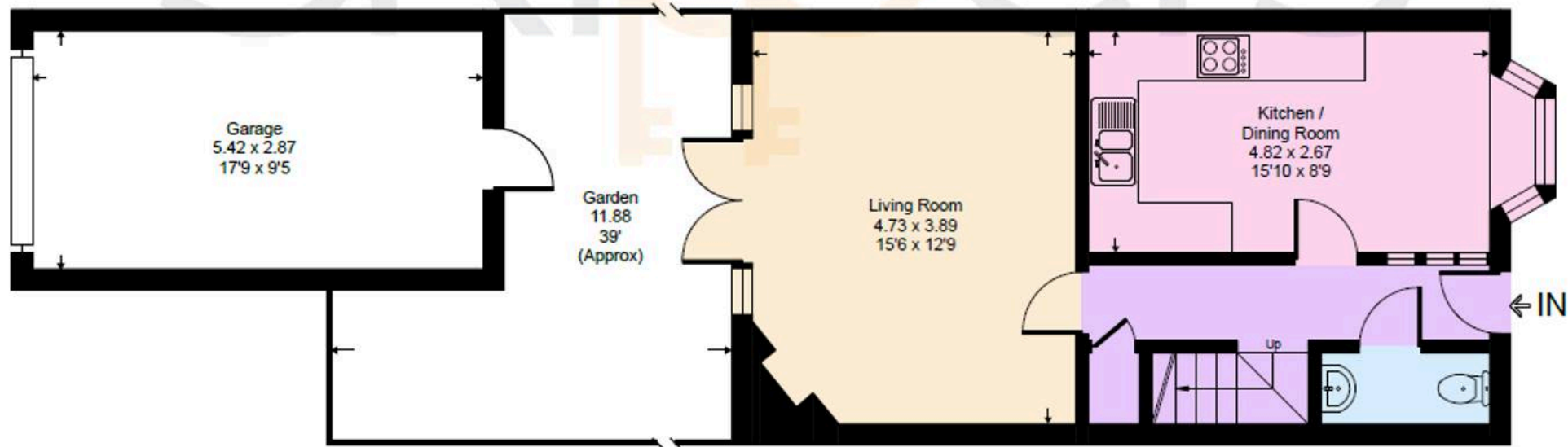

Ground Floor



Skippers Estate Agents – Ashford

5 Kings Parade High Street, Ashford – TN24 8TA

01233 632383

ashford@skippers-ea.co.uk

skippers-ea.co.uk



