



446a London Road, High Wycombe, Bucks, HP11 1LP

Asking Price | £1000

Property Description

A well-presented one-bedroom maisonette located on the east-side of High Wycombe, within close proximity to transport links and local shops. The property benefits from use of a private garden and further communal garden. The accommodation comprises; entrance; kitchen with a range of appliances; bathroom with separate shower cubicle and bath; living area and bedroom with storage. Available mid-July on a furnished basis.

COUNCIL TAX A

EPC RATING D

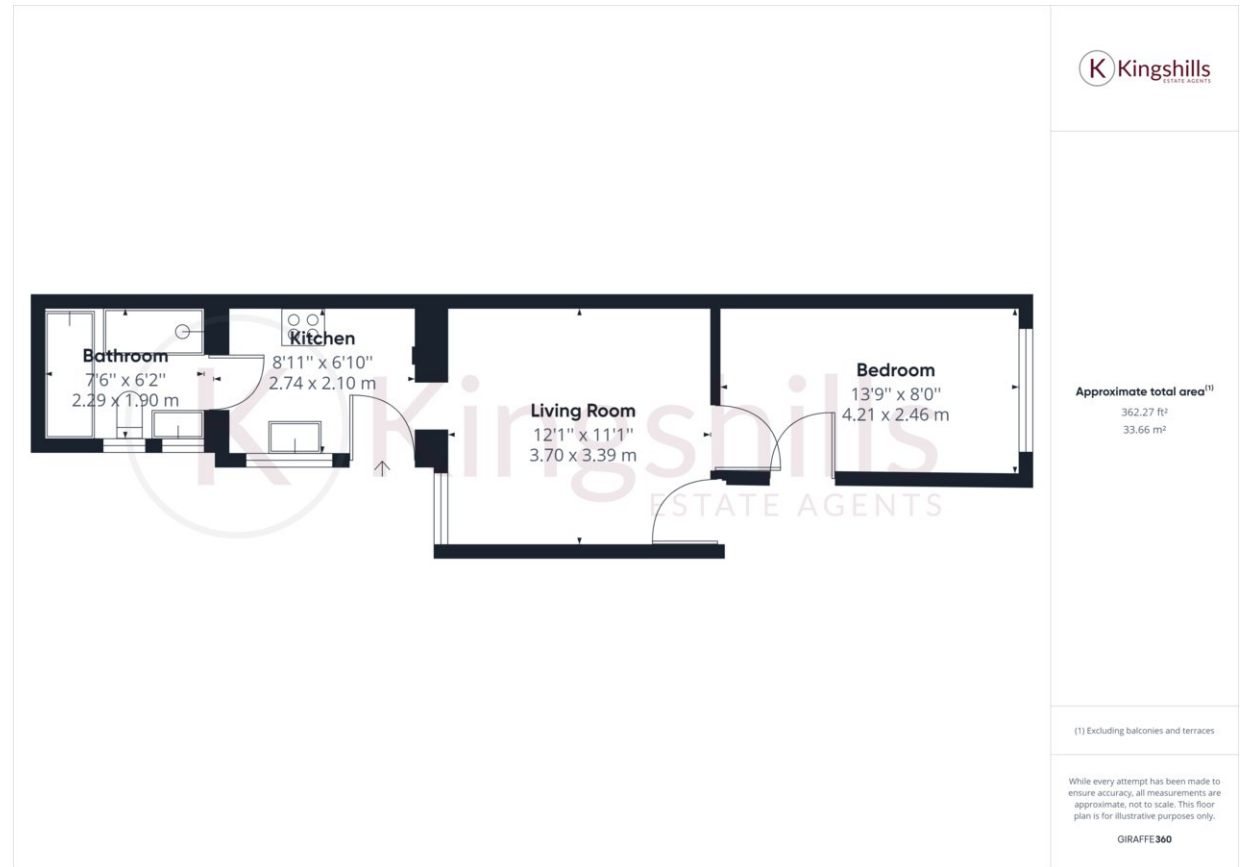

Kingshills Estate Agents
Comet Studios
Amersham
Buckinghamshire
HP7 0PX

01494 939868
hello@kingshills.co.uk
kingshills.co.uk

Agents Note: Whilst every care has been taken to prepare these particulars, they are for guidance purposes only. All measurements are for general guidance purposes only and whilst every care has been taken to ensure accuracy, they should not be relied upon and potential buyers/tenants are advised to recheck the measurements