

Butler's

thoughtful estate agency



Whitland Road, Carshalton, SM5 1QS
Guide price £550,000



Floor Plan

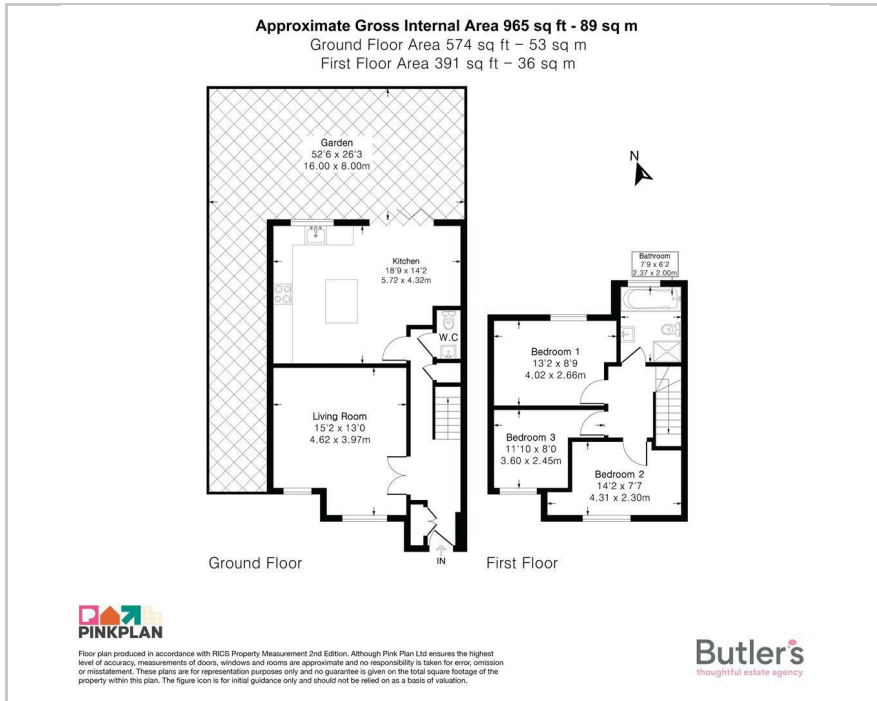

Area Map

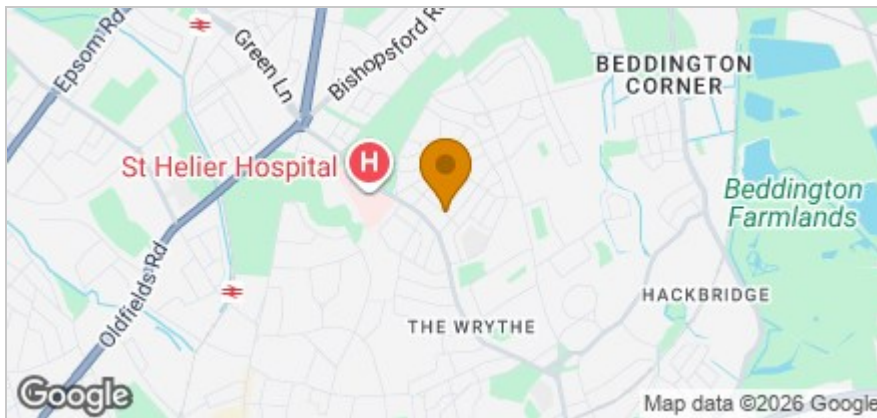

Accommodation

- Recently built 3 bedroom energy efficient home
- Stunning condition throughout
- Gorgeous kitchen/diner with bi-fold doors to garden
- Spacious lounge, perfect to entertain in
- Front & side driveway providing ample parking
- Luxuriously appointed bathroom & cloakroom
- Air-conditioning, air sourced heat pump, solar panels & build warranty remaining
- Landscaped level garden to rear
- Close to excellent schooling, transport links & amenities
- Well suited for a family with balanced bedrooms

Viewing

Please contact our Butler's Worcester Park Office on 020 39 069 169 if you wish to arrange a viewing appointment for this property or require further information.

Energy Efficiency Graph

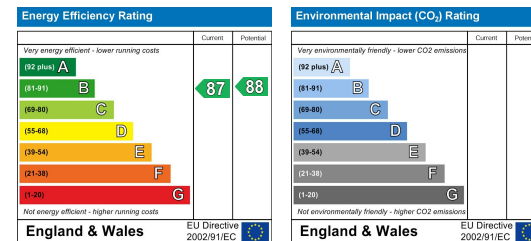

These particulars, whilst believed to be accurate are set out as a general outline only for guidance and do not constitute any part of an offer or contract. Intending purchasers should not rely on them as statements of representation of fact, but must satisfy themselves by inspection or otherwise as to their accuracy. No person in this firm's employment has the authority to make or give any representation or warranty in respect of the property.