

BEECHWOOD GROVE

CATTERICK GARRISON

LOVE PROPERTY.♥

LOVE THE JOURNEY



Welcome home...

Living on Beechwood Grove is a great option for couples, families and professionals alike. Everything you need is within easy reach, including schools, supermarkets, gyms, and a cinema. The nearby A1 provides quick access to surrounding areas, ideal for commuters or weekend trips.

Pull straight onto your driveway, with space for two cars right outside your front door—practical and well placed.

Head inside and immediately to your left is a handy WC that also serves as a cloakroom—ideal for storing coats, shoes, and everyday essentials out of sight.

To the right, the kitchen delivers a bright, functional space for both cooking and mealtimes. Thoughtfully designed with plenty of cupboard space and integral appliances including; an oven, hob, fridge/freezer, dishwasher and washing machine, it helps keep the space streamline and surfaces clear.

Toward the rear, the living room provides a comfortable, spacious area to relax. There's ample room for a large sofa and coffee table, while the patio doors open onto the garden and let in plenty of natural light.



Relax and Unwind

Upstairs, the main bedroom is generously sized, easily fitting a double bed and side tables, and comes with built-in wardrobes for streamlined storage.

A second double room and a flexible single complete the upstairs. Whether you need a guest room, home office, or nursery, there's space to suit your lifestyle. The family bathroom includes a bath with an overhead shower—great for both quick mornings and restful evenings.





Outside...

Outside, the garden is a private, sunny escape with a neat patio and lawn—perfect for enjoying warmer days or letting little ones play safely.

Finer Details...

Postcode: DL9 4WA

Freehold

Council tax band: C

EPC Rating: B

Gas central heating (Gas Safety Valid Until Jan 26)

Valid EICR until Oct 25

Driveway parking for 2 cars



Beechwood Grove Colburn

Total area: approx. 67.4 sq. metres (725.2 sq. feet)

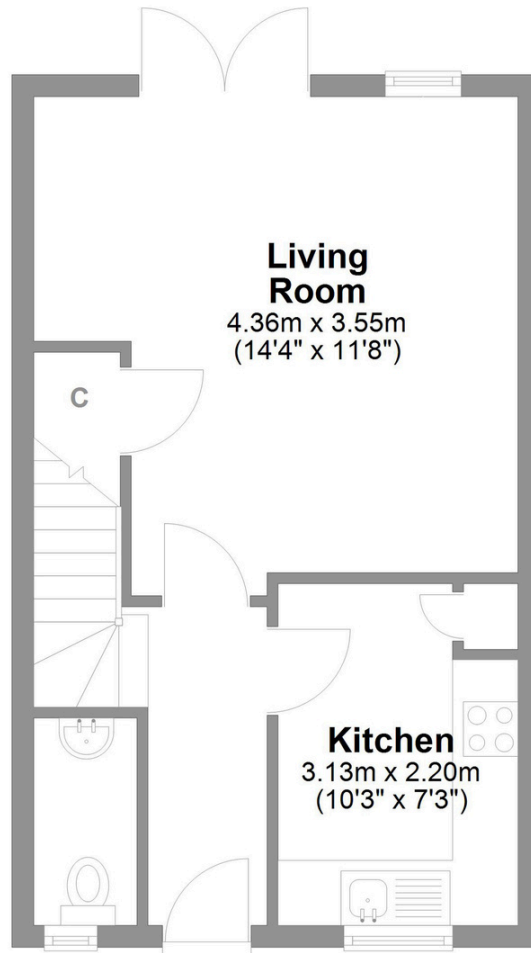

Ground Floor

Approx. 33.7 sq. metres (362.7 sq. feet)

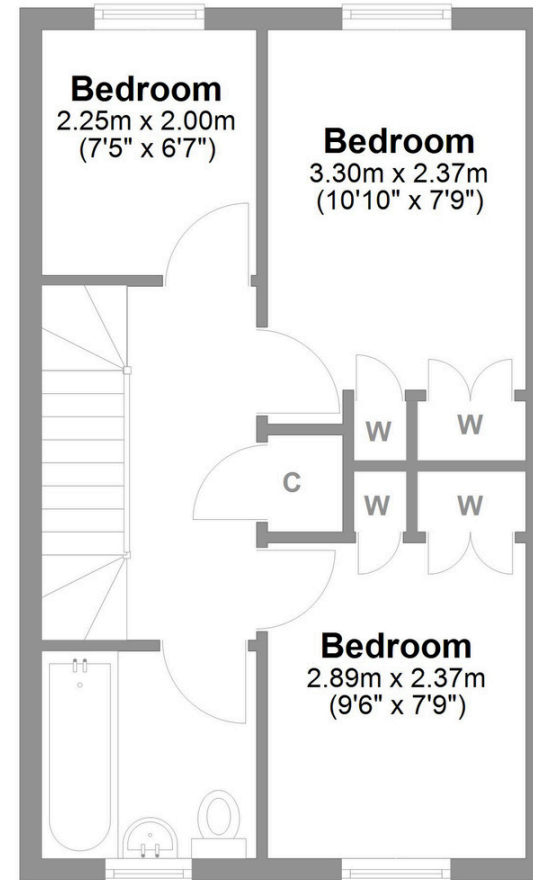

First Floor

Approx. 33.7 sq. metres (362.5 sq. feet)

LOVE PROPERTY

Whilst every attempt has been made to ensure the accuracy of the floorplans contained here, measurements of doors, windows, rooms and any other items are approximate and no responsibility is taken for any error, omission or mis-statement. This plan is not drawn to scale and is for illustrative purposes only & should be used as such by any prospective purchaser.
Created especially for Love Property by Vue3sixty Ltd