



**1 Bed
House - Mid Terrace
located in**



Room 4, 7 Forest Road Fishponds BS16 3XH



£750 Per month

Large En suite Room ! £750 All Bills Included

We are pleased to present this premium six-bedroom home designed for professionals only. Designed with comfort and ease in mind. The room comes fully furnished with Bed, Wardrobe, Chest of Drawers and Desk, along with plenty of storage space!

Located just 0.4 miles from the main bus routes, with the city centre and all other major routes within easy reach, this house is perfectly placed. Fishponds High Street, with its mix of shops, supermarkets, bars, and eateries, is only a short walk away.

All rooms in the house have their own bathrooms so there is no morning rush to get ready for work! The house also benefits from a large garden with furniture, perfect for a sunny afternoon !

Key Features
Six bedrooms
All with ensuite bathrooms
Premium finish
Excellent Fishponds location
Major Bus Routes 0.2 miles away
Close to shops, cafes, and eateries



GROUND FLOOR
535 sq.ft. (49.7 sq.m.) approx.

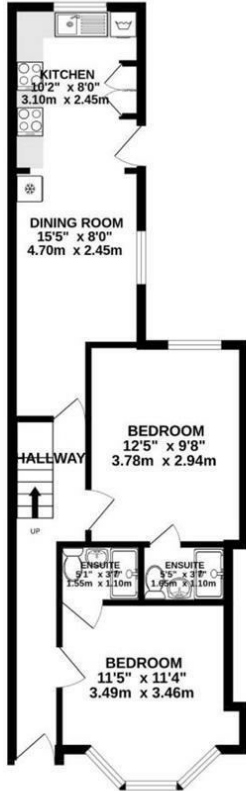

1ST FLOOR
452 sq.ft. (42.0 sq.m.) approx.



2ND FLOOR
291 sq.ft. (27.1 sq.m.) approx.

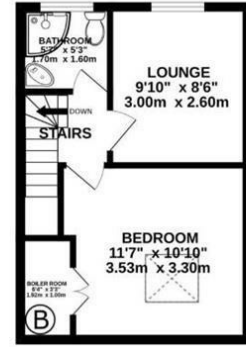

TOTAL FLOOR AREA: 1279 sq.ft. (118.8 sq.m.) approx.

Energy Efficiency Rating		Current	Potential
<i>Very energy efficient - lower running costs</i>			
(92 plus) A			
(81-91) B			
(69-80) C		77	
(55-68) D			
(39-54) E			
(21-38) F			
(1-20) G			
<i>Not energy efficient - higher running costs</i>			
England & Wales		EU Directive 2002/91/EC	

DIRECTIONS

CONTACT

Shore House Westbury Hill
Westbury-on Trym, Bristol
BS9 3AA

E: elliott.sherwood@frontdoorlettings.co.uk

T: 0117 457 8577

frontdoorlettings.co.uk

