

Carnarvon Close , Southend-On-Sea SS2 6FN

- 40% shared ownership option
- Modern two-bedroom flat
- Spacious open-plan living
- Close to Southend town centre
- Great condition throughout
- Buy 100% for £265,000
- Ground floor with patio
- Allocated parking included
- Near Southend Prittlewell station
- Viewing highly recommended

Guide Price £106,000 Leasehold



Location

Hallway

Open plan kitchen/living area

19'2 x 18'0

Bedroom 1

12'8 x 10'7

Bedroom 2

15'8 x 8'6

Bathroom

Patio

Allocated parking

Tenure

Lease remaining - 116 years

628,87 for rent and service charge per month.





Local Authority
Council Tax Band C
EPC Rating B

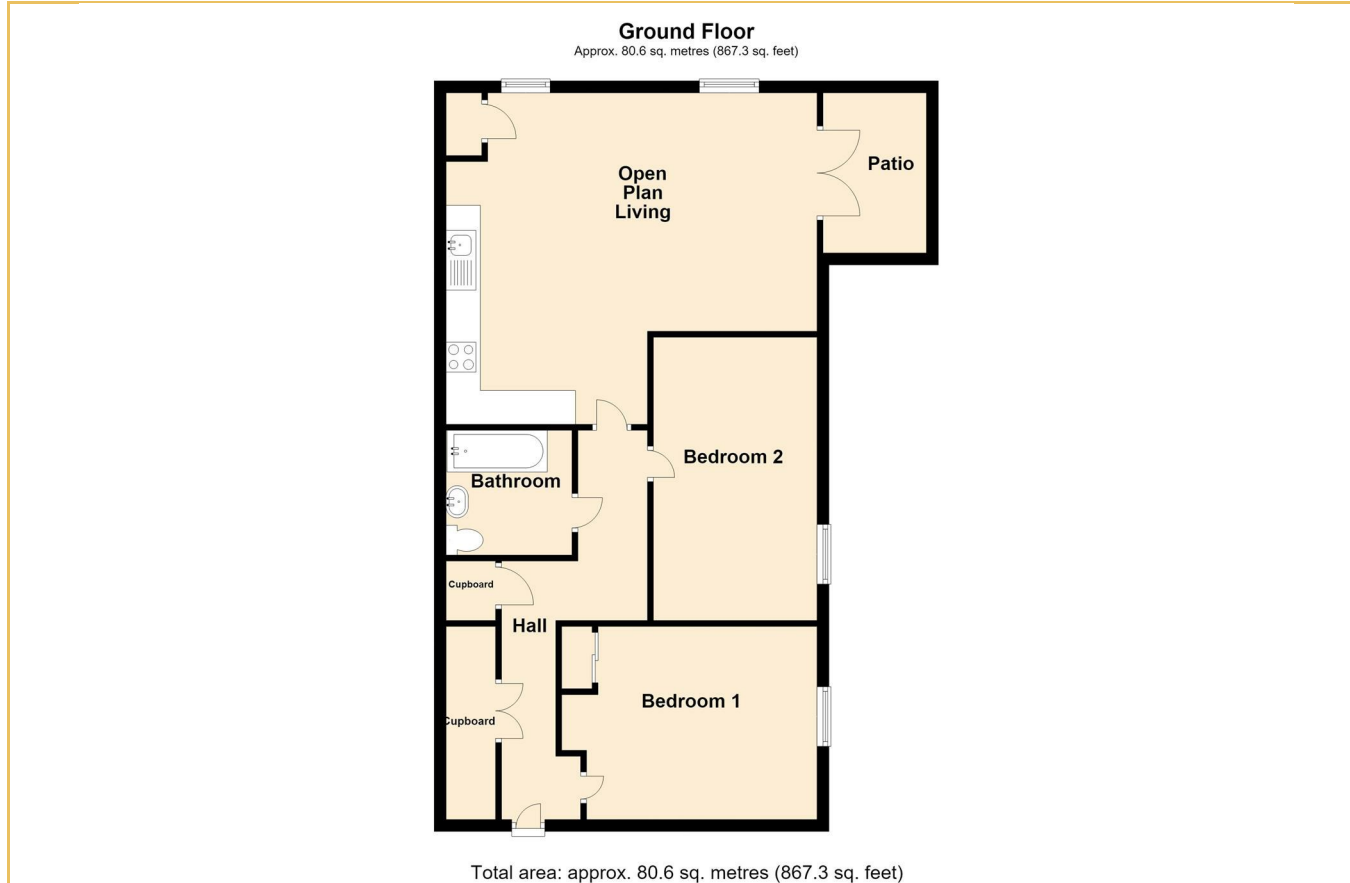

Sales Office
190 London Road
Southend-On-Sea
Essex
SS1 1PJ

Contact
01702 34 11 77
<https://hairandson.co.uk/>

Agents Note: Whilst every care has been taken to prepare these particulars, they are for guidance purposes only. All measurements are approximate and for general guidance purposes only and whilst every care has been taken to ensure accuracy, they should not be relied upon and potential buyers/tenants are advised to recheck the measurements.

