



## Jardine Road, E1W

£2,250 Per month



- Modern One Bedroom
- Gated Development
- Balcony
- Parking
- Direct River Views
- Limehouse



Larger than average one bedroom apartment with stunning river views, on the 2nd floor of this gated development conveniently located close to Wapping and Limehouse. This bright apartment comprises of a large reception with double doors leading on a South facing balcony overlooking the river Thames, a fully fitted Kitchen, a modern bathroom and a good size bedroom with fitted wardrobe.

Mauretania Building is ideally located only a few minutes' walk from Limehouse Marina, the Thames Path and Ropemakers Field Park. Conveniently located close to Canary Wharf and Wapping, and with easy access to the City. Close to the Cycle Super Highway and multiple transport links to include Limehouse station providing an easy access to Canary Wharf and The City along with the C2C service to Fenchurch Street.



## Jardine Road, London, E1W

Gross internal floor area (approx):

51 sq m / 550 sq ft

For Identification only - Not to scale

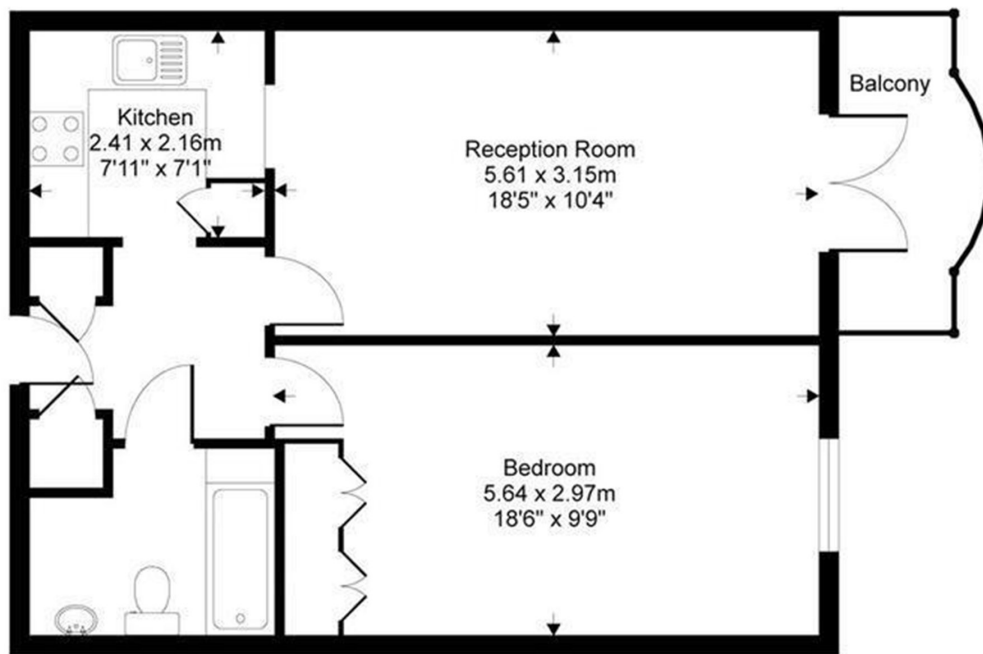

Third floor

35A Wapping High Street,  
London, E1W 1NR  
020 7702 3456  
ea2group.com