



**Connells**

Hanns Mews Hanns Way  
Eastleigh



### Property Description

A well-maintained and conveniently located one-bedroom first-floor apartment, situated just moments from Eastleigh town centre.

The property features a modern open-plan kitchen and lounge area, with the kitchen benefiting from a breakfast bar and integral oven-perfect for both everyday living and entertaining. The lounge is presented in clean, and modern décor, creating a bright and welcoming space.

There is a good-sized double bedroom and a well-kept bathroom, completing the internal accommodation.

Offered with no forward chain, this property is ideal for first-time buyers, investors, or those looking to downsize.

Its prime location provides easy access to local amenities, transport links, and the vibrant town centre, making it a fantastic opportunity not to be missed.

### Entrance Hall

Intercom

### Open Plan Kitchen Lounge

Double glazed window to front aspect. Open plan Kitchen and lounge. Fitted kitchen with wall and base units. Integrated Oven and gas hob. Integrated fridge freezer. Breakfast bar. Radiator. TV port.

## Bedroom

Double glazed window to rear aspect. Boiler cupboard. Radiator.

## Bathroom

Wash hand basin. Toilet. Heated towel rail. Shower over bath. Extractor fan. Fully tiled.



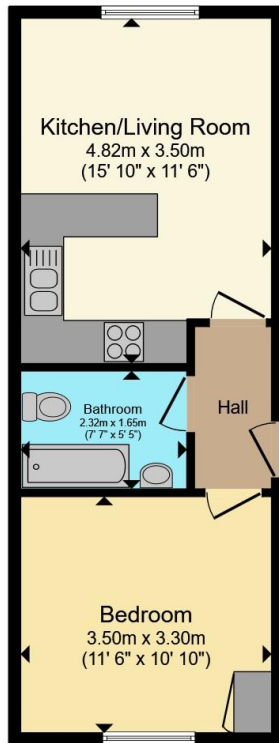

Total floor area 34.9 m<sup>2</sup> (376 sq.ft.) approx

This floor plan is for illustrative purposes only. It is not drawn to scale. Any measurements, floor areas (including any total floor area), openings and orientation are approximate. No details are guaranteed, they cannot be relied upon for any purpose and they do not form part of any agreement. No liability is taken for any error, omission or misstatement. A party must rely upon its own inspection(s). Powered by [www.propertybox.io](http://www.propertybox.io)

**Connells**

To view this property please contact Connells on

**T 02380 618 343**  
**E [eastleigh@connells.co.uk](mailto:eastleigh@connells.co.uk)**

19 Market Street  
EASTLEIGH SO50 5RH

EPC Rating: B Council Tax  
Band: A

Service Charge: 800.00 Ground Rent:  
35.00

Tenure: Leasehold

**view this property online [connells.co.uk/Property/EGH309607](http://connells.co.uk/Property/EGH309607)**

This is a Leasehold property with details as follows; Term of Lease 125 years from 01 Oct 2006. Should you require further information please contact the branch. Please Note additional fees could be incurred for items such as Leasehold packs.



1. MONEY LAUNDERING REGULATIONS Intending purchasers will be asked to produce identification documentation at a later stage and we would ask for your co-operation in order that there will be no delay in agreeing the sale. 2. These particulars do not constitute part or all of an offer or contract. 3. The measurements indicated are supplied for guidance only and as such must be considered incorrect. Potential buyers are advised to recheck measurements before committing to any expense. 4. We have not tested any apparatus, equipment, fixtures, fittings or services and it is in the buyers interest to check the working condition of any appliances.

Connells Residential is registered in England and Wales under company number 1489613, Registered Office is Cumbria House, 16-20 Hockliffe Street, Leighton Buzzard, Bedfordshire, LU7 1GN. VAT Registration Number is 500 2481 05.

**See all our properties at [www.connells.co.uk](http://www.connells.co.uk) | [www.rightmove.co.uk](http://www.rightmove.co.uk) | [www.zoopla.co.uk](http://www.zoopla.co.uk)**

Property Ref: EGH309607 - 0003