



TO LET

Alfred Road, Feltham, TW13 5DQ
£1,700 Per Calendar Month

DBK
ESTATE AGENTS

- Available To Rent Immediately!
- Brand New Modern Kitchen
- Chic Bathroom Family bathroom/ WC
- Loft Storage
- Moments Walk From Feltham High Street
- Newly Refurbished First Floor Maisonette
- Two Sizeable Bedrooms
- Spacious Reception Room
- Rear Garden/ Street Parking Available
- Feltham Railway Station 0.5 Miles

GROUND FLOOR
497 sq.ft. (46.2 sq.m.) approx.

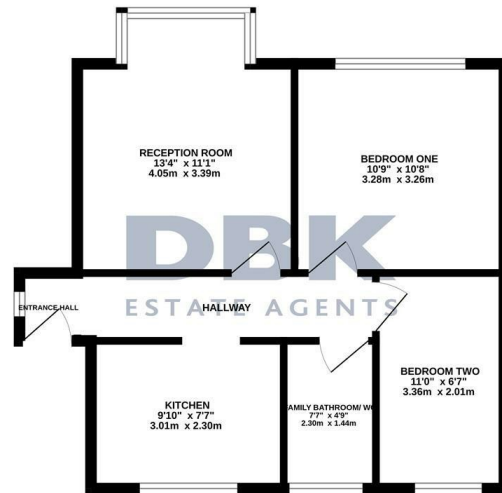

TOTAL FLOOR AREA: 497 sq.ft. (46.2 sq.m.) approx.

While every attempt has been made to ensure the accuracy of the floorplan contained here, measurements of floors, windows, doors and any other items are approximate and no responsibility is taken for any errors. Information is for information purposes only and should be used as a guide by the prospective purchaser. The services, systems and appliances shown here are not tested and no guarantee is given to their operability or efficiency can be given.
Made with Metronix C2025

THE PROPERTY

Available To Rent Immediately!

This newly refurbished first-floor maisonette offers stylish and comfortable living in a highly convenient location. Finished to a high standard throughout, the property is perfect for tenants seeking a modern home with generous space and excellent local amenities.

The accommodation features a spacious reception room, ideal for relaxing or entertaining, along with a brand new modern kitchen fitted with contemporary units and appliances. There are two sizeable bedrooms, both offering ample natural light and flexibility for families, couples, or professionals working from home. The chic family bathroom/WC has been thoughtfully designed with sleek, modern finishes.

Additional benefits include useful loft storage, private rear garden and street parking availability. Ideally situated just moments from Feltham High Street, residents can enjoy a variety of shops, cafés, and everyday conveniences right on their doorstep. Feltham Railway Station is approximately 0.5 miles away, providing excellent transport links for commuters.