



1 Rose Cottages, Lydford

Okehampton

Guide Price **£295,000**

1 Rose Cottages

Lydford, Okehampton

- Delightful Character Cottage with Many Character Features
- Extremely Desirable Village Location
- Close To and Easy Walking Access To Dartmoor
- Currently a successful Holiday Let
- Two Bedrooms
- Inglenook Fireplace with Cloam Oven and Woodburner
- Kitchen/Dining Room
- Courtyard Garden and Outside Store
- NO ONWARD CHAIN



TOTAL APPROX. FLOOR AREA 89.1 SQ.M. (959 SQ.FT.)

Whilst every attempt has been made to ensure the accuracy of the floor plan contained here, measurements of doors, windows, rooms and any other items are approximate and no responsibility is taken for any error, omission, or mis-statement. This plan is for illustrative purposes only and should be used as such by any prospective purchaser. The services, systems and appliances shown have not been tested and no guarantee as to their operability or efficiency can be given
Made with Metropix ©2018

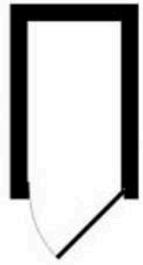

GARDEN STORE
APPROX. FLOOR
AREA 1.5 SQ.M.
(16 SQ.FT.)

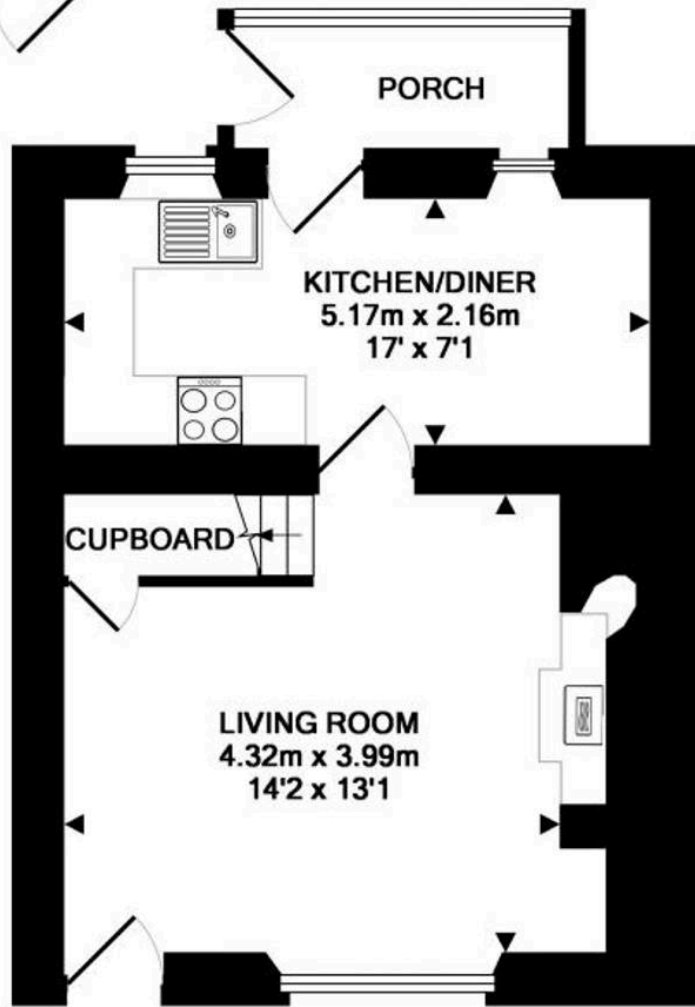

GROUND FLOOR
APPROX. FLOOR
AREA 45.8 SQ.M.
(493 SQ.FT.)

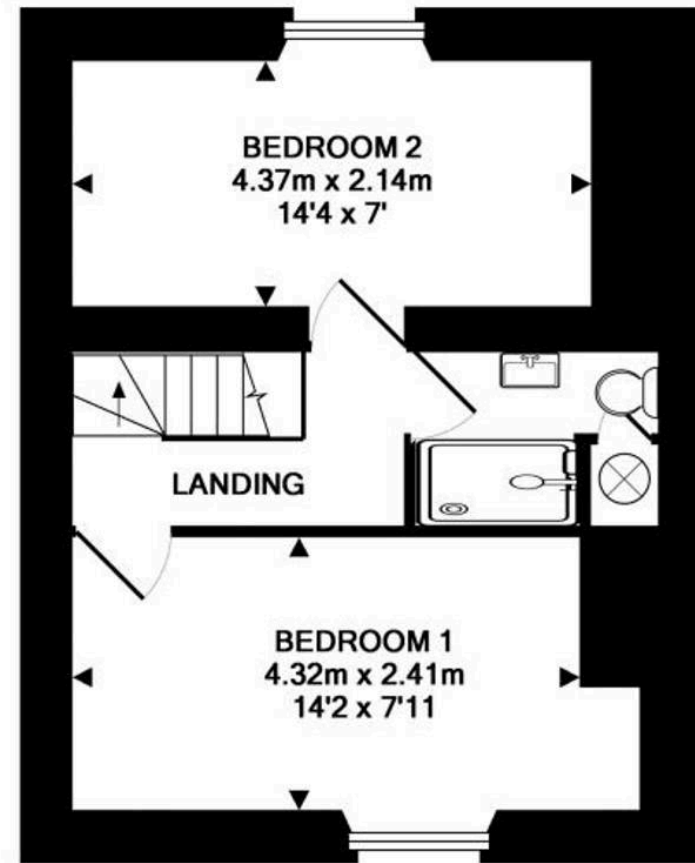

FIRST FLOOR
APPROX. FLOOR
AREA 41.8 SQ.M.
(450 SQ.FT.)



Mansbridge Balment

Mansbridge Balment, 4 Market Road, Tavistock - PL19 0BW

01822 612345

tavistock@mansbridgebalment.co.uk

www.mansbridgebalment.co.uk/

