



ISLINGTON PROPERTIES



## Carleton Road

Tufnell Park, N7

£1,900 Per Month

£2,192 Deposit

Available from: 30th July 2026

A lovely one-bedroom flat in a well-maintained, period development situated on an attractive tree-lined street within easy walking distance to Tufnell Park, Kentish Town (both Northern line) and Holloway Road (Piccadilly line) tube stations as well multiple bus routes on Camden Road.

- One Bedroom
- Period Elegance
- Separate Kitchen
- Communal Garden
- Near local amenities
- Excellent Transport Links
- Southerly aspect
- Council tax: C

### Viewing

Please contact our Upper Street Office on 020 7871 4444 if you wish to arrange a viewing appointment for this property or require further information.



## Additional Information

Heating: Gas Central Heating

Electricity Supply: Mains

Water Supply: Mains

Sewerage: Mains

Broadband Availability: Standard, Superfast, Ultrafast (Ofcom)

Mobile Signal: Predicted good coverage indoor and outdoor for Vodafone, O2, Three. Good outdoor, limited indoor for EE (Ofcom)

Parking: Unallocated first come, first serve parking behind development and street parking via permit from local council

## Floor Plan

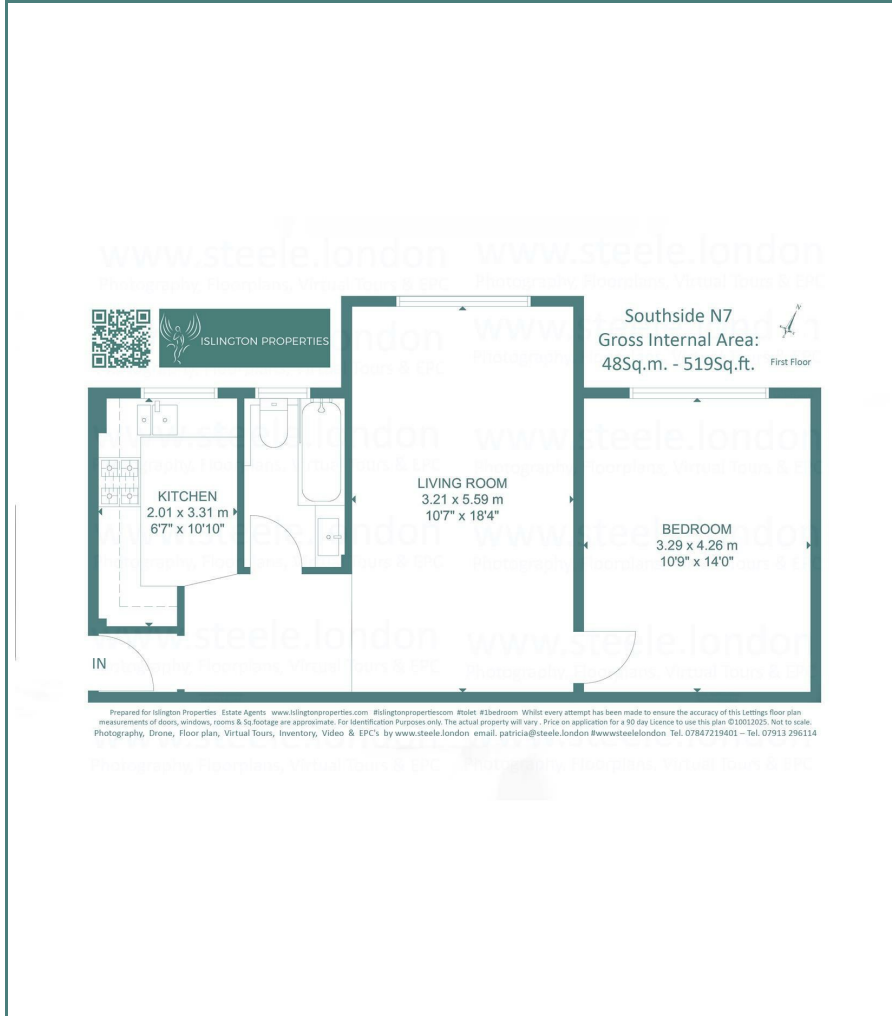

## Area Map



## Energy Efficiency Graph

### Energy Efficiency Rating

	Current	Potential
Very energy efficient - lower running costs		
(92 plus) <b>A</b>		
(81-91) <b>B</b>		
(69-80) <b>C</b>	73	80
(55-68) <b>D</b>		
(39-54) <b>E</b>		
(21-38) <b>F</b>		
(1-20) <b>G</b>		
Not energy efficient - higher running costs		
<b>England &amp; Wales</b>	EU Directive 2002/91/EC	



These particulars, whilst believed to be accurate are set out as a general outline only for guidance and do not constitute any part of an offer or contract. Intending purchasers should not rely on them as statements of representation of fact, but must satisfy themselves by inspection or otherwise as to their accuracy. No person in this firm's employment has the authority to make or give any representation or warranty in respect of the property. Council Tax and tenancy information should be confirmed with the Lettings Manager prior to the signature of the tenancy agreement.