



Alban House

Sumpter Close, NW3

£3,950 per month
(£911.54 per week)

VIDEO TOUR AVAILABLE. A spacious bright and airy 3 bedroom 1st floor apartment in this purpose built block with a lift, wood floors throughout, private balcony and underground parking (under separate negotiation). The property is situated moments' away from the shopping amenities and Underground links of Finchley Road (Jubilee & Metropolitan Lines). Accommodation comprises spacious reception room and dining area with direct access to the balcony, fully fitted eat in kitchen, master bedroom, 2 further bedrooms, family bathroom, guest cloakroom. Sole Agent.

CHESTERTONS



Alban House

Sumpter Close, NW3

- A Spacious Bright and Airy 1st Floor Apartment in Purpose Built Block
- 3 Bedrooms, 2 Bathrooms, Reception, Eat In Kitchen
- Lift, Wood Floors Throughout, Balcony
- Moments' Away from the Shopping Amenities and Underground Links of Finchley Road (Jubilee & Metropolitan Lines)



Deposit Required: £4,557.69
Local Authority: London Borough Of Camden
Council Tax Band: F
EPC Rating: C
Furnished

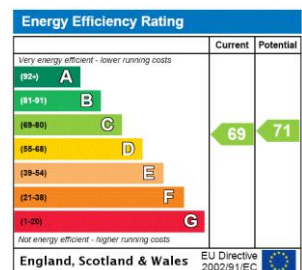

Chestertons Hampstead Lettings

55-56 Hampstead High Street
 Hampstead
 London
 NW3 1QH
hampsteadlettingsusers@chestertons.co.uk
 02077941125
chestertons.co.uk

Additional tenant charges apply (fees apply to non-AST tenancies only)
 Tenancy Agreement Fee: £300
 References per Tenant/Guarantor: £60
 Inventory check (approx. £100 – £250 inc. VAT)
chestertons.co.uk/property-to-rent/applicable-fees

Alban House, Sumpter Close, NW3

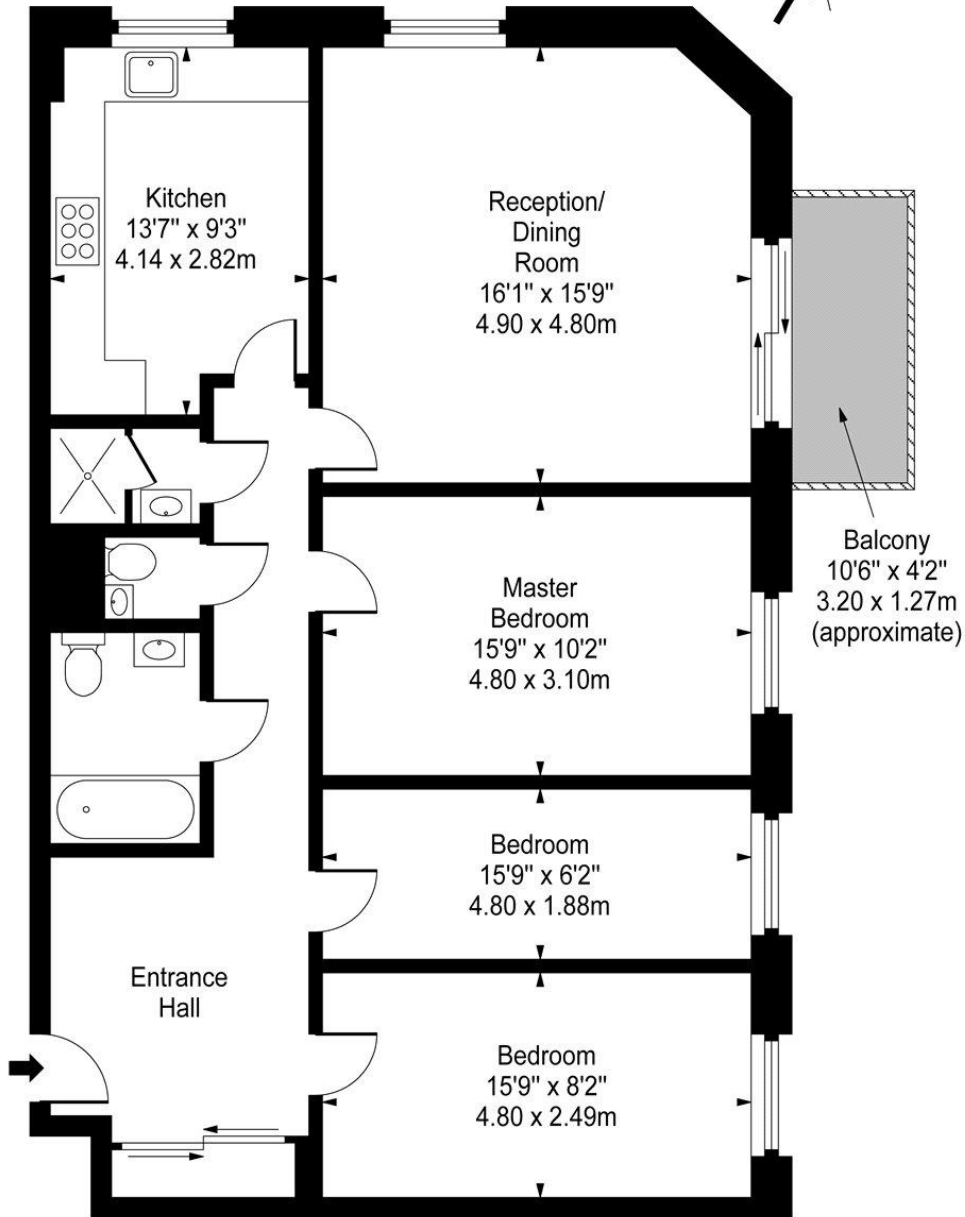
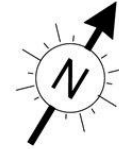

First Floor

Approx Gross Internal Area **1080 Sq Ft - 100.33 Sq M**

For Illustration Purposes Only - Not To Scale

www.goldlens.co.uk

Prepared for Chestertons

Ref. No. 007158K

