



Balls Chase, Halstead, Essex, CO9 1NY

Rent - £1,350 PCM Deposit - £1,557

SHIRES is delighted to present this delightful semi-detached house which offers a perfect blend of comfort and convenience. With three generously sized bedrooms, this property is ideal for families or those seeking extra space. The home has been newly redecorated, presenting a fresh and inviting atmosphere that is ready for you to move in and make your own.

One of the standout features of this property is the number of parking space, and the large garden. Situated close to the town centre, you will benefit from easy access to a variety of local amenities, including shops, schools, and

- 3 BEDROOM SEMI-DETACHED
- 2 DOUBLE BEDROOMS/ 1 SINGLE BEDROOM/BATHROOM
- 12 MONTH CONTRACT
- GAS HEATING
- PARKING FOR MULTIPLE CARS
- ENTRANCE HALL/LIVING ROOM/KITCHEN
- GARDEN/GARAGE/SHED
- COUNCIL TAX BAND C
- NEWLY REDECORATED
- CLOSE TO TOWN CENTRE



Council Tax Band: C - EPC Rating: E 53

GROUND FLOOR



1ST FLOOR

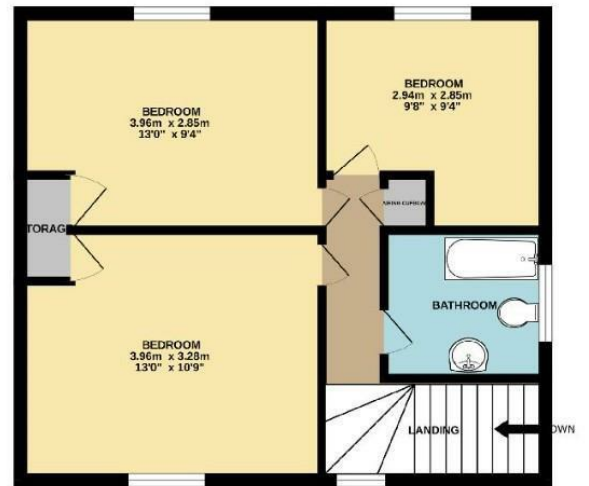

Whilst every attempt has been made to ensure the accuracy of the floorplan contained here, measurements of doors, windows, rooms and any other items are approximate and no responsibility is taken for any error, omission or mis-statement. This plan is for illustrative purposes only and should be used as such by any prospective purchaser. The services, systems and appliances shown have not been tested and no guarantee as to their operability or efficiency can be given.
Made with Metropix ©2026

