



23 Kay Avenue Weybridge Park Estate Addlestone Surrey KT15 2RF

£230,000



23 Kay Avenue 40'X14'

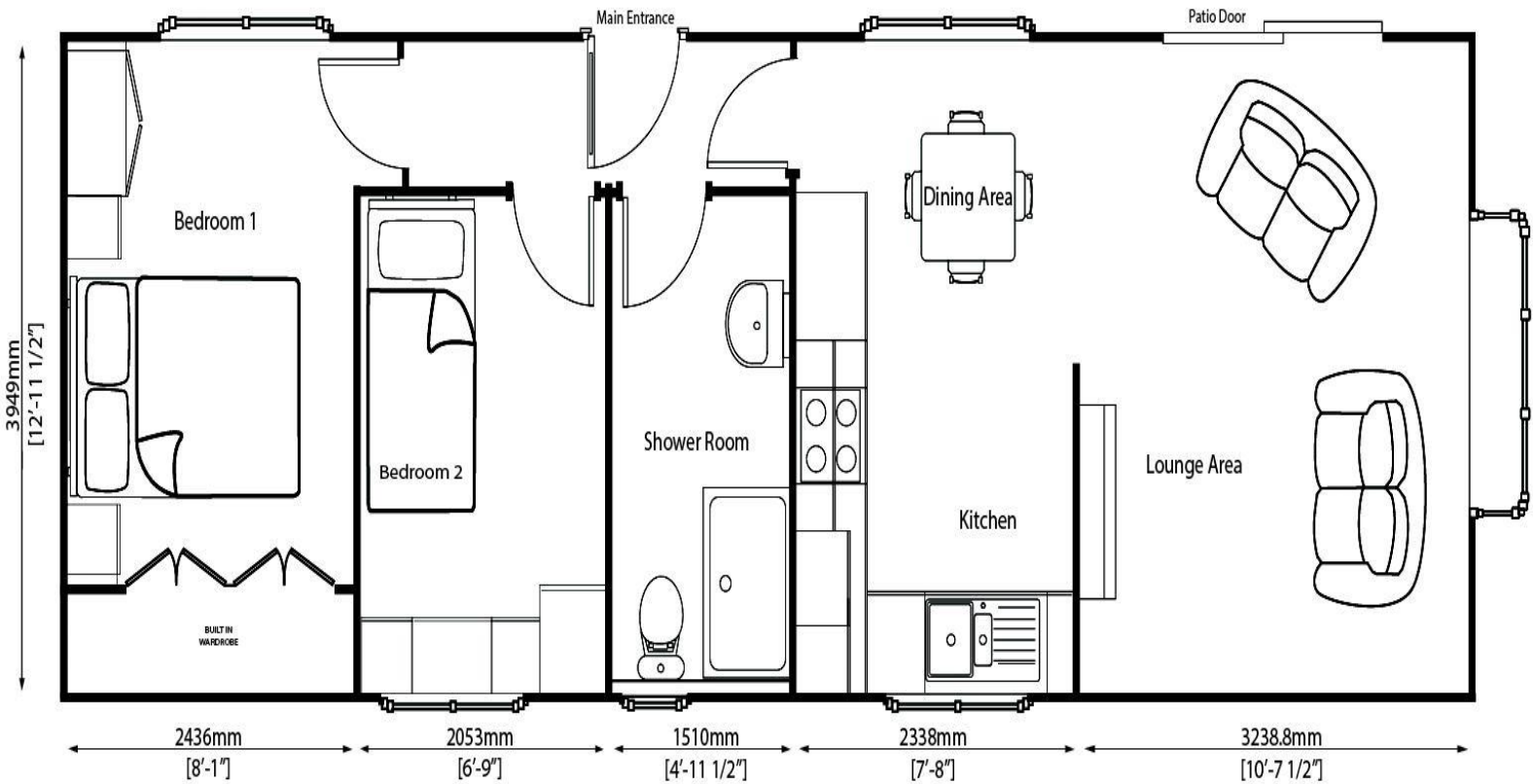

Explore this stunning Stately Albion Tredegar Elite, a home that blends traditional charm with modern convenience at an attractive price point. Located in the desirable Weybridge Park, this residence offers a thoughtful layout and quality finishes throughout. The welcoming living area is enhanced by a cosy feature fireplace and large patio doors that flood the room with natural light. This spacious, light-filled environment seamlessly connects indoor and outdoor spaces, perfect for both relaxation and entertaining. The heart of the home is a fully-fitted kitchen and dining area, complete with integrated appliances. The dining area with an attractive window is ideal for daily meals and keeps the main living areas organised. The home features two generously sized bedrooms designed for comfort and style. The master suite includes a comfortable double bed and practical fitted wardrobes. The second bedroom offers a single bed and fitted wardrobes. The well-appointed main bathroom features a full bath with a fitted shower, perfect for a quick refresh or a relaxing soak.



AGENTS NOTES: These details do not constitute any part of an offer or contract. In issuing them we do not have any authority to give any warranty or representation whatsoever in respect of this property. These details are provided without any responsibility on our part or the part of the vendors. No statements in these details are to be relied upon as representations of fact and purchasers should satisfy themselves by inspection or otherwise as to the accuracy of the statements contained therein.

Equipment: We have not tested the equipment or central heating system mentioned in these particulars and purchasers are advised to satisfy themselves as to their working order and condition.

Measurements: Great care is taken when measuring but measurements should not be relied upon for ordering carpets, equipment, etc.