

Westbourne Grove Terrace, W2

£519 Per week

A modern and spacious one bedroom apartment on the second floor of a period conversion with lift access, wood flooring and an open plan kitchen reception room.

Ideally located within the heart of Notting Hill on Westbourne Grove offering access to all local amenities and easy access to the Central Line at Notting Hill Gate.

Features

- One Double Bedroom
- Recently Refurbished
- Open Plan Reception
- Built in Storage
- Lift Access
- Modern Bathroom

Westbourne Grove Terrace, London, W2

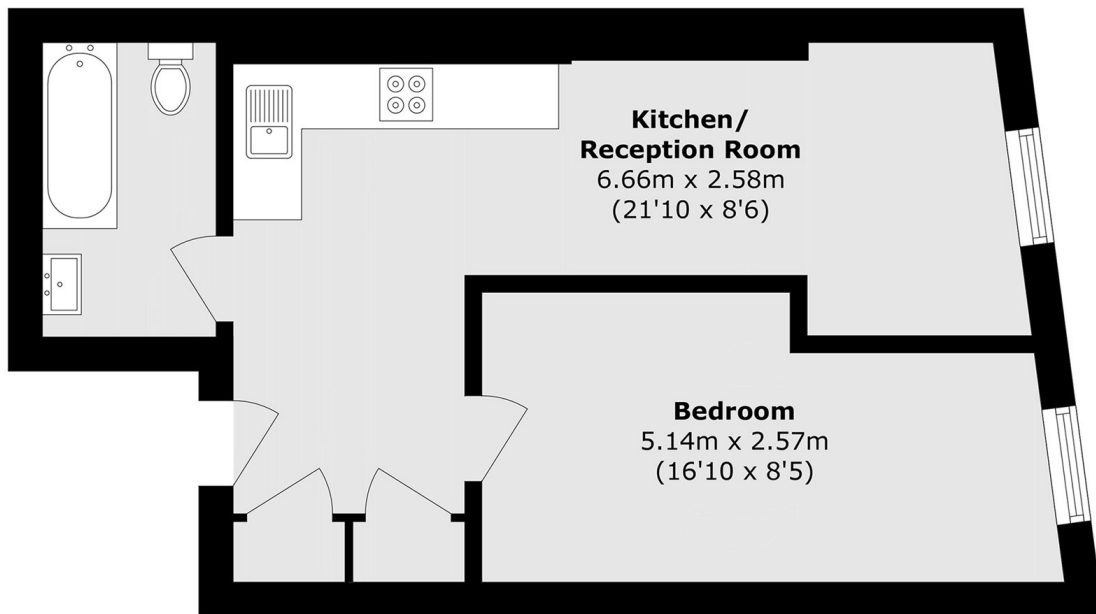

Second Floor

Total area (approx.): 37.5 sq. m (403.6 sq. ft)