



3



1



1



c

DavidJames
the estate agent

Beckhampton Road, Nottingham, NG5 5NG

£975 Per Calendar Month

About This Property

Situated in the popular and convenient location of Bestwood is this well-presented semi-detached property. The property is just a short walk from local amenities, reputable schools and the stunning Bestwood Country Park, making it perfect for those who enjoy both convenience and outdoor space. Internally, the property comprises a bright and spacious lounge/dining room, a modern fitted kitchen with integrated cooking appliances, and a versatile conservatory featuring French doors that open out to the garden. To the first floor are three bedrooms and a modern bathroom fitted with a contemporary three-piece white suite. Externally, the property benefits from an enclosed rear garden with a lawn, patio seating area and useful outbuilding for storage.

TENANCY DETAILS

Available From: Now

Tenancy Term: Minimum 6 months (12 months preferred)

Furnishing: Unfurnished

EPC Rating: C

Council Band: A

Pets: Not permitted

- Well-presented semi-detached home
- Bright and spacious lounge/dining room
- Versatile conservatory with French doors
- Modern fitted kitchen with integrated cooking appliances
- Three first floor bedrooms
- Modern bathroom with three-piece white suite
- Double glazing and gas central heating
- Enclosed rear garden with lawn, patio and outbuilding storage
- Short walk to local amenities, schools and Bestwood Country Park





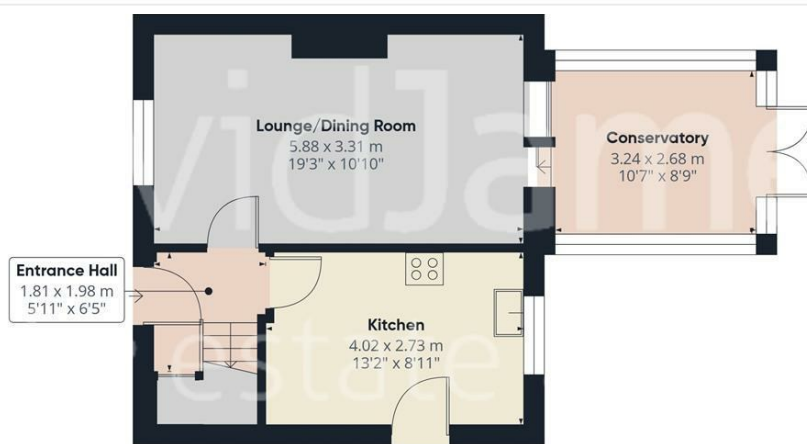

Floor 0



Floor 1



Approximate total area⁽¹⁾

76.4 m²
823 ft²

(1) Excluding balconies and terraces

Calculations reference the RICS IPMS 3C standard. Measurements are approximate and not to scale. This floor plan is intended for illustration only.

GIRAFFE360

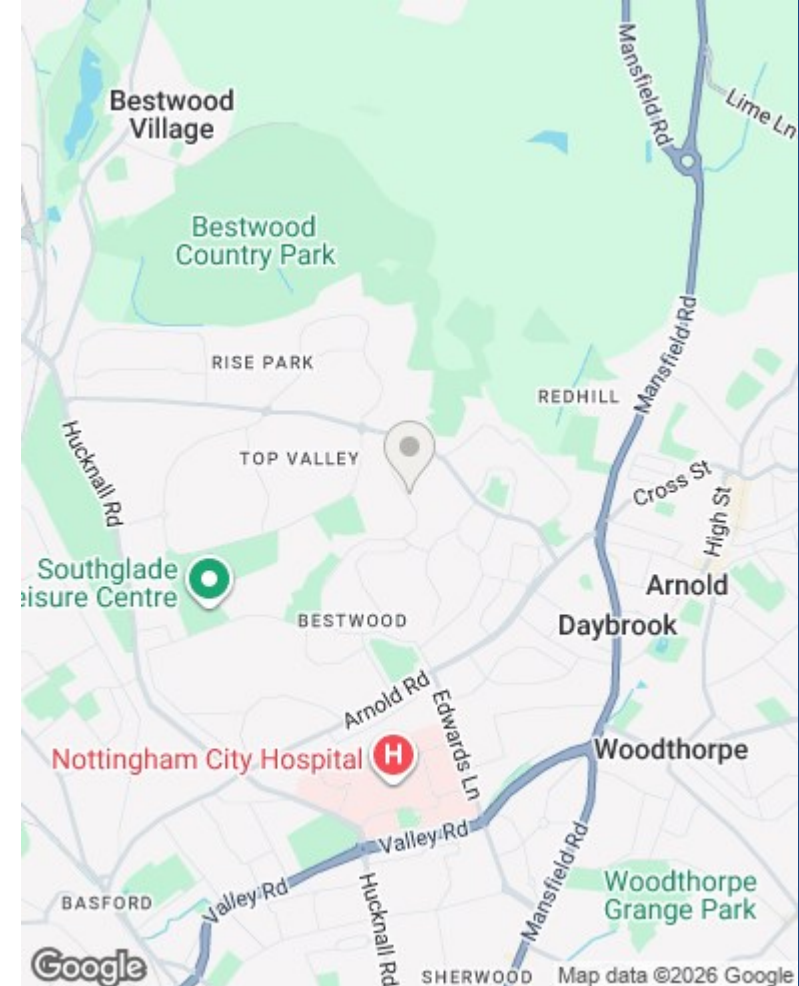

Council Tax Band: A
Nottingham City Council

These particulars are produced in good faith, are set out as a general guide only and do not constitute any part of a contract. No person in the employment of David James Estate Agents Ltd has any authority to make any representation whatsoever in relation to the property. All services, together with electrical fittings or fitted appliances have NOT been tested. All the measurements given in the details are approximate. Floor plans are for illustrative purposes only and are not drawn to scale. The position and size of doors, windows, appliances and other features are approximate only. The photographs of this property have been taken with a 10mm wide-angle lens. No responsibility can be accepted for any loss or expense incurred in viewing. If you have a property to sell you may wish to take advantage of our free valuation service. David James Estate Agents have established professional relationships with third-party suppliers for the provision of services to Clients. As remuneration for this professional relationship, the agent receives referral commission from the third-party company. David James Estate Agents receives the following commission from each third party supplier on a per referral basis: W A Barnes Ltd: £60 including VAT. All Moves UK Ltd: 18% including VAT of the invoice total (£107 including VAT average). MoveWithUs Limited: £188 including VAT (average).

DavidJames
the estate agent

David James Estate Agents
45b Plains Road, Mapperley, Nottingham, NG3 5JU
t: 0115 962 4213 e: lettings@david-james.com

naea | propertymark
PROTECTED

