

Butler's

thoughtful estate agency



Kings Road, Sutton, SM2 6DG
Guide price £600,000

3 1 1

Floor Plan

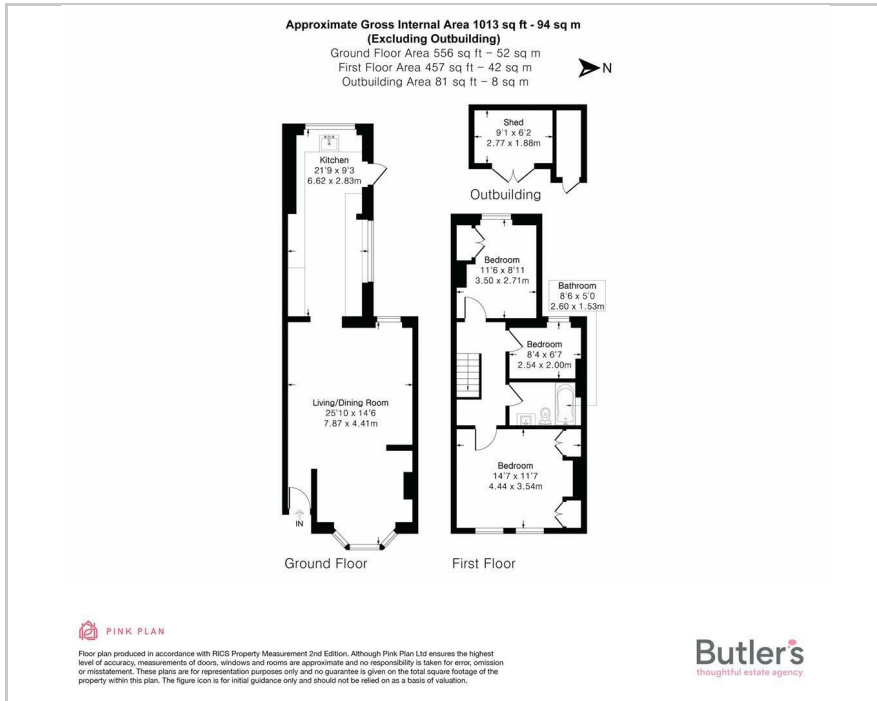

Area Map

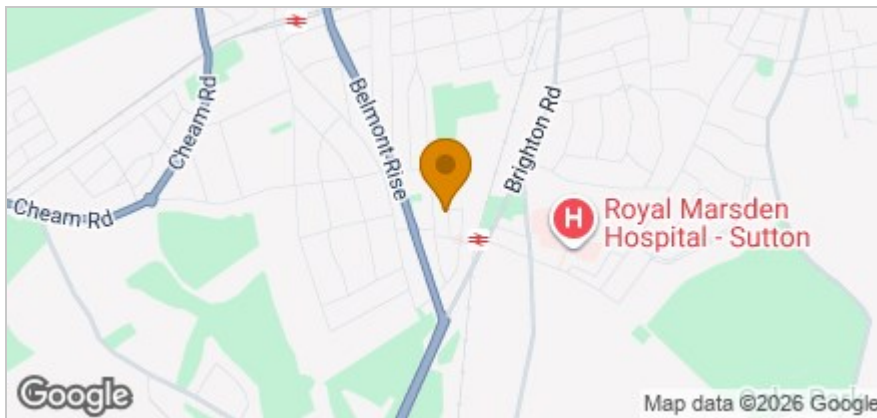

Accommodation

- Stunning 3 bedroom period home
- Fastidiously refurbished throughout
- High-end kitchen with bi-fold windows framing the garden
- Large, flowing, semi-open plan living/dining area
- Gorgeous bathroom with feature brick wall
- Landscaped rear garden with outbuilding/shed
- Highly desirable road in Belmont
- Extremely close to Belmont Station & outstanding schooling
- Future-proofed as still has the potential to extend into the loft - subject to the relevant permissions

Viewing

Please contact our Butler's Sutton Office on 020 39 170 160 if you wish to arrange a viewing appointment for this property or require further information.

Energy Efficiency Graph

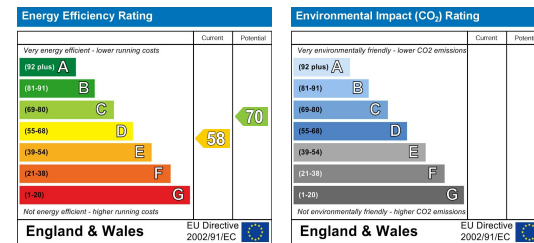

These particulars, whilst believed to be accurate are set out as a general outline only for guidance and do not constitute any part of an offer or contract. Intending purchasers should not rely on them as statements of representation of fact, but must satisfy themselves by inspection or otherwise as to their accuracy. No person in this firm's employment has the authority to make or give any representation or warranty in respect of the property.

18 Sutton Plaza, Sutton, Surrey, SM1 4FS

Tel: 020 39 170 160 Email: sutton@butlershomes.co.uk butlershomes.co.uk