



Flat 20 Waverley Place, London, N4 2BU

£2,200 Per Month

- Finsbury Park Tube
- Garden

Flat 20 Waverley Place, London N4 2BU

Two double-bedroom flat located within a well-maintained private development on Waverley Place, N4.

The property comprises a generous and bright reception room, a separate fully fitted kitchen, a modern bathroom, and two spacious double bedrooms. Further benefits include a private garden, offering valuable outdoor space for relaxing or entertaining.

Ideally positioned just a 4–5 minute walk from both Piccadilly and Victoria line stations, the property enjoys excellent transport connections into Central London and beyond, as well as easy access to a range of local shops, cafes, and amenities.



Council Tax Band: D



Waverly Place, N4

Approx. Gross Internal Area 639 Sq Ft - 59.36 Sq M

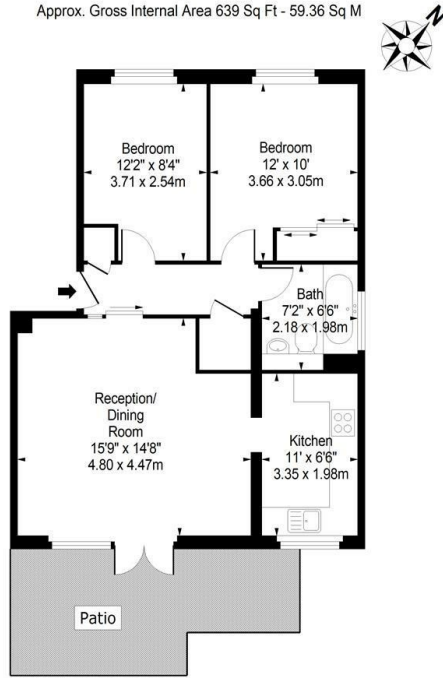

Ground Floor

Floor Area 639 Sq Ft - 59.36 Sq M

For Illustration Purposes Only - Not To Scale

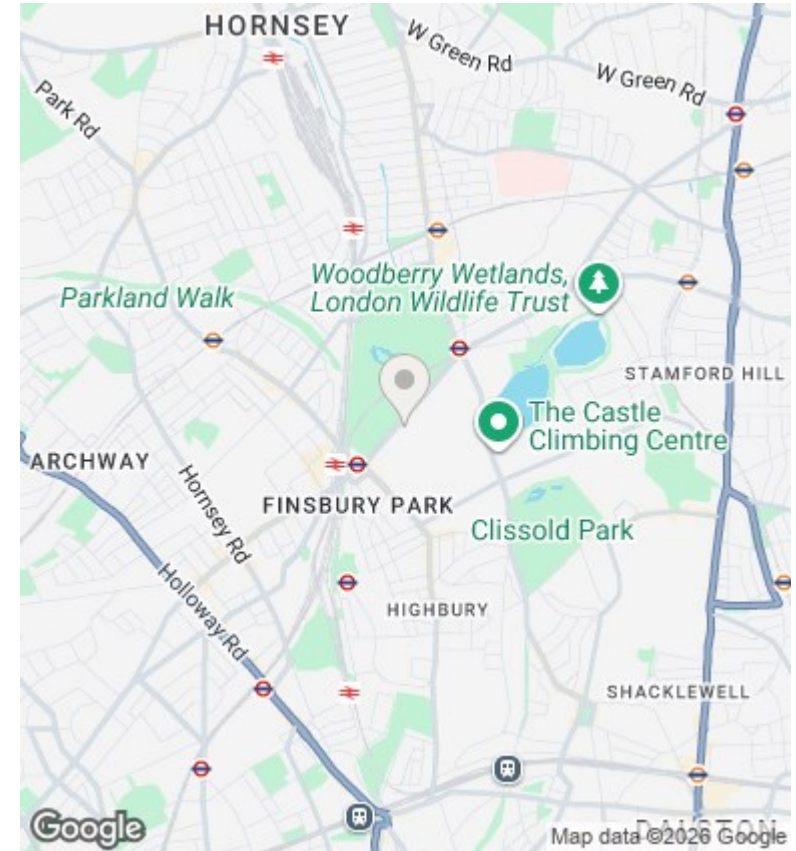

Directions

Viewings

Viewings by arrangement only. Call 02073593191 to make an appointment.

Council Tax Band

D

Energy Efficiency Rating		Current	Potential
Very energy efficient - lower running costs			
(92 plus) A			
(81-91) B			
(69-80) C			
(55-68) D		68	74
(39-54) E			
(21-38) F			
(1-20) G			
Not energy efficient - higher running costs			
England & Wales		EU Directive 2002/91/EC	

Full description

Two double-bedroom flat located within a well-maintained private development on Waverley Place, N4.

The property comprises a generous and bright reception room, a separate fully fitted kitchen, a modern bathroom, and two spacious double bedrooms. Further benefits include a private garden, offering valuable outdoor space for relaxing or entertaining.

Ideally positioned just a 4–5 minute walk from both Piccadilly and Victoria line stations, the property enjoys excellent transport connections into Central London and beyond, as well as easy access to a range of local shops, cafes, and amenities.





