

10 The Limes,  
London Road  
Halesworth  
IP19 8LT



# 10 The Limes, London Road

## Guide Price £150,000

### The spacious one bedroom house...

Situated within the well-regarded The Limes development, exclusively for those aged 60 and over, this delightful one-bedroom home offers comfort, independence and convenience in equal measure.

Positioned amongst mature trees and beautifully maintained communal gardens, No. 10 enjoys a peaceful outlook over a central green area while being only a short stroll—around five to ten minutes—from Halesworth's vibrant town centre, with its shops, cafés, Co-op supermarket and rail links. The Suffolk coast, including Southwold and Walberswick, lies just a short drive away.

The property itself is part of the original section of the development, thoughtfully arranged to provide both privacy and a sense of community. The accommodation includes a bright dual-aspect sitting room, a conservatory overlooking the private rear garden, and a well-equipped kitchen-diner featuring a skylight and pleasant garden views.

Upstairs, the generous double bedroom benefits from windows to both front and rear, creating a light and airy feel, with an adjoining shower room and excellent storage. Additional features include gas central heating, a ground-floor cloakroom, and ample cupboard space.

Outside, this property is one of only two in the development to enjoy its own enclosed private garden – beautifully stocked and easy to maintain, with paved seating areas and raised beds. Residents also have access to a communal garden room, greenhouse and orchard, offering the best of both privacy and shared green space.

There is an allocated parking space along with ample visitor parking close by.

This well-maintained home offers an ideal opportunity for those seeking an active yet peaceful retirement setting, within walking distance of everything the historic market town of Halesworth has to offer, and easy access to the glorious Suffolk coastline.

### Agents notes...

A pre-recorded walkaround tour is available for this property

Every owner at The Limes owns a 1/30th share of the freehold through the Residents' Association

No pets allowed to be kept at The Limes

Local Authority

East Suffolk

Council Tax Band B

EPC Rating D



Contact  
 01502 820 028  
 enquiries@attikccc.co.uk  
 www.attikccc.co.uk

GROUND FLOOR  
 567 sq.ft. (52.7 sq.m.) approx.

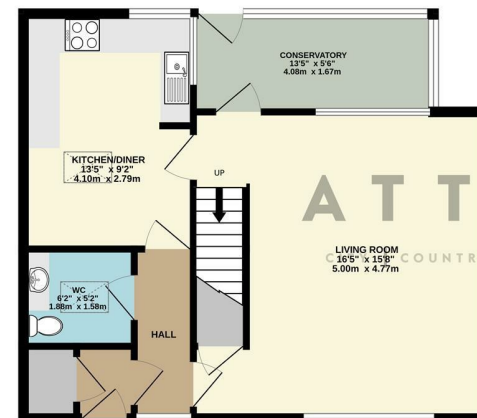

1ST FLOOR  
 281 sq.ft. (26.1 sq.m.) approx.



TOTAL FLOOR AREA: 848 sq.ft. (78.8 sq.m.) approx.

Whilst every attempt has been made to ensure the accuracy of the floorplan contained here, measurements of doors, windows, rooms and any other items are approximate and no responsibility is taken for any error, omission or mis-statement. This plan is for illustrative purposes only and should be used as such by any prospective purchaser. The services, systems and appliances shown have not been tested and no guarantee as to their operability or efficiency can be given.  
 Made with Metropix C2025.