



Snowdrop Drive, Attleborough, NR17 2PP

welcome to

Snowdrop Drive, Attleborough

A well-presented two-bedroom detached bungalow featuring a drive, garage and spacious single-living layout, ideal for those seeking comfortable, low-maintenance living in a sought after location.



Description

William H Brown are delighted to present this charming two-bedroom detached bungalow, offering comfortable, single-level living in a desirable location.

The property features a drive leading to a garage, providing convenient off-road parking and additional storage. Inside, the home comprises two well-sized bedrooms and a modern three-piece bath, kitchen, offering ample workspace and room for family meals. From the dining area, French-style doors open the rear garden. there is also a conservatory off the kitchen accessed via a double-glazed door, creating a wonderful second reception space with views into the rear garden. This versatile room makes an ideal spot for relaxing, entertaining, or enjoying the garden year-round.

The rear garden is enclosed creating a peaceful and private outdoor space.

Lounge

21' 10" x 13' 9" (6.65m x 4.19m)

Fitted carpet with double glazed windows to the front, complete with french doors leading to the rear garden

Kitchen

10' x 9' 3" (3.05m x 2.82m)

Selection of fitted storage units, stainless steel sink complete with mixer tap

Conservatory

8' 2" x 7' 7" (2.49m x 2.31m)

Doors leading to the rear garden

Bedroom One

12' 5" x 10' 1" (3.78m x 3.07m)

Double bedroom complete with fitted carpet

Bedroom Two

10' 9" x 8' 9" (3.28m x 2.67m)

Double bedroom with fitted carpet and wardrobe

Bathroom

Three piece suite with shower over bath

Rear Garden

Patio area and low maintained lawn area

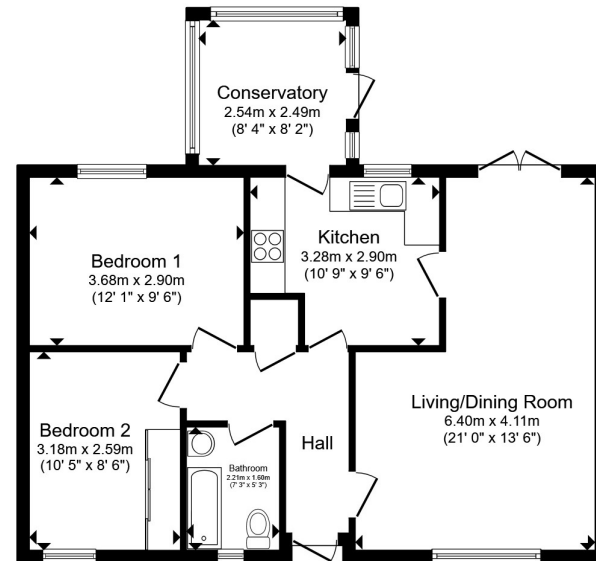

Total floor area 68.5 m² (738 sq.ft.) approx

This floor plan is for illustrative purposes only. It is not drawn to scale. Any measurements, floor areas (including any total floor area), openings and orientation are approximate. No details are guaranteed, they cannot be relied upon for any purpose and they do not form part of any agreement. No liability is taken for any error, omission or misstatement. A party must rely upon its own inspection(s). Powered by www.propertybox.io



view this property online williamhbrown.co.uk/Property/ATB109786



welcome to

Snowdrop Drive, Attleborough

- CHAIN FREE
- *GUIDE PRICE £270,000 - £280,000*
- Two Double Bedrooms
- Kitchen
- Garage
- Detached
- Conservatory

Tenure: Freehold EPC Rating: Awaited Council Tax Band: C

guide price

£270,000



Please note the marker reflects the
postcode not the actual property

view this property online williamhbrown.co.uk/Property/ATB109786



Property Ref:
ATB109786 - 0005

1. MONEY LAUNDERING REGULATIONS Intending purchasers will be asked to produce identification documentation at a later stage and we would ask for your co-operation in order that there is no delay in agreeing the sale. 2. These particulars do not constitute part or all of an offer or contract. 3. The measurements indicated are supplied for guidance only and as such must be considered incorrect. Potential buyers are advised to recheck measurements before committing to any expense. 4. We have not tested any apparatus, equipment, fixtures or services and it is in the buyers interest to check the working condition of any appliances. 5. Where an EPC, or a Home Report (Scotland only) is held for this property, it is available for inspection at the branch by appointment. If you require a printed version of a Home Report, you will need to pay a reasonable production charge reflecting printing and other costs. 6. We are not able to offer an opinion either written or verbal on the content of these reports and this must be obtained from your legal representative. 7. Whilst we take care in preparing these reports, a buyer should ensure that his/her legal representative confirms as soon as possible all matters relating to title including the extent and boundaries of the property and other important matters before exchange of contracts.

William H Brown is a trading name of Sequence (UK) Limited which is registered in England and Wales under company number 4268443, Registered Office is Cumbria House, 16-20 Hockliffe Street, Leighton Buzzard, Bedfordshire, LU7 1GN. VAT Registration Number is 500 2481 05.



william h brown



01953 452990



Attleborough@williamhbrown.co.uk



Exchange Street, ATTLEBOROUGH, Norfolk,
NR17 2AB



williamhbrown.co.uk