

Estates

Browne

B
E

SALES & LETTINGS



5 Shawfield Park

Bickley, Bromley, BR1 2NQ

An impressive 5 bedroom detached home in a sought after road



5 Shawfield Park

Guide Price £1,150,000 - £1,200,000

This beautifully presented five-bedroom, three-bathroom detached home offers over 2,000 sq ft of versatile and well-proportioned living space, ideal for growing families or those seeking a spacious residence in a quiet yet convenient location.

The entrance hall leads to two spacious reception rooms—one ideal for formal entertaining and the other a relaxed family space that opens directly onto the garden. The heart of the home is the expansive kitchen/diner, fully equipped with granite worktops, a Rangemaster induction hob and oven, and space for large dining gatherings. A separate utility room and WC complete the ground floor layout.

The master bedroom on the first floor is a luxurious retreat with an ensuite shower room and a walk-in wardrobe. Two additional double bedrooms and a stylish family bathroom are also found on this level. On the upper floor, a further two double bedrooms and a third family bathroom provide ample space for teenagers, guests, or a home office setup.

To the rear is a beautifully maintained 85'4 ft west-facing garden, perfect for relaxing or entertaining with a large patio area ideal for outdoor dining and summer gatherings. The front offers private off-street parking for several cars.

Situated within easy reach of local shops at 'Widmore Green' and just a mile from Bromley's vibrant town centre and The Glades Shopping Centre. Bickley Station offering fast access to central London and well-connected bus routes are both close by. The property lies within the catchment area for numerous outstanding schools including Bickley Primary, Bullers Wood, La Fontaine, and Bromley High.

- 5 double bedrooms
- Master with ensuite and walk in wardrobe
- 2 further bathrooms plus downstairs WC
- Spacious 23'4 kitchen diner with doors to garden
- Separate utility room

- 17'9 reception to rear opens to garden
- 21'4 double aspect reception at front.
- Beautiful 85'4 Westerly facing garden
- Close to local shops and good access to transport links
- Close to excellent schools







Shawfield Park, BR1

Approximate Gross Internal Area = 2003 sq ft / 186.1 sq m

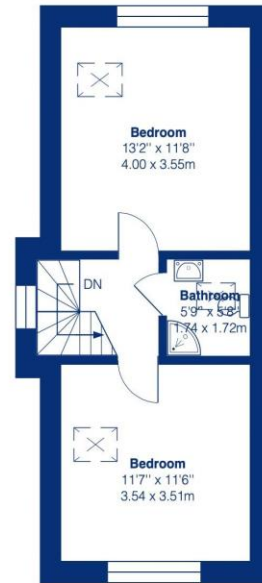

Second Floor

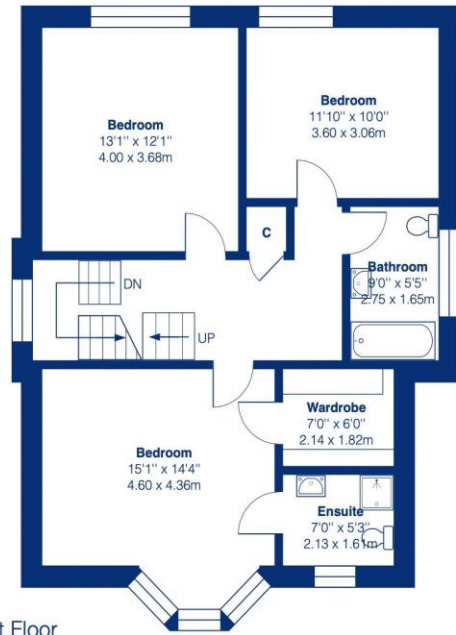

This plan is for layout guidance only and not drawn to scale unless stated. Window and door openings are approximate. Whilst every care is taken in the preparation of this plan, we would advise interested parties to check all dimensions, shapes and compass bearings prior to making any decisions reliant upon them.
By Homeoutlook.co.uk / Copyright 2025

Disclaimer

We have not tested any services, systems or appliances at this property. We strongly recommend that all the information which we provide is verified by yourselves on inspection, and by your Surveyor and Conveyancer.

B2139 Ravensworth 01670 713330



Additional Information

Council Tax Band: G

EPC Rating: D

Location: Bickley

Viewing: Via Browne Estates

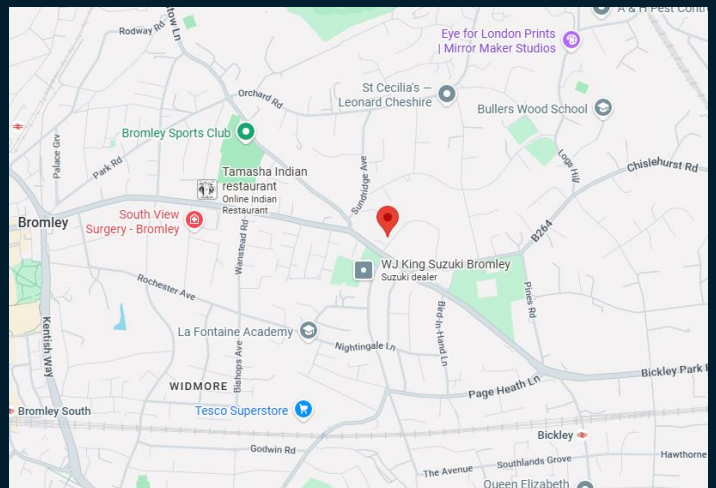
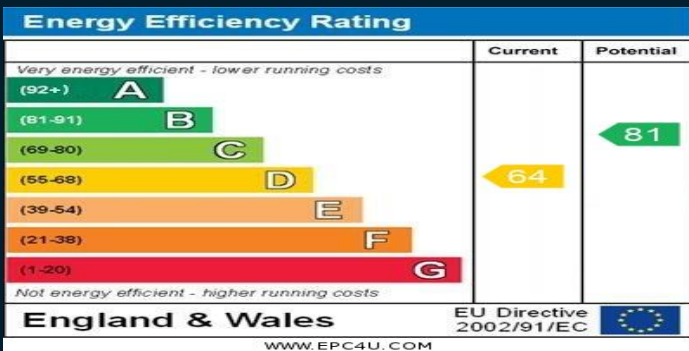

197 Widmore Road, Bromley, Kent BR1 2RG

Email: sales@browne-estates.co.uk

Tel: 020 8466 9101

www.browne-estates.co.uk