



## Spencer Way, E1

£2,500 Per calendar month

A fantastic tenth floor apartment located in Kelday Heights. The property has a large living and kitchen area with balcony, a great view of Canary Wharf, two large double bedrooms and a modern family bathroom.

Kelday Heights has Shadwell Station on its doorstep and is just over three quarters of a mile to the vibrant Brick Lane, where you have an array of café, bars and restaurants.

### Features

- Two Double Bedrooms
- Wood Flooring
- Balcony
- Great Transport Links
- Open Plan
- Shadwell

# Spencer Way, London, E1

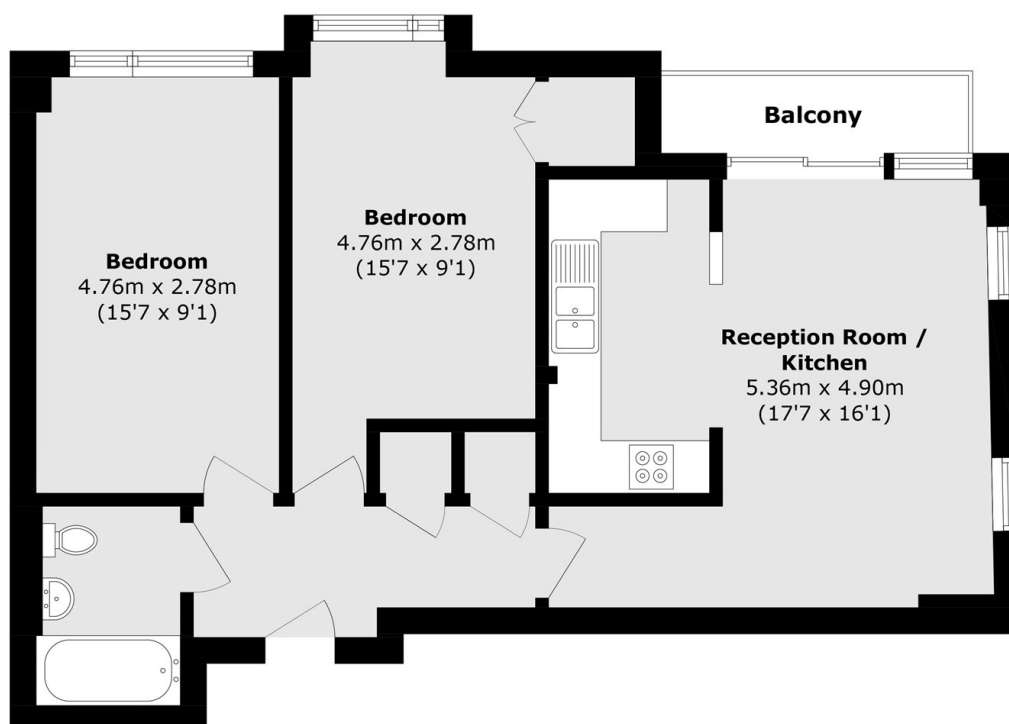

Total area (approx.): 64.7 sq. m (696.4 sq. ft)

Balcony area (approx.): 3.3 sq. m (35.5 sq. ft)