

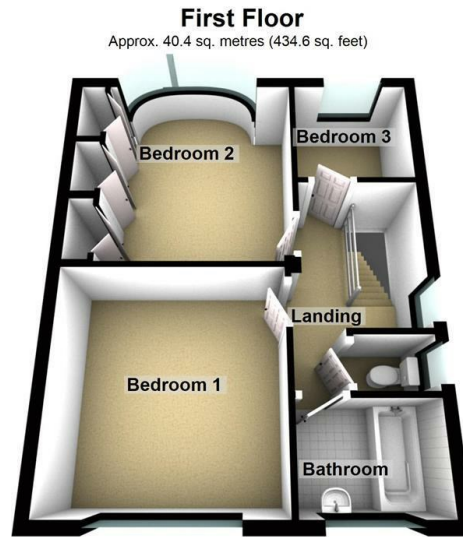

14 Elwood Road, Bradway, Sheffield, South Yorkshire,

£1,300 PCM

- Semi Detached
- GCH/ uPVC DG
- Three Bedrooms
- Good Sized Gardens
- Ideal Location
- Garage

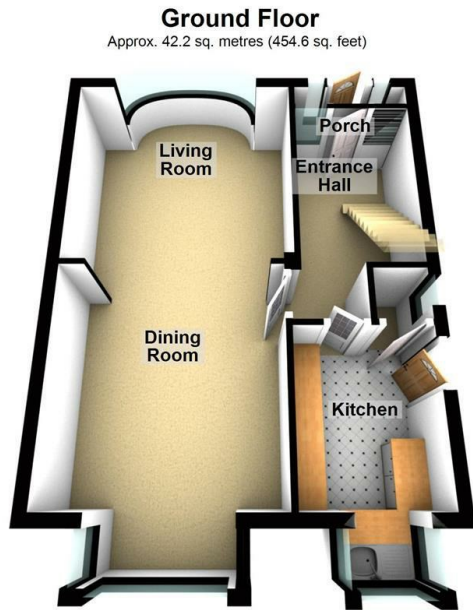

Total area: approx. 82.6 sq. metres (889.2 sq. feet)
Whilst every care has been taken to prepare these floor plans, they are for guidance purposes only.
Plan produced using PlanUp.

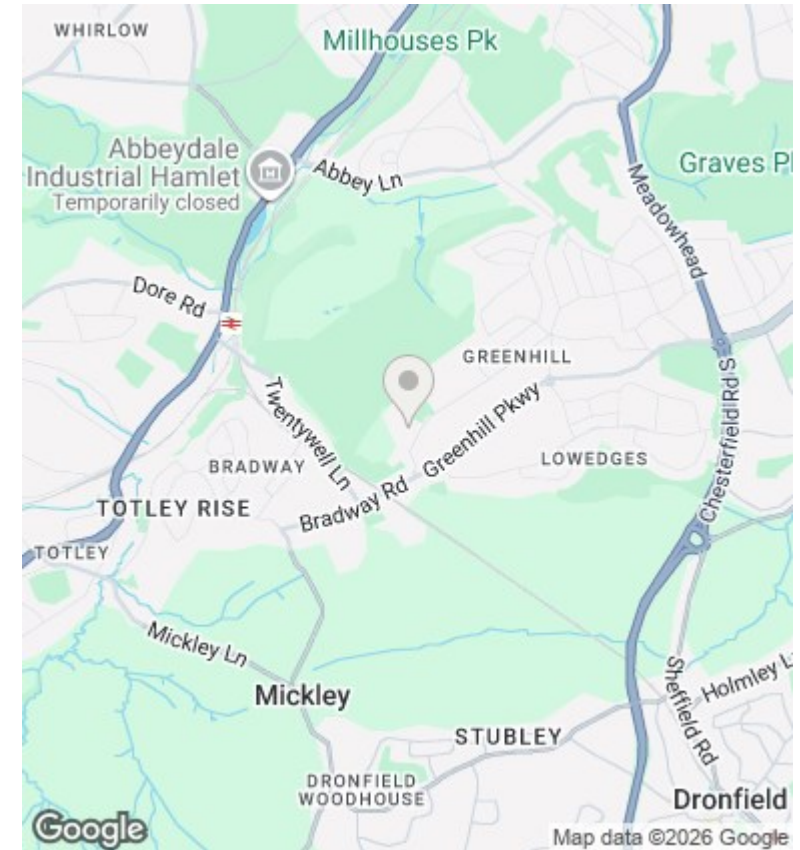

Directions

Viewings

Viewings by arrangement only. Call 0114 283 4050 to make an appointment.

Council Tax Band

B

EPC Rating:

C

Energy Efficiency Rating		Current	Potential
<i>Very energy efficient - lower running costs</i>			
(92 plus) A			
(81-91) B			85
(69-80) C		69	
(55-68) D			
(39-54) E			
(21-38) F			
(1-20) G			
<i>Not energy efficient - higher running costs</i>			
England & Wales		EU Directive 2002/91/EC	