



St. Rule Street, SW8

£675,000

Dexters



St. Rule Street, SW8

This terraced home expands over 970 sqft across two floors with three bedrooms. There is a large reception room area with adjoining modern kitchen. Under the stairs you find plenty of storage space and a downstairs W/C. On the first floor, there are three bedrooms, two of which are doubles and a family bathroom. The house further benefits from attic storage and garden storage. The house is presented in good order throughout and is ready to move in.

St. Rule Street is in Wandsworth Borough and is ideally located for Wandsworth Road (5mins) and Queenstown Road (10 mins) stations, as well as a number of popular bus routes. Heathbrook Park is close by, with Battersea Park and the Power station within walking distance. The cafes, bars and restaurants of Wandsworth Old Town are easily reachable and there is a number of large supermarkets to choose from within the Clapham Old Town area.

Features

- Freehold House
- Private Garden
- Two Double Bedrooms
- Attic Storage
- Purpose Built
- Porch







St. Rule Street, London, SW8

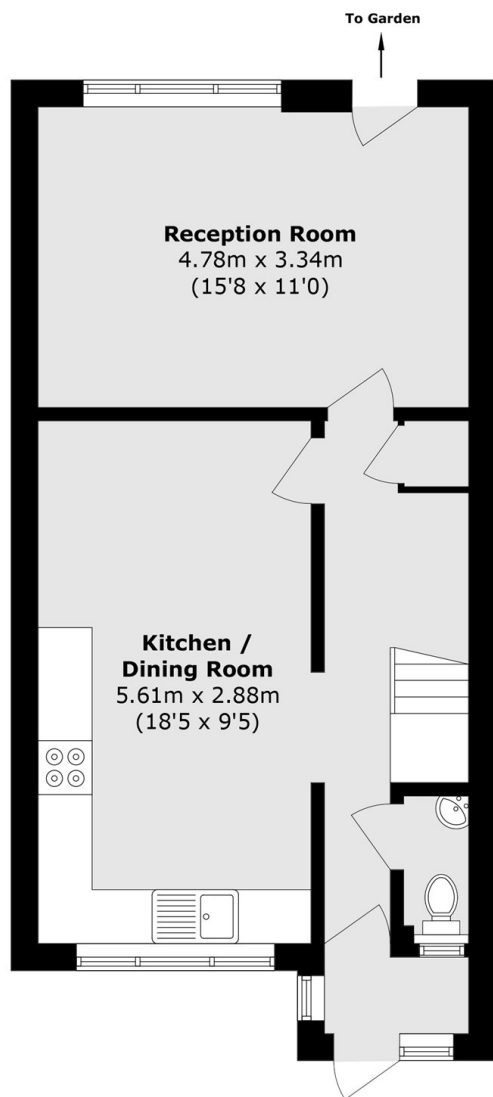

Ground Floor

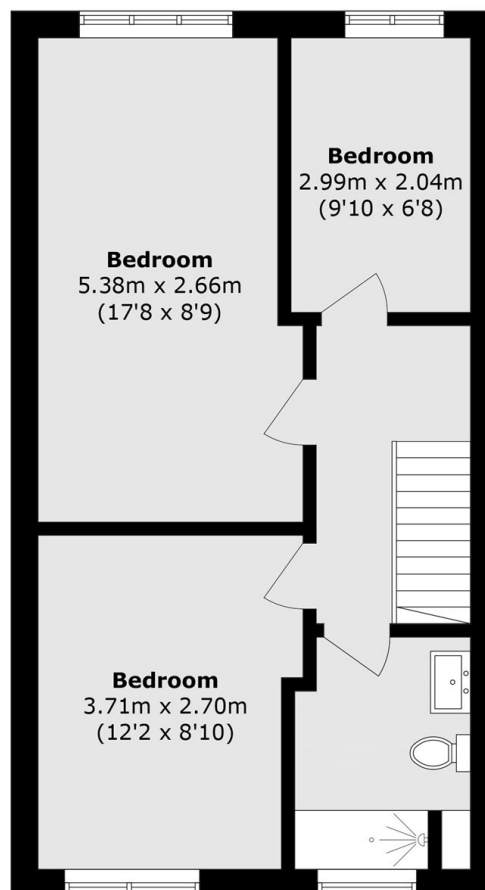

First Floor

Total area (approx.): 90.4 sq. m (973.0 sq. ft)